

ACCESSORI ORIGINALI

per smontagomme

ARTIGLIO 50

Cod.4-104091C del 07/08

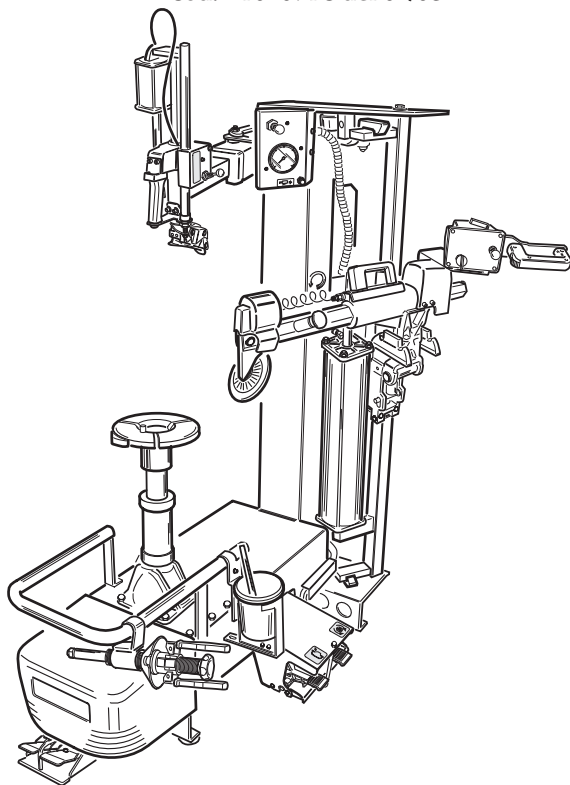

ORIGINAL ACCESSORIES

for tyre changers

ARTIGLIO 50



Legenda



Accessori di serie
Standard accessories



Accessori a richiesta
Accessories optional

801XXX
8-XXX

Accessori
Accessories

900XXX

Ricambi
Spare parts

Q.tà: nr 1
Q.ty: 1

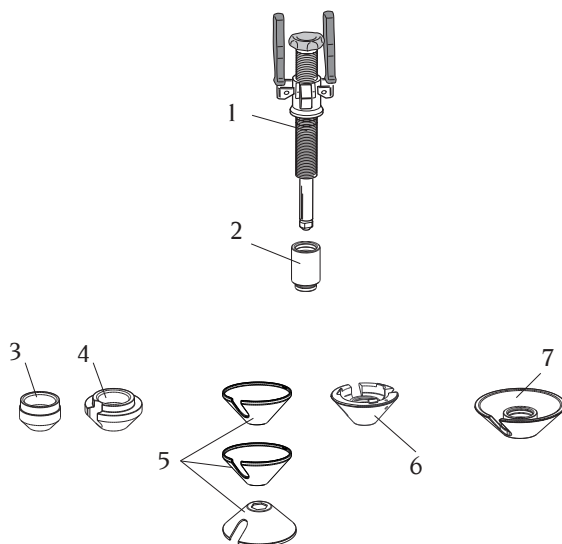

- | | |
|---|--|
| 1 | Maniglia completa 9005-101197
<i>Universal locking pistol</i> |
| 2 | Prolunga per maniglia (M9) 9005-101204
<i>Extention for locking pistol (M9)</i> |
| 3 | Cono Ø58 (M13)..... 9004-103235
<i>Cone Ø58 (M13)</i> |
| 4 | Cono Ø75 (M14)..... 9004-103234
<i>Cone Ø75 (M14)</i> |
| 5 | 3 Cuffie protezione cono Ø120 (M7) 9004-103232
<i>3 Protection cap for cone Ø120 (M7)</i> |
| 6 | 1 Cono Ø120 (M11)..... 9004-103230
<i>1 Cone Ø120 (M11)</i> |
| 7 | Cono Ø145 (M2)..... 9004-103229
<i>Cone Ø145 (M2)</i> |

Q.tà: nr 1

Q.ty: 1

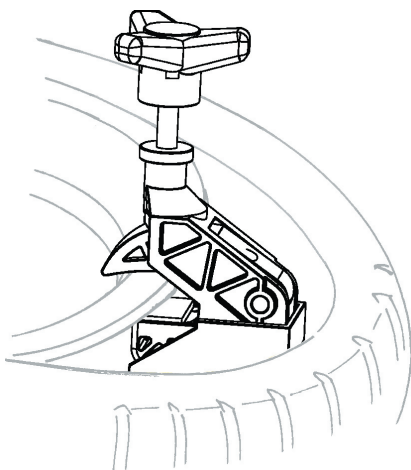

34 801262417

Pinza premitallone per pneumatici Run Flat
Bead pressing clamp for Run Flat tyres

Q.tà: nr 1

Q.ty: 1

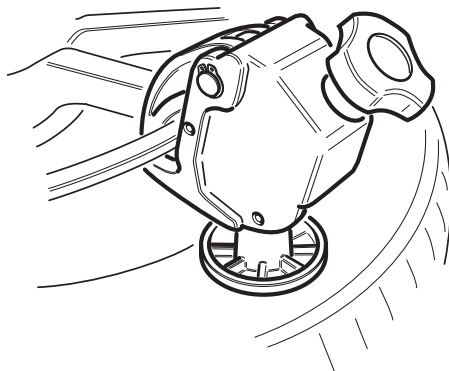

35 8-11100120

Morsetto basculante
Sliding bead pressing clamp

Q.tà: nr 1

Q.ty: 1

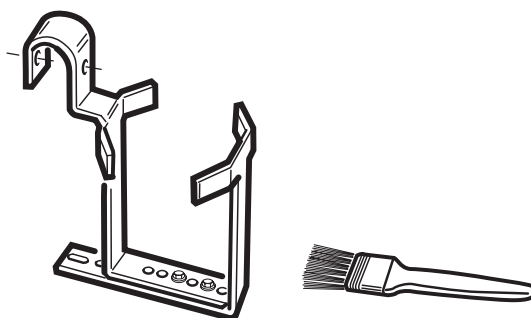

28 9005-101236 Portagrasso universale
Universal grease bucket holder

Q.tà: nr 1

Q.ty: 1

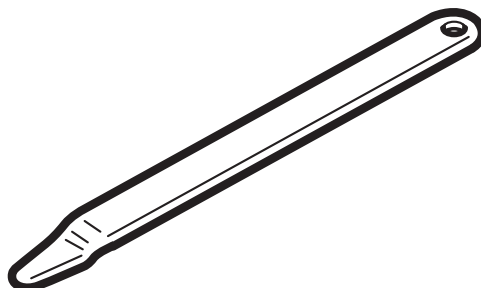

32 9004-105142 Help manuale
Manual Help

Q.tà: nr 1

Q.ty: 1



11 8-11100086 Kit cerchi furgone
Pick-up rim kit

- 12 Cono Ø187 (M15).....9004-103233
Cone Ø187 (M15)
- 13 Anello distanziale (M10)9005-100690
Spacer ring (M10)

Q.tà: nr 1

Q.ty: 1

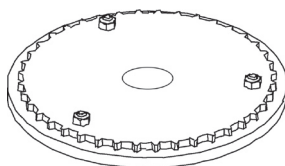

16 8-11100009 Kit "Wire Wheel" (da usare con il cod.9005-101197)
"Wire Wheel" kit (to be used with code 9005-101197)

Q.tà: nr 1

Q.ty: 1

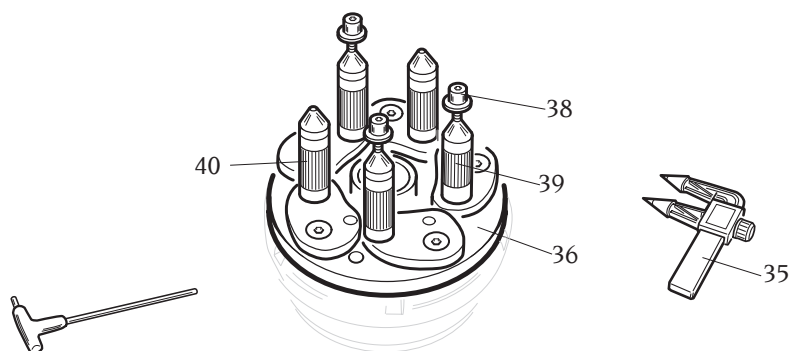

33	8-11100039	Flangia per ruote a canale rovescie <i>Reverse wheel flange</i>	
38		Ghiera di serraggio <i>Ring nut</i>	9004-102377
39		Colonna con serraggio con biella..... <i>Column with locking device</i>	5-102721
40		Colonnelle con biella..... <i>Columns with locking device</i>	5-102720
36		Flangia universale..... <i>Universal flange</i>	5-102422
35		Rilevatore fori..... <i>Hole detector</i>	900441286

Q.tà: nr 1

Q.ty: 1

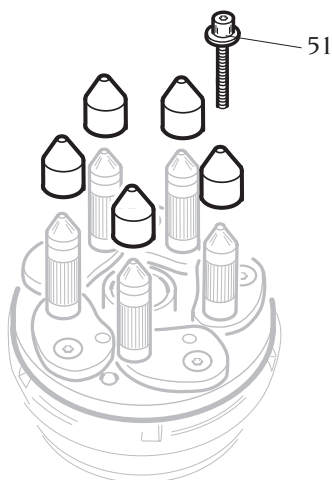

14 8-11100046 **Kit estensioni per flangia per ruote a canale rovescie e cieche
(da utilizzare esclusivamente con i seguenti codici 8-11100039,
8-11100087 e 8-11100110)**

*Extension kit for reverse and closed wheel (to be used with the accessories
code 8-11100039, 8-11100087 and code 8-11100110)*

51 Ghiera di serraggio lunga 9004-102566
Long ring nut

Q.tà: nr 1
Q.ty: 1

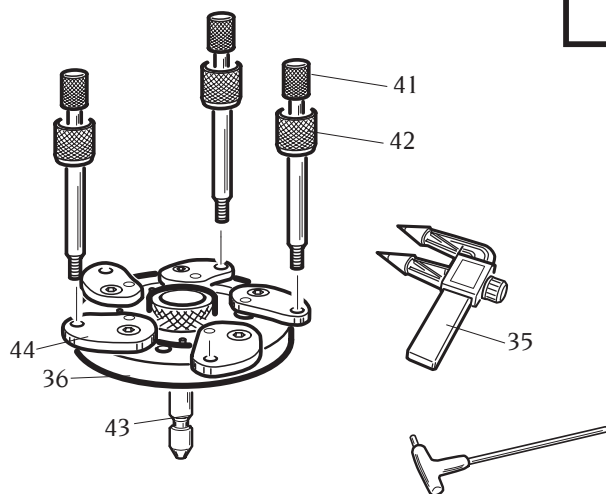

21	8-11100087	Flangia universale cerchi ciechi Universal flange for close centre rims
38		Ghiera di serraggio 9004-102377 Ring nut
41		Vite fissaggio cerchi 900361647 Rim fixing screw
42		Ghiera fissaggio cerchi 900361648 Rim fixing ring nut
43		Barra attacco platorello 9004-103765 Exagonal bar
44		Biella 4-107023 Connecting rod
36		Flangia universale 5-102422 Universal flange
35		Rilevatore fori 900441286 Hole detector

Q.tà: nr 1

Q.ty: 1

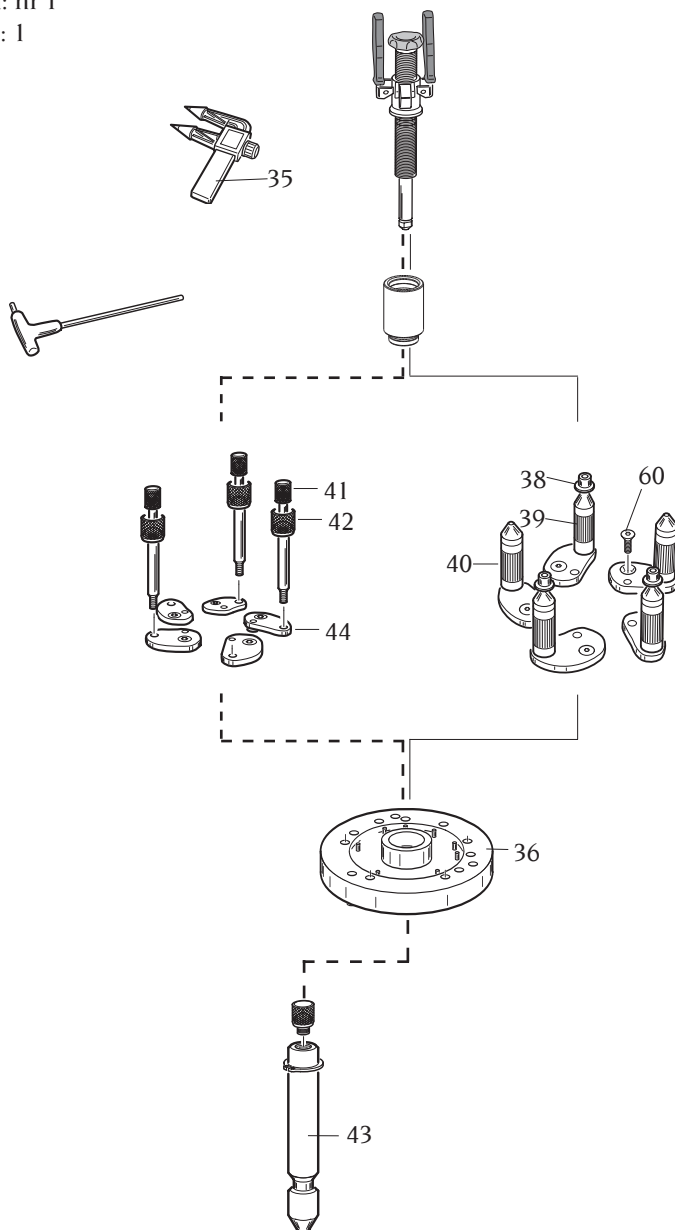

Cerchi ciechi / Close centre rim

Cerchi rovesci / Reverse rim

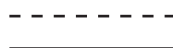

49	8-11100110	Kit ruote NON STANDARD Not STANDARD rim kit	
38		Ghiera di serraggio <i>Ring nut</i>	9004-102377
39		Colonneta con serraggio con biella..... <i>Column with locking device</i>	5-102721
40		Colonnette con biella..... <i>Columns with locking device</i>	5-102720
36		Flangia universale..... <i>Universal flange</i>	5-102422
41		Vite fissaggio cerchi ciechi..... <i>Rim fixing screw</i>	900361647
42		Ghiera fissaggio cerchi ciechi..... <i>Rim fixing ring nut</i>	900361648
43		Barra attacco platorello..... <i>Exagonal bar</i>	9004-103765
44		Biella <i>Connecting rod</i>	4-107023
35		Rilevatore fori..... <i>Hole detector</i>	900441286
60		Vite fissaggio bielle <i>-</i>	9004-101250

Q.tà: nr 1

Q.ty: 1

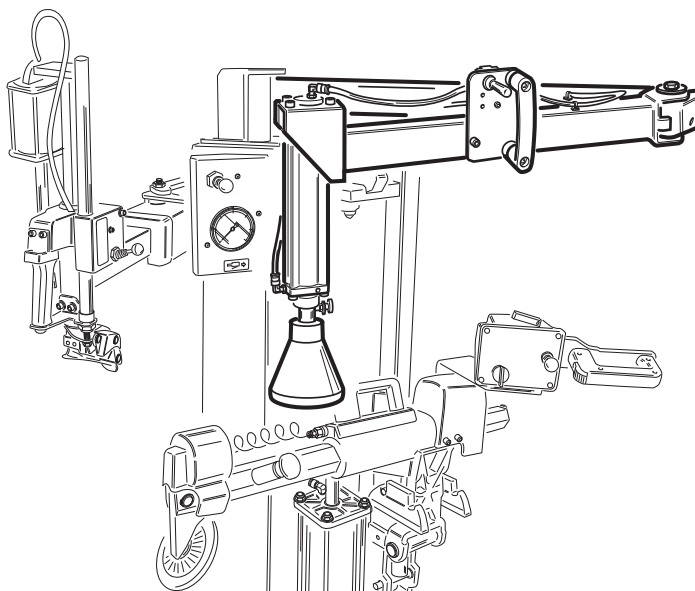

48 8-11100097 Premitallone pneumatico
Pneumatic bead pressing tool

8-11100112 Premitallone pneumatico (solo per mercato USA)
Pneumatic bead pressing tool (for USA market only)

Q.tà: nr 1

Q.ty: 1

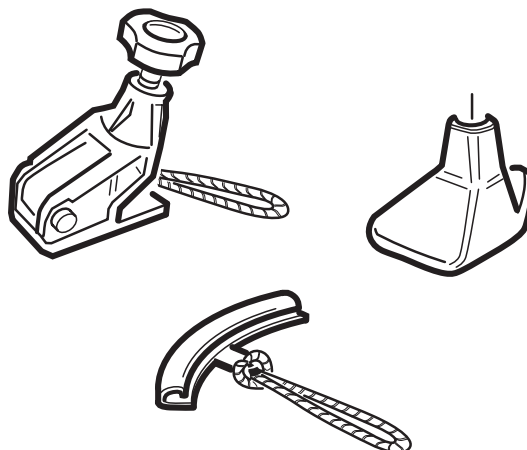

8-11100190 Kit Run Flat
Kit Run Flat

Q.tà: nr 1
Q.ty: 1

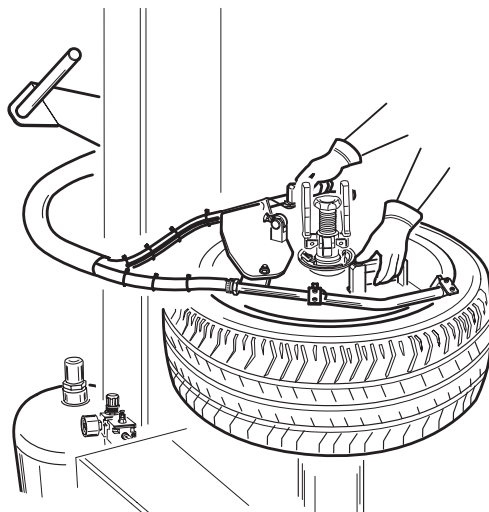

23 8-11100111 **Kit intallonamento rapido: T.I system**
T.I system kit

Q.tà: nr 1

Q.ty: 1

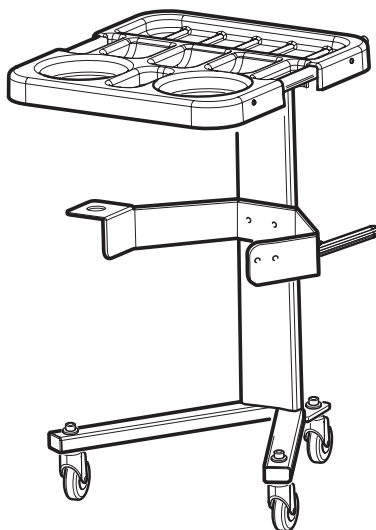

0-51100101/16

EasyTrolley carrello porta accessori
Accessory-holder EasyTrolley

Q.tà: nr 1

Q.ty: 1

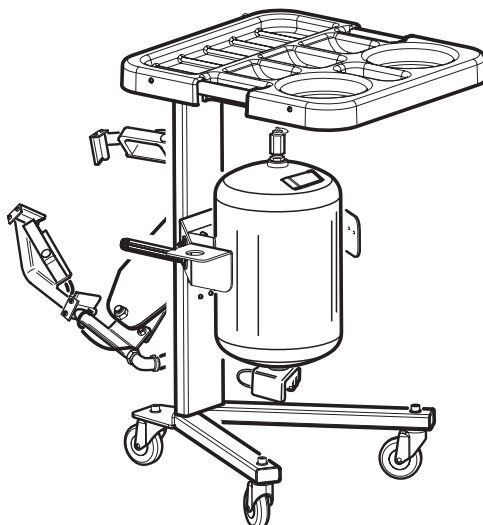

0-51100102/16

EasyTrolley carrello porta accessori + T.I. system CE
Accessory-holder EasyTrolley + T.I. system CE

0-51100103/16

EasyTrolley carrello porta accessori + T.I. system ASME (solo per mercato USA)
Accessory-holder EasyTrolley + T.I. system ASME (for USA market only)

Q.tà: nr 1
Q.ty: 1

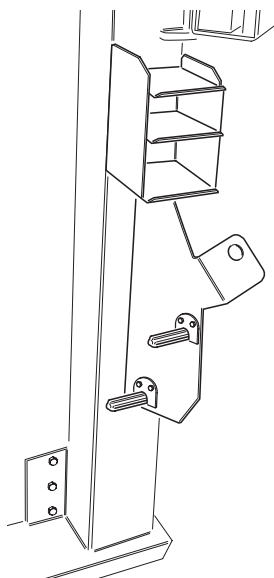

- 31 8-11100089 **Porta accessori posteriore**
Rear accessory holder

Q.tà: nr 1

Q.ty: 1

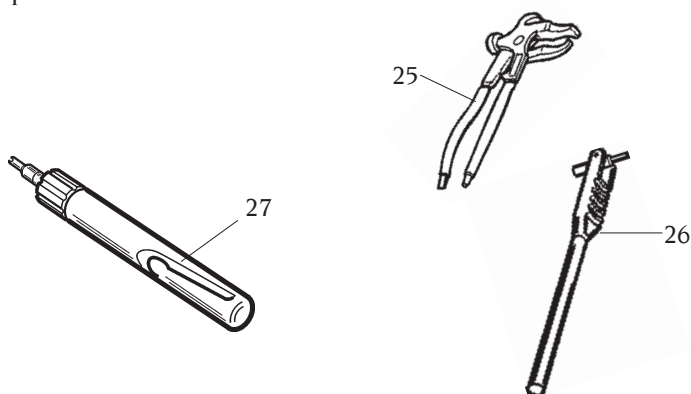

25

Pinza per applicare o togliere contrappesi

dai cerchi..... 900203841

Pliers for weight fixing and removing

26

Leva per posizionare la valvola 801461004

Valve-inserting lever

27

Attrezzo per svitare l'inserto valvola..... 801461005

Valve core screwdriver

Q.tà: nr 1

Q.ty: 1

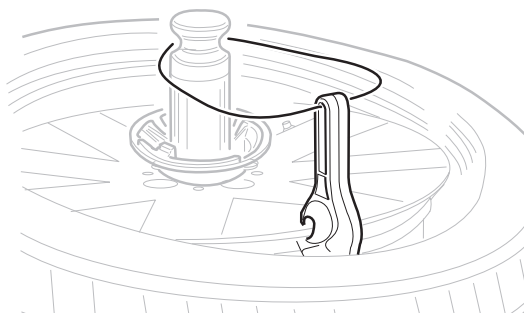

30 801261910

Leva premitallone con cordino

Plastic bead pressing lever whit cord

Q.tà: nr 1
Q.ty: 1

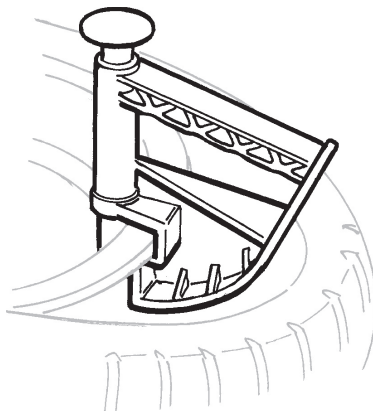

29 801435685 Pinza in plastica
Plastic bead pressing clamp

Q.tà: nr 1
Q.ty: 1

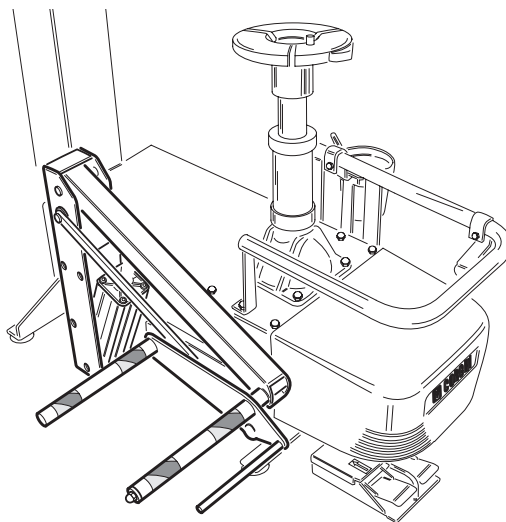

18 8-11100085 Kit sollevatore ruota
Wheel lifter kit

Q.tà: nr 1 staffa
Q.ty: 1 clamp

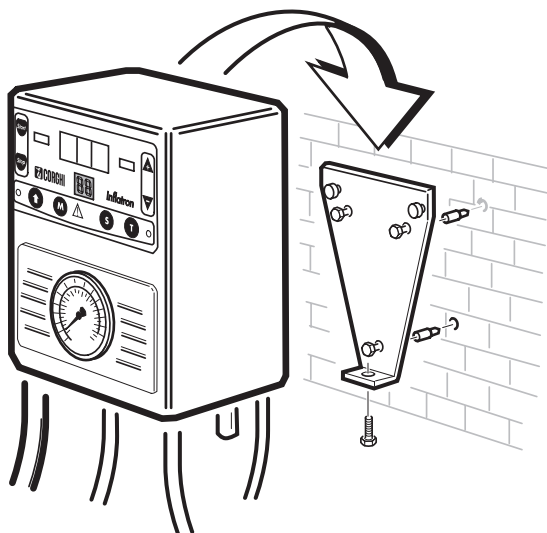

8-11400048

INFLATRON con installazione a muro
Wall mounting INFLATRON

Note

[illegible]



CORGHI

CORGHI S.p.A. - Strada Statale 468 n.9
42015 CORREGGIO - R.E. - ITALY
Tel. ++39 0522 639.111 - Fax ++39 0522 639.150
www.corgi.com - info@corgi.com