

ACCESSORI ORIGINALI per smontagomme

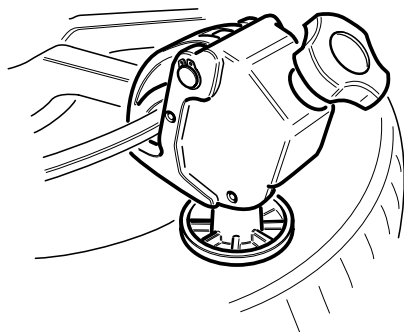

Cod.461312B
del
02.2013

Code 461312B
of
02.2013

ORIGINAL ACCESSORIES for tyre changers

SOMMARIO

Smontagomme leggeri.....	3
INFLATRON	4
SP2000	5
SX1000.....	8
PU1500.....	10
KIT PREMITALLONE PER SP2000	12
ADATTATORI.....	14
ATTREZZI SPECIALI	15
PROTEZIONI	21
 Smontagomme pesanti	 29

CONTENTS

Car tyre changers.....	3
INFLATRON APPLICATIONS	4
SP2000 APPLICATIONS.....	5
SX1000 APPLICATIONS.....	8
PU1500 APPLICATIONS	10
SP2000 BEAD PRESSING TOOL	12
CLAMPING ADAPTERS.....	14
SPECIAL TOOLS.....	15
PROTECTION.....	21
 Heavy-duty tyre changers.....	 29

Smontagomme leggeri

Car tyre changers

Q.tà: nr 1

Q.ty: 1

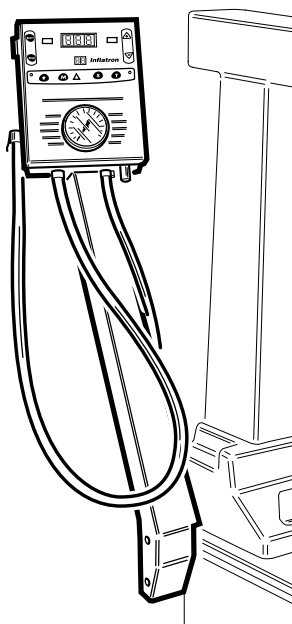

8-11400047 INFLATRON per smontagomme
Tyre changer mounting INFLATRON

Q.tà: nr 1 staffa

Q.ty: 1 clamp

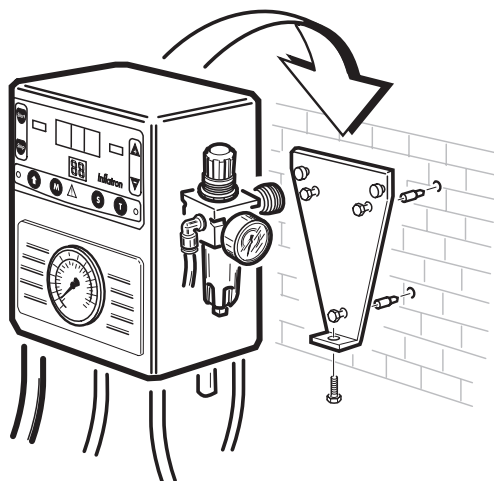

8-11400048 INFLATRON con installazione a muro
Wall mounting INFLATRON

Q.tà: nr 1

Q.ty: 1

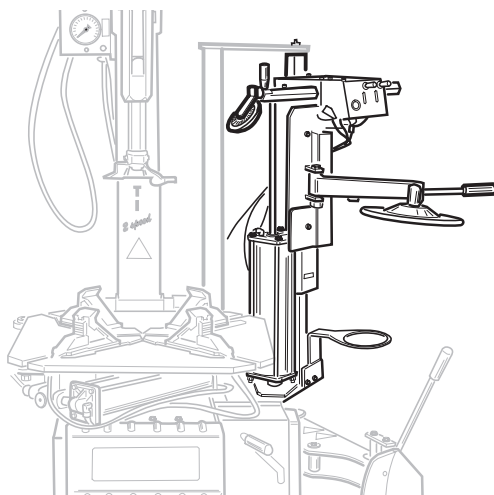

801255567 **SP2000 con sollevatore a disco**
SP2000 with disc lifter
(VAS6302/1)

Q.tà: nr 1

Q.ty: 1

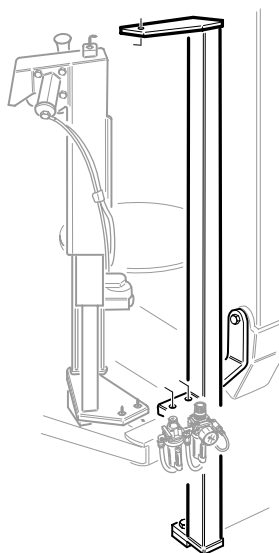

8-11100026 **Kit adattatore per SP2000**
Adapter kit for SP2000
(VAS6302/1)

Q.tà: nr 1

Q.ty: 1

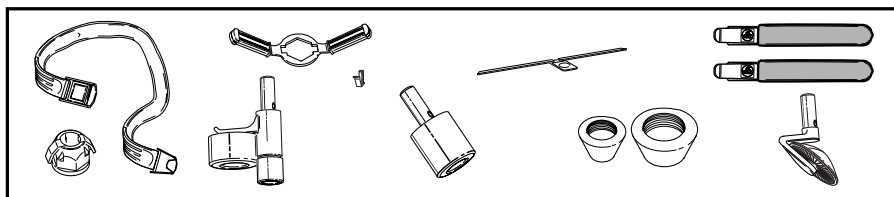
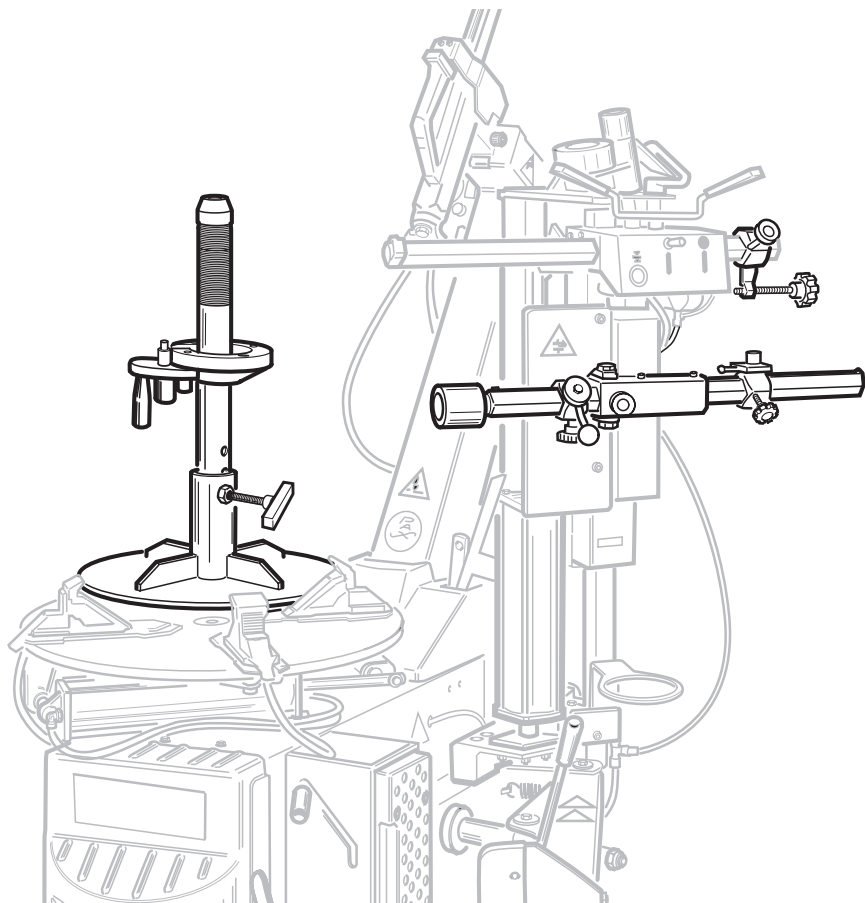

8-11100013 Kit per ruote PAX per SP2000
Kit for PAX tyres for SP2000

Q.tà: nr 1

Q.ty: 1

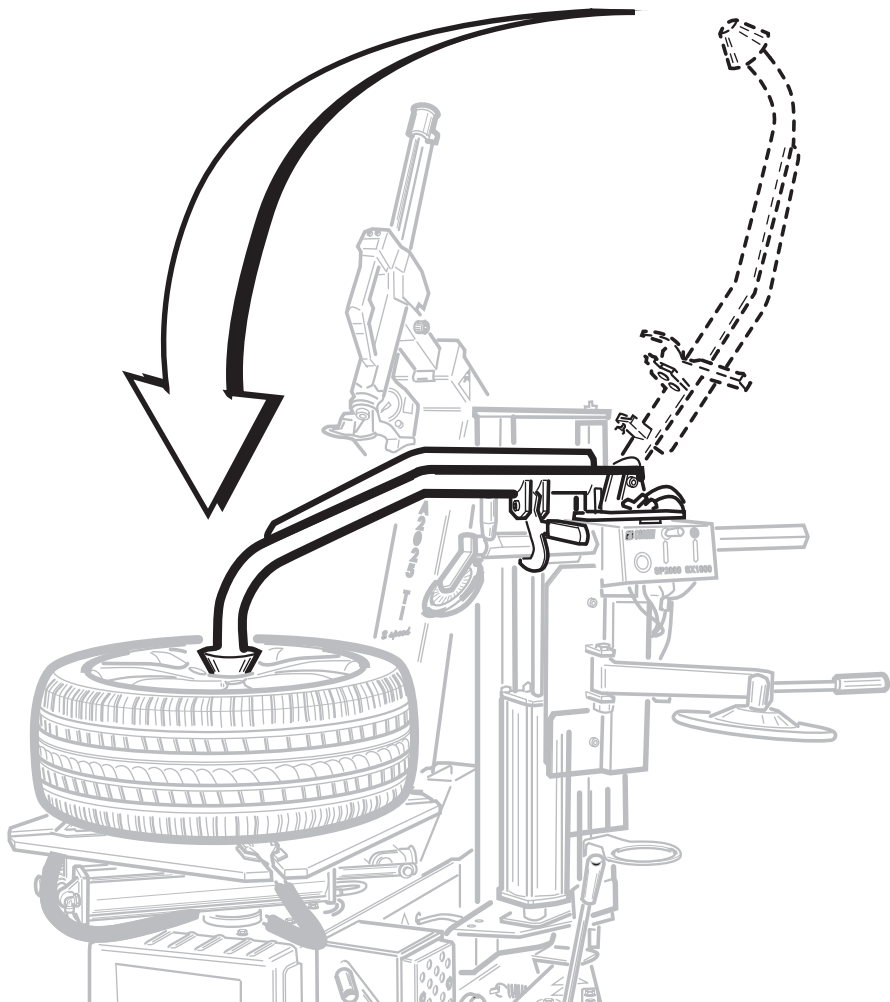

801255584 **Kit premi cerchio (da utilizzare con SP2000)**
Rim presser tool (to be used with SP2000)
(VAS6302/3)

Q.tà: nr 1

Q.ty: 1

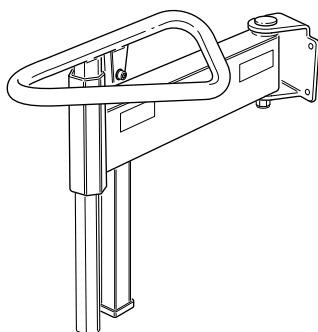

801248740 **SX1000 alzatalloni (da utilizzare con SP2000)**
SX1000 bead lifter (to be used with SP2000)

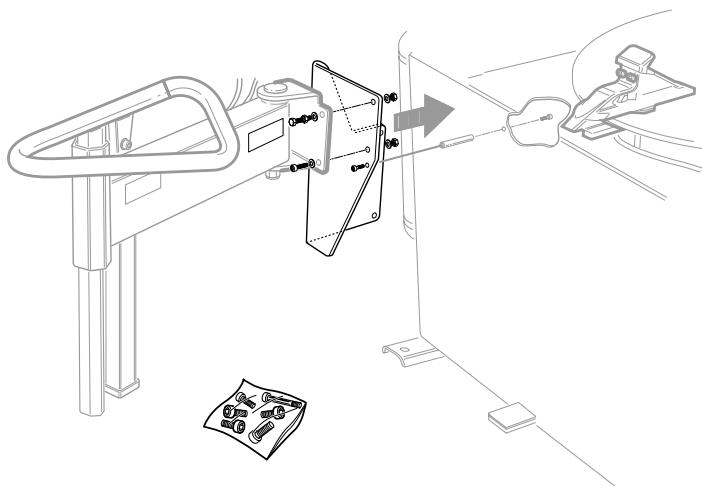

801250542 **Kit adattatore per SX 1000**
Adapter kit for SX 1000

Q.tà: nr 1

Q.ty: 1

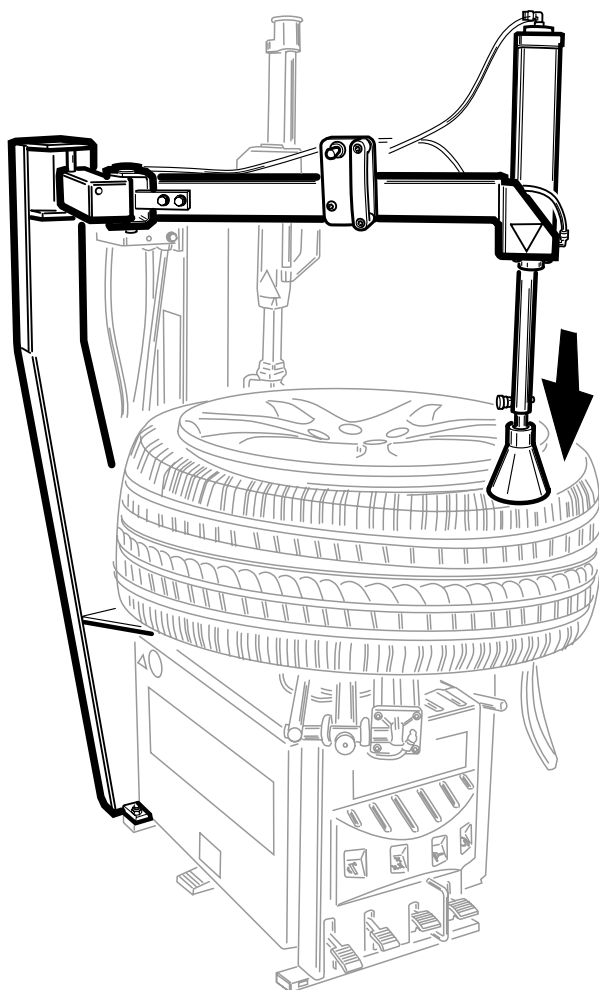

8-111000100

Kit premitallone con supporto
Pneumatic bead pressing tool with support
(VAS6302/4)

PU1500

Adattatore per:

Adapter for:

801260125

JOLLY

8-11100031

A2000 - A2005 - A2015/TI - A2020/TI - A2025/TI - A2030/TI
(VAS6134/1)

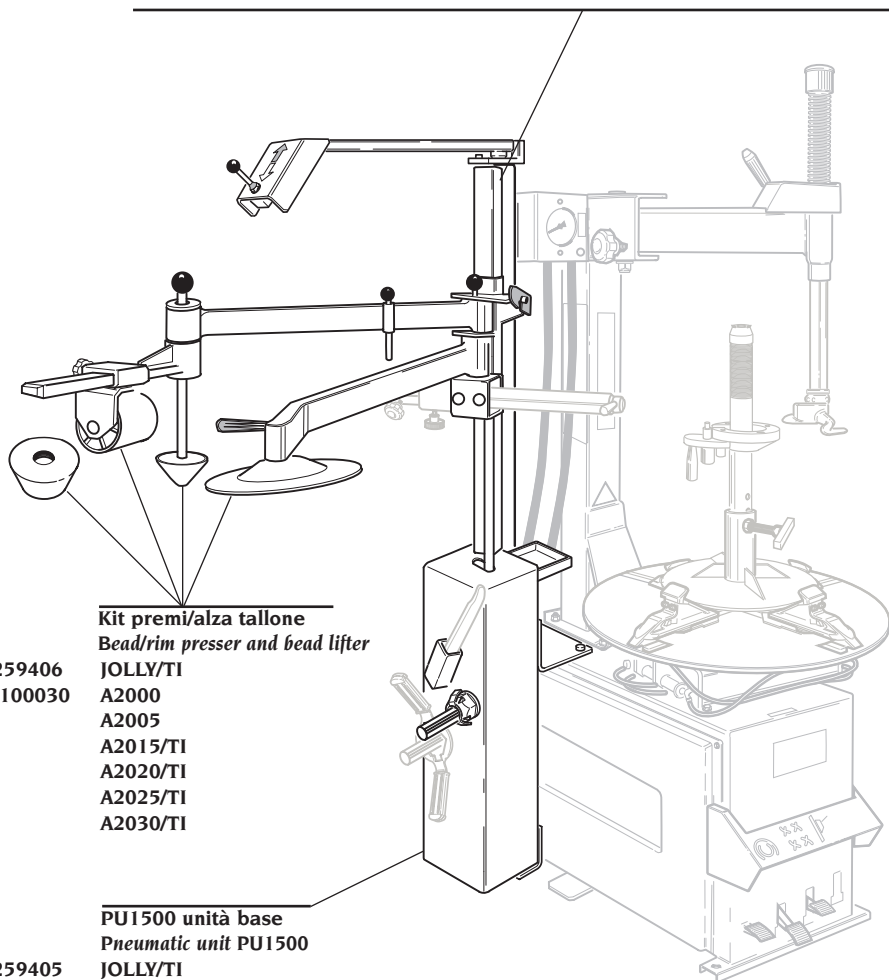

Kit premi/alza tallone
Bead/rim presser and bead lifter

801259406
8-11100030

JOLLY/TI
A2000
A2005
A2015/TI
A2020/TI
A2025/TI
A2030/TI

PU1500 unità base
Pneumatic unit PU1500

801259405
8-11100027

JOLLY/TI
A2000
A2005
A2015/TI
A2020/TI
A2025/TI
A2030/TI

(VAS6134/1)

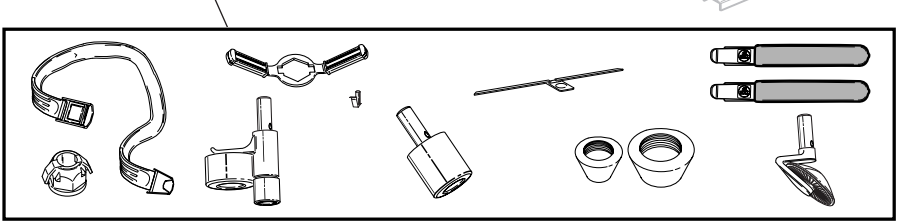

KIT PREMITALLONE PER SP2000 - SP2000 BEAD PRESSING TOOL

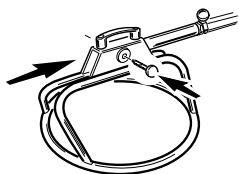
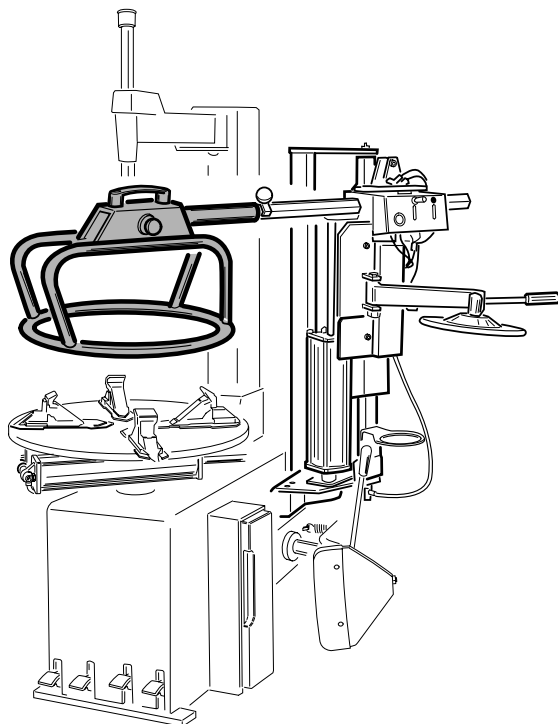

8-11100091 Kit anello premitallone 13"-14"-15"
Bead ring pressing tool kit 13"-14"-15"

8-11100093 Kit anello premitallone 16"-17"
Bead ring pressing tool kit 16"-17"

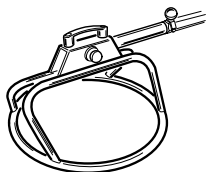

8-11100094 Kit anello premitallone 18"-19"
Bead ring pressing tool kit 18"-19"

8-11100095 Kit attacco prolunga SP2000
Kit extension adaptor SP2000

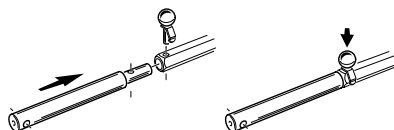

8-11100072 Sollevatore ruota per PU1500
Wheel lifting arm for PU1500

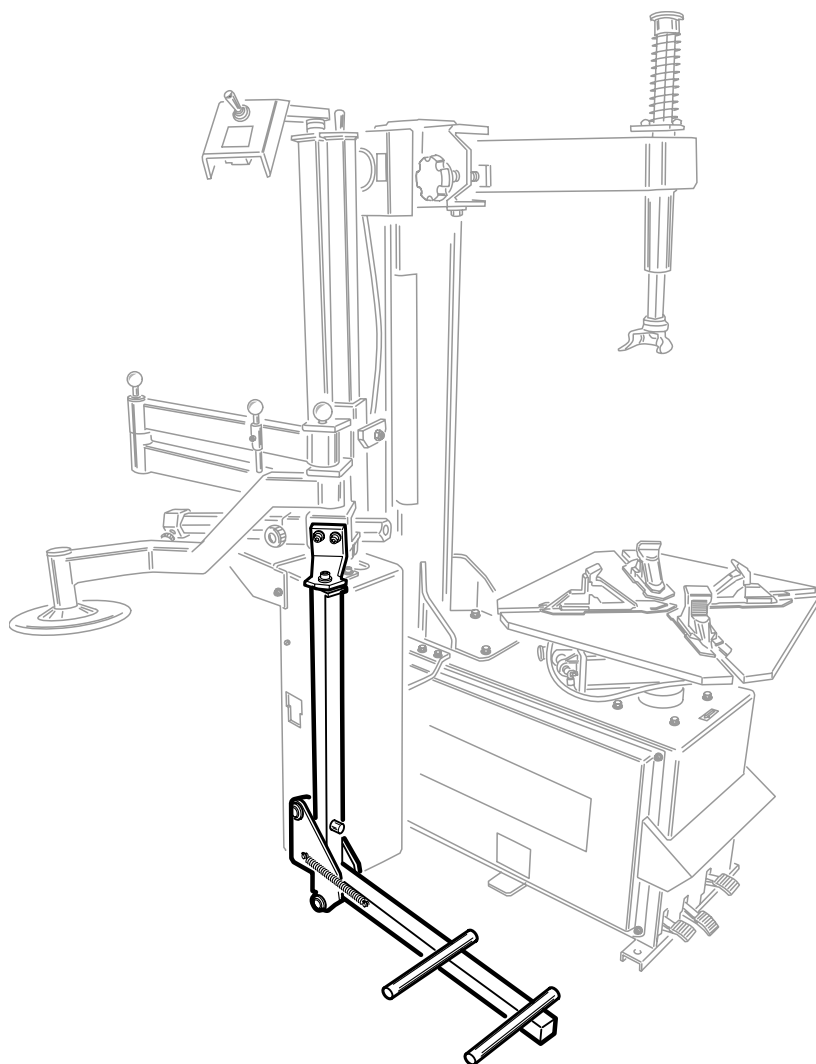

Q.tà: nr 4

Q.ty: 4

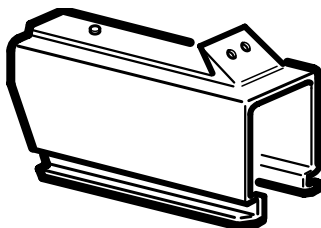

801263517 **Set di 4 adattatori per cerchi di 8" e 24"**
Set of 4 adapters for 8" and 24" rims

Q.tà: nr 4

Q.ty: 4

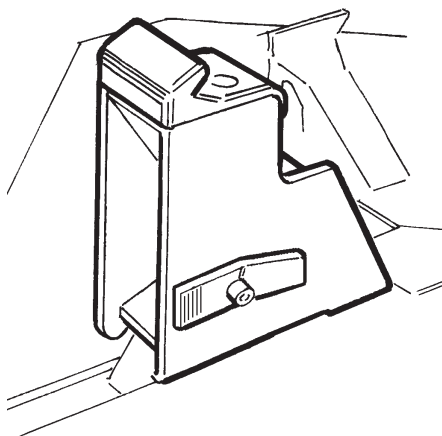

801258650 **Set di 4 adattatori per cerchi moto 15"-23"**
Set of 4 adapters for 15"-23" for motorcycle rims

Q.tà: nr 1

Q.ty: 1

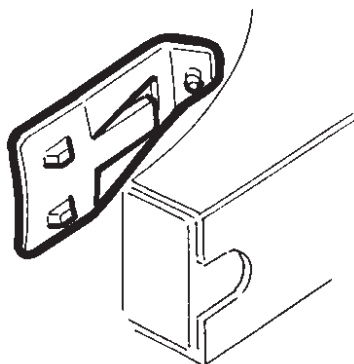

801260402 **Paletta stallonatore moto**
Motorcycle breaker blade

Q.tà: nr 1

Q.ty: 1

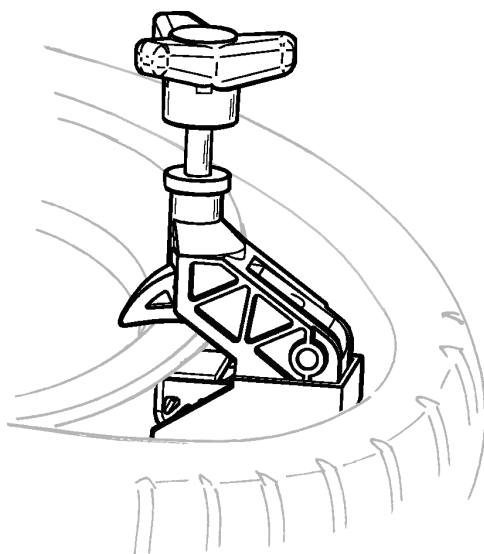

801262417 **Pinza premitallone per pneumatici Run Flat**
Bead pressing clamp for Run Flat tyres

Q.tà: nr 1

Q.ty: 1

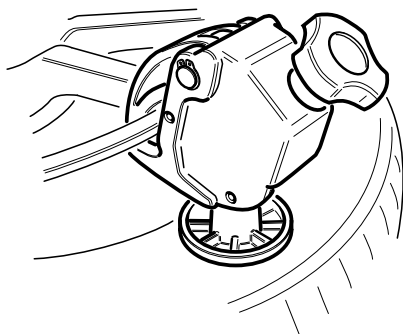

8-11100120

Morsetto basculante
Sliding bead pressing clamp

Q.tà: nr 6

Q.ty: 6

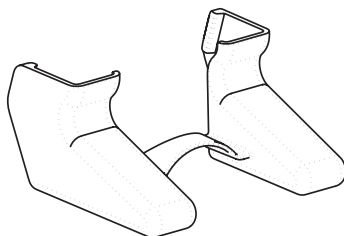

8-11100126

6 protezioni morsetto basculante (giallo)
6 protections for sliding bead pressing clamp (yellow)

Q.tà: nr 1

Q.ty: 1

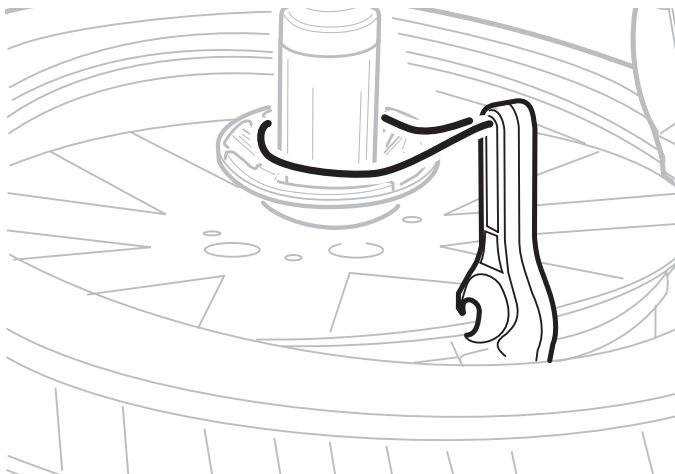

801261910 **Leva premitallone con cordino**
Plastic bead pressing lever with cord

Q.tà: nr 1

Q.ty: 1

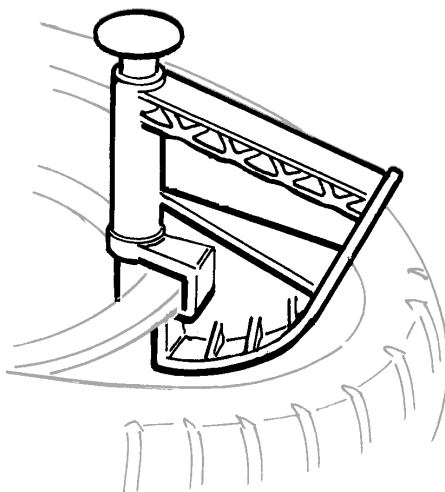

801435685 **Pinza in plastica**
Plastic bead pressing clamp

Q.tà: nr 1

Q.ty: 1

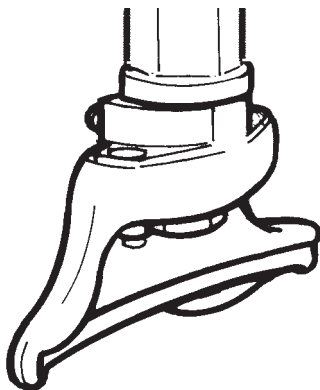

801250309 **Torretta in plastica**
Plastic head tool with support

Q.tà: nr 1

Q.ty: 1

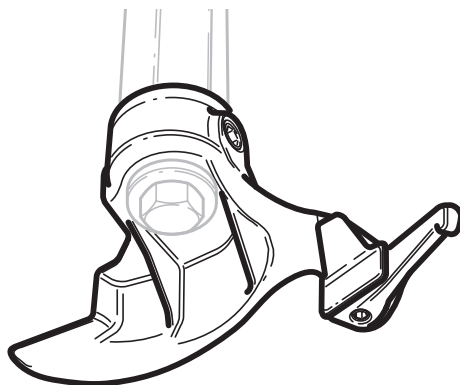

8-11100008 **Torretta RS**
Head tool RS

Q.tà: nr 1

Q.ty: 1

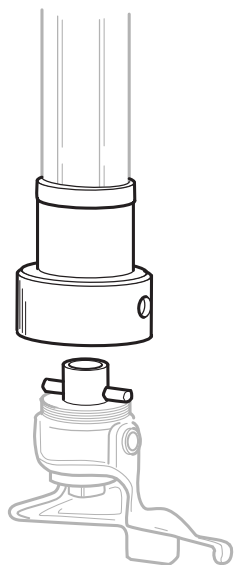

8-11100001 **Kit innesto rapido torretta**
M/D tool fast fitting kit

Q.tà: nr 1

Q.ty: 1

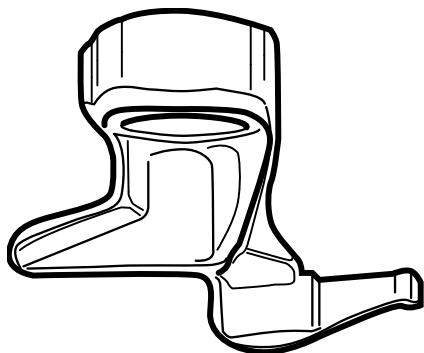

801252083 **Torretta per ruote scooter da 8"**
Scooter m/d tool for 8" rims

Q.tà: nr 1

Q.ty: 1

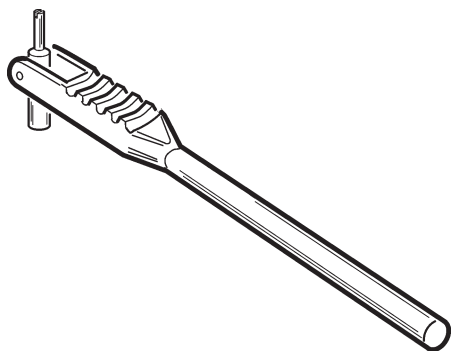

801461004 **Leva per posizionare la valvola**
Valve-inserting lever

Q.tà: nr 1

Q.ty: 1

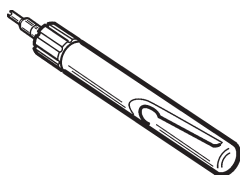

801461005 **Attrezzo per svitare l'inserto valvola**
Valve core screwdriver

Q.tà: nr 1

Q.ty: 1

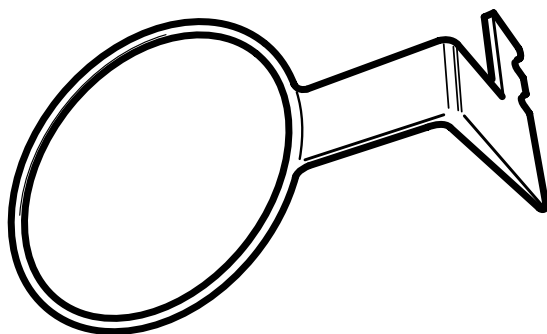

801232202 **Supporto per grasso - 5 Kg**
5 Kg grease bucket holder

Q.tà: nr 6

Q.ty: 6

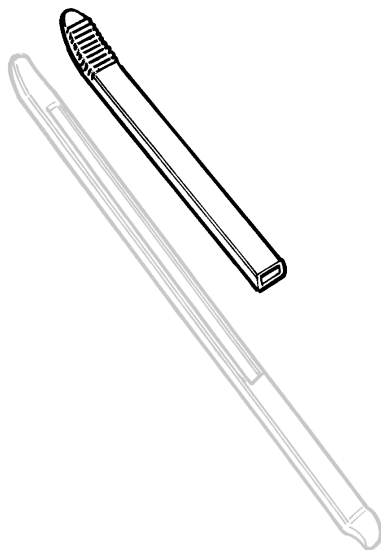

8-11100104 **6 protezioni per leva di m/smontaggio (giallo)**
6 protections for bead lever (yellow)

Q.tà: nr 6

Q.ty: 6

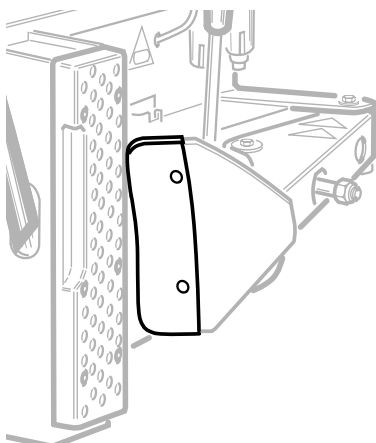

8-11100105 6 protezioni per paletta (giallo)
6 protections for blade (yellow)

Q.tà: nr 10

Q.ty: 10

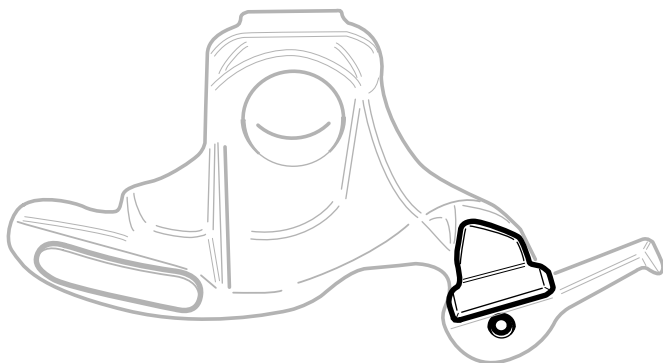

8-11100106 10 inserti per torretta (giallo)
10 front inserts for head tool (yellow)

Q.tà: nr 10

Q.ty: 10

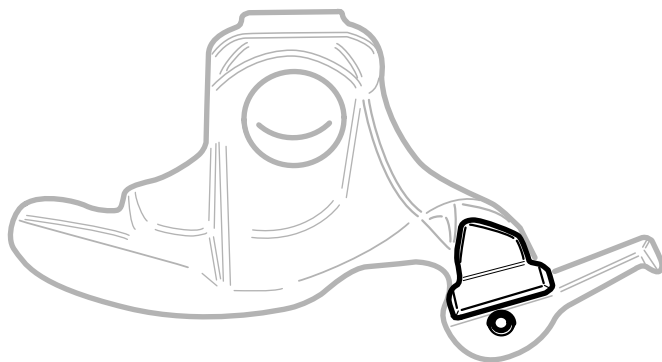

8-11100045 10 inserti in plastica per torretta RS
10 front plastic inserts for RS head tool

Q.tà: nr 5

Q.ty: 5

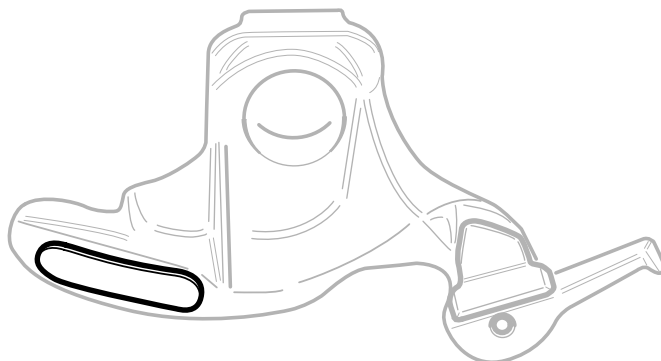

8-11100107 5 pastiglie per torretta (giallo)
5 bottom inserts for head tool (yellow)

Q.tà: nr 12

Q.ty: 12

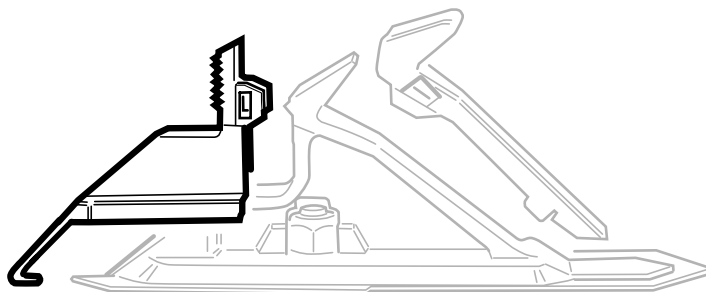

8-11100109 **12 protezioni esterne per cuneo di bloccaggio (giallo)**
12 front outside clamp protections (yellow)

Q.tà: nr 12

Q.ty: 12

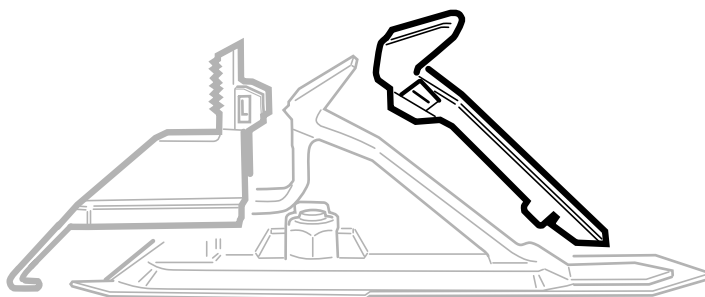

8-11100108 **12 protezioni interne per cuneo di bloccaggio (giallo)**
12 front inside clamp protections (yellow)

Q.tà: nr 10

Q.ty: 10

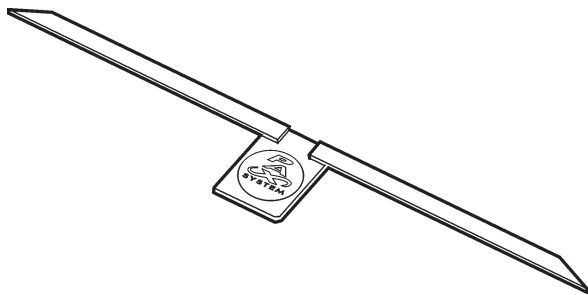

801260235 **10 protezioni in plastica "reglette" per Pax System**
10 plastic Pax System protections "reglette"

Q.tà: nr 3

Q.ty: 3

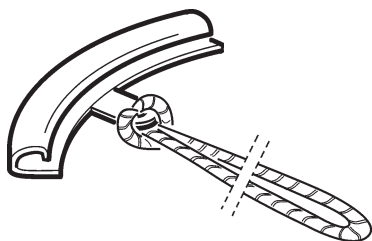

801461007 **3 protezioni in plastica per bordo cerchio**
3 plastic protections for rim edge

Q.tà: nr 1

Q.ty: 1

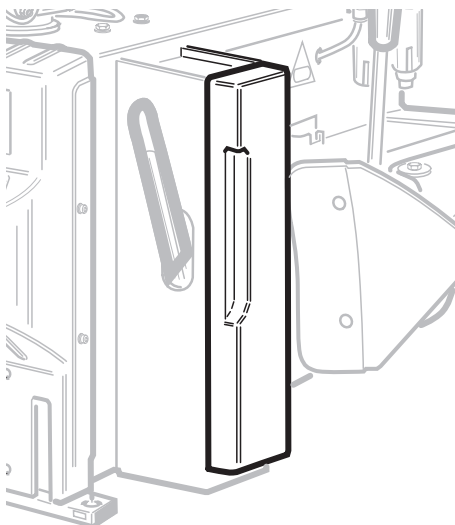

801458663 **Protezione per appoggio cerchio**
Plastic protection for bead breaker pad

Note

This image shows a full page of handwriting practice paper. It features multiple rows of horizontal dashed lines spaced evenly down the page, providing a guide for letter height and placement. The paper is otherwise blank, with no text or other markings.

Note

[illegible]

Smontagomme pesanti

Heavy-duty tyre changers

Q.tà: nr 1

Q.ty: 1

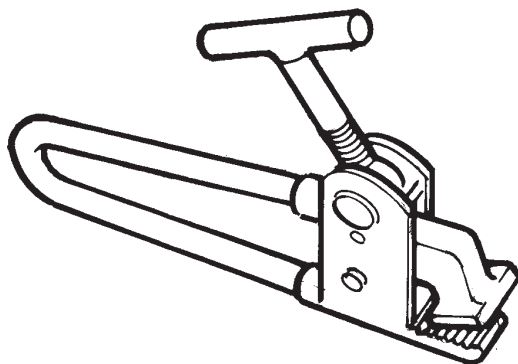

801224201 **Pinza lunga**
Longer rim clamp for big tyre mounting

Q.tà: nr 1

Q.ty: 1

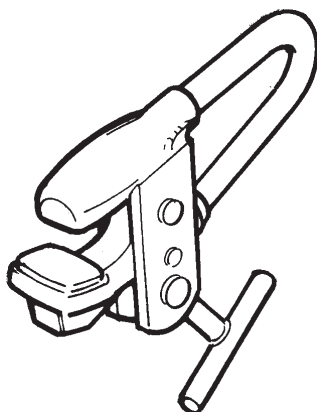

801227195 **Pinza per cerchi in lega**
Alloy rim clamp tool

Q.tà: nr 1

Q.ty: 1

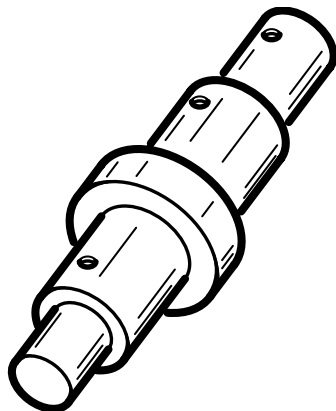

801237171 **Perno di fermo per cerchi in lega**
Locking pin for alloy rims

Q.tà: nr 4

Q.ty: 4

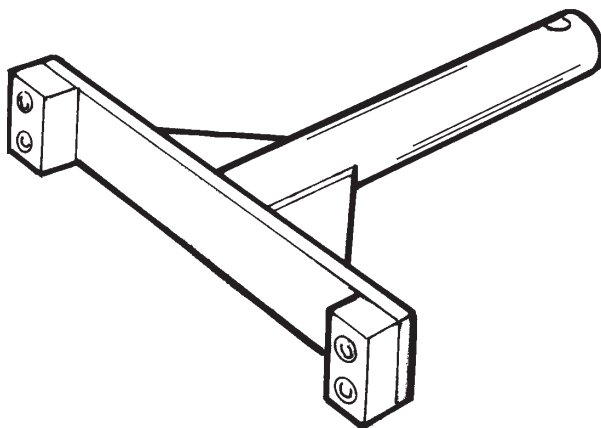

801237727 **Set di 4 prolunghe per cerchi da riso e canna**
Set of 4 adapters for clamping Rice and Cane wheels (no flange, all open centre)

Q.tà: nr 4

Q.ty: 4

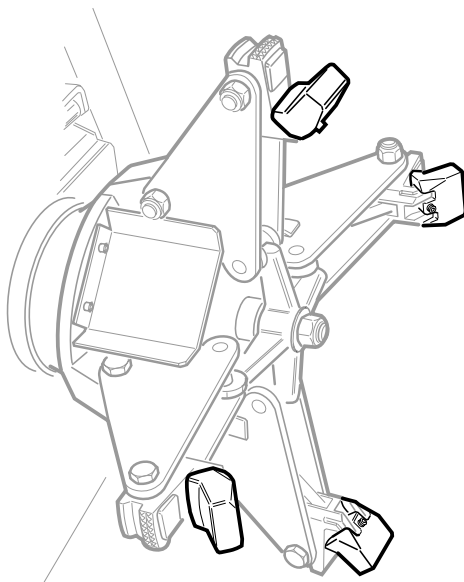

801254494 **Set di 4 protezioni griffa (AG DOUBLE TT)**
Set of 4 aluminium protections for alloy rims (AG DOUBLE TT)

Q.tà: nr 1

Q.ty: 1

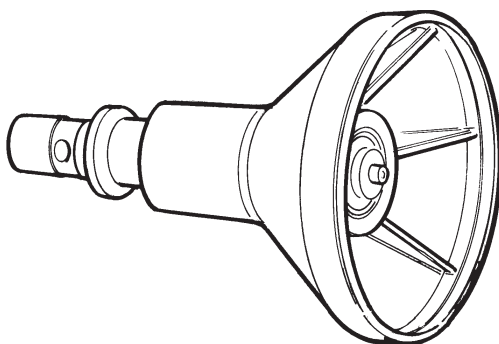

Rullo per tubeless
Bead breaking tubeless tyre roller

801243547 **HD1000 - HD1400**

801245306 **AG DOUBLE TT**

Q.tà: nr 1

Q.ty: 1

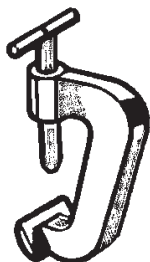

801217635 **Morsetto di smontaggio**
Clamp for demounting

Q.tà: nr 1

Q.ty: 1

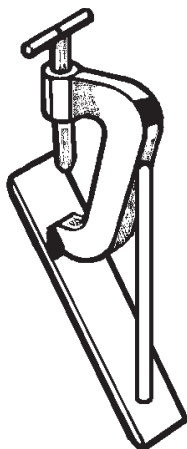

801251904 **Morsetto di montaggio per ruote Skidder**
Skidder clamp

Q.tà: nr 1

Q.ty: 1

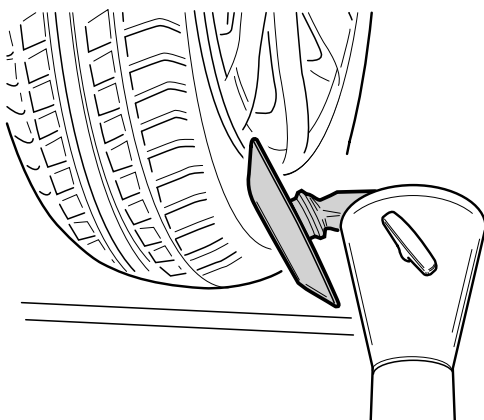

8-12100030 Kit disco stallonatore (HD 600 / HD 600 TILT)
Bead breaker disc kit (HD 600 / HD 600 TILT)

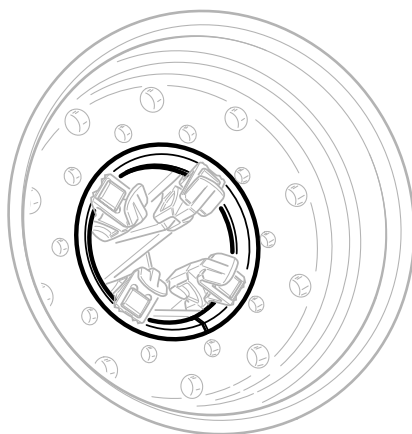

8-12100010 Anello di bloccaggio cerchi in lega Ø 281 mm (A)
Locking adapter for alloy wheels Ø 281 mm (A)

8-12100009 Anello di bloccaggio cerchi in lega Ø 221 mm (B)
Locking adapter for alloy wheels Ø 221 mm (B)

8-12100008 Anello di bloccaggio cerchi in lega Ø 202 mm (C)
Locking adapter for alloy wheels Ø 202 mm (C)

8-12100007 Anello di bloccaggio cerchi in lega Ø 161 mm (D)
Locking adapter for alloy wheels Ø 161 mm (D)

Q.tà: nr 1

Q.ty: 1

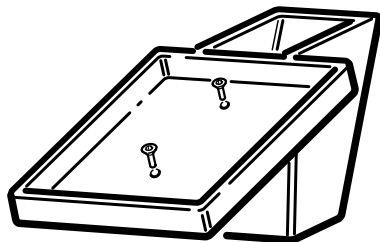

801244038 **Supporto per attrezzo rescolpitore (AG DOUBLE TT)**
Housing metal box for re-groover (AG DOUBLE TT)

Q.tà: nr 4

Q.ty: 4

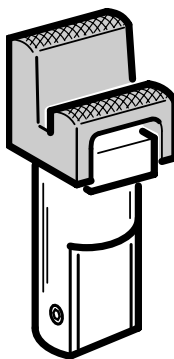

801249632 **Set di 4 griffe per cerchi da 40"**
Set of adapters for 40"

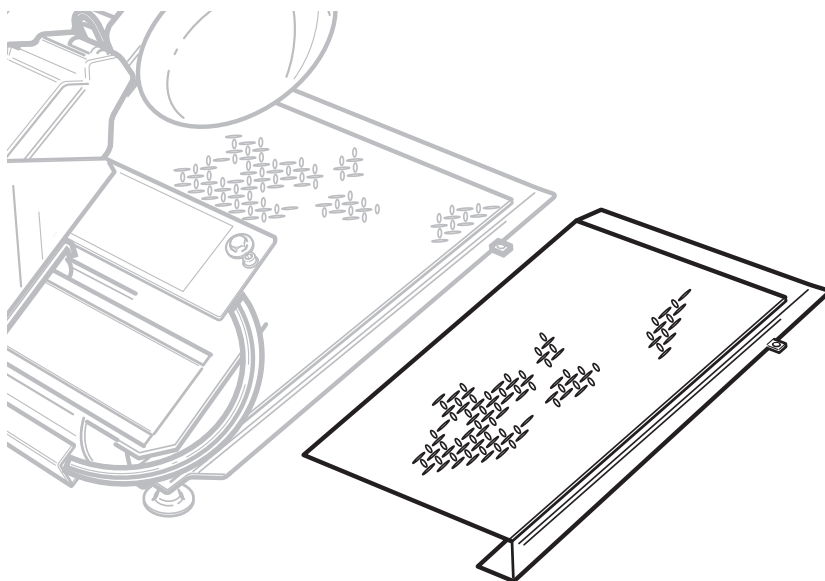

tà: nr 1
Q.ty: 1

801260280 **Kit pedana (AG DOUBLE TT)**
Runway kit (AG DOUBLE TT)

Q.tà: nr 1
Q.ty: 1

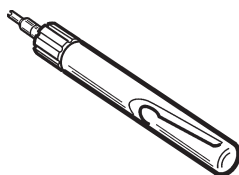

801461005 **Attrezzo per svitare l'inserto valvola**
Valve core screwdriver

Q.tà: nr 1

Q.ty: 1

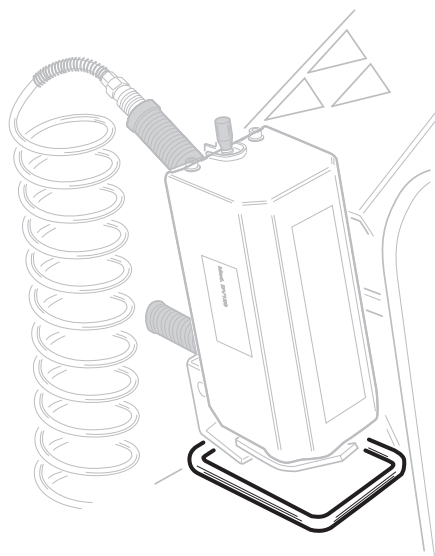
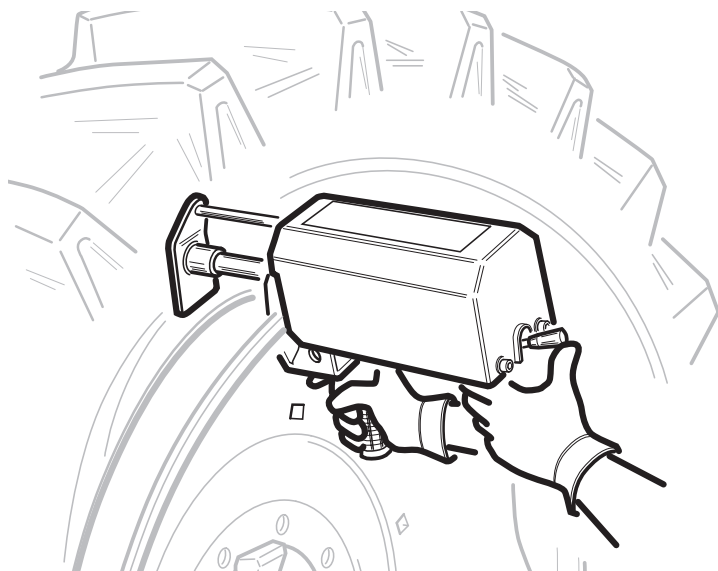

0-12100701 DV120 - Premitallone
DV 120 - Bead pressing device

Kit RADIO

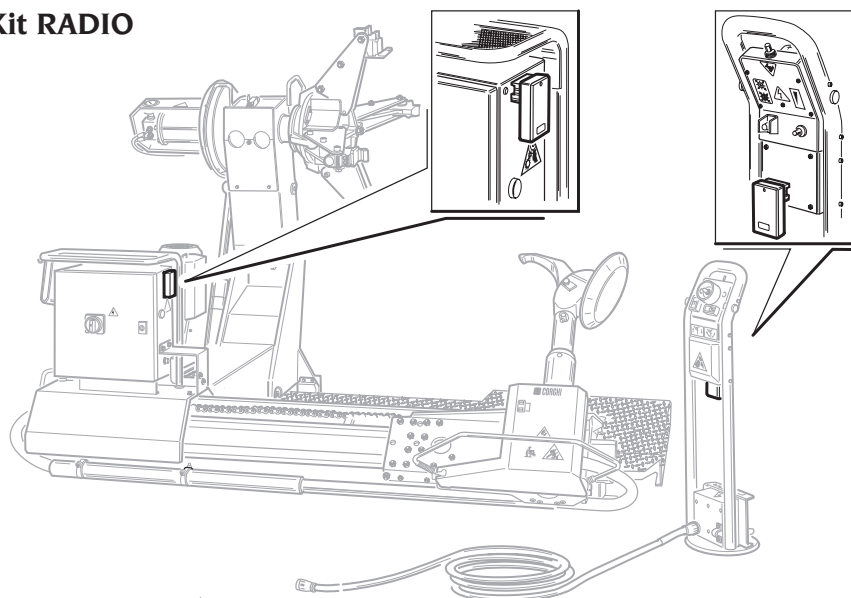

8-12100016B Kit Radio
Radio remote control kit
HD 1400 MasterOne, HD 1400, HD 1400 E

Q.tà: nr 1

Q.ty: 1

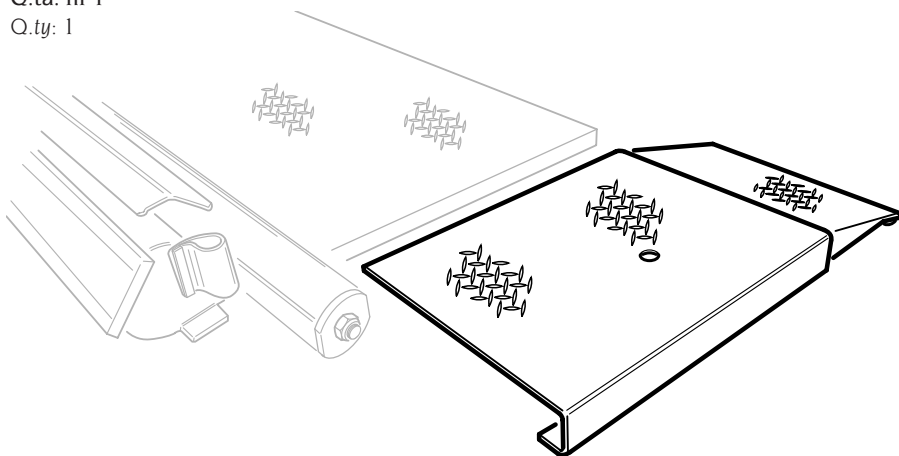

8-12100023 Kit pedana (HD1400 MasterONE, HD1400, HD1400E)
Runway kit (HD1400 MasterONE, HD1400, HD1400E)

Note
