

ACCESSORI ORIGINALI

per smontagomme

ARTIGLIO 500

Cod.4-108707 del 04/09

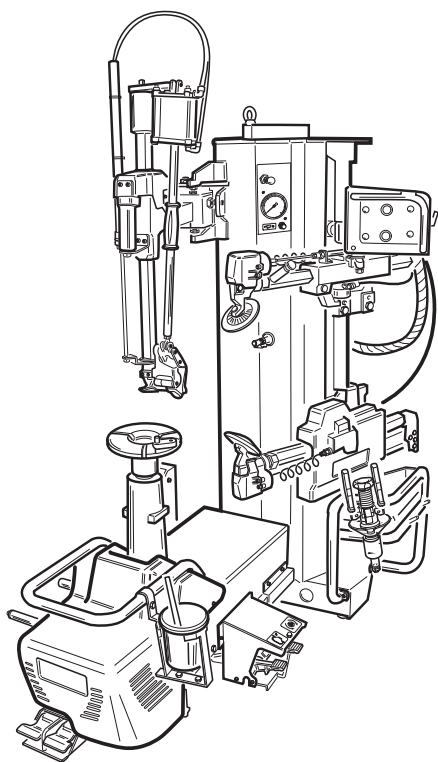

ORIGINAL ACCESSORIES

for tyre changers

ARTIGLIO 500



Legenda



Accessori di serie
Standard accessories



Accessori a richiesta
Accessories optional

801XXX
8-XXX

Accessori
Accessories

XXX

Ricambi
Spare parts

Q.tà: nr 1
Q.ty: 1

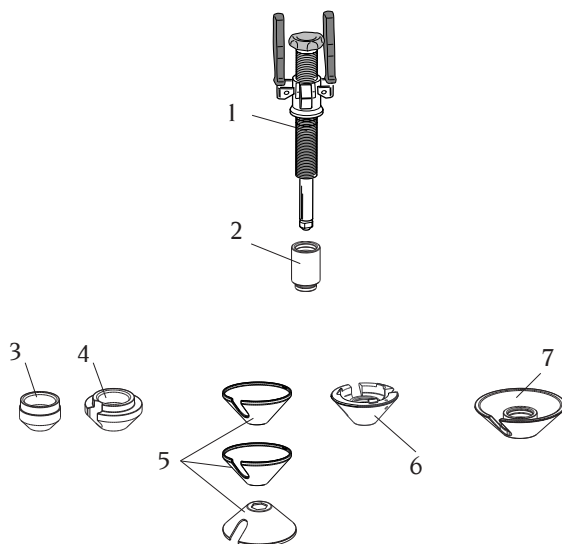

1	Maniglia completa 5-101197 <i>Universal locking pistol</i>
2	Prolunga per maniglia (M9) 5-101204 <i>Extention for locking pistol (M9)</i>
3	Cono Ø58 (M13)..... 4-103235 <i>Cone Ø58 (M13)</i>
4	Cono Ø75 (M14)..... 4-103234 <i>Cone Ø75 (M14)</i>
5	3 Cuffie protezione cono Ø120 (M7) 4-103232 <i>3 Protection cap for cone Ø120 (M7)</i>
6	1 Cono Ø120 (M11)..... 4-103230 <i>1 Cone Ø120 (M11)</i>
7	Cono Ø145 (M2)..... 4-103229 <i>Cone Ø145 (M2)</i>

Q.tà: nr 1

Q.ty: 1

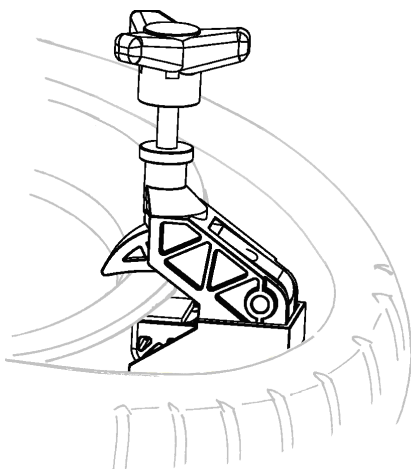

34 801262417

Pinza premitallone per pneumatici Run Flat
Bead pressing clamp for Run Flat tyres

Q.tà: nr 1

Q.ty: 1

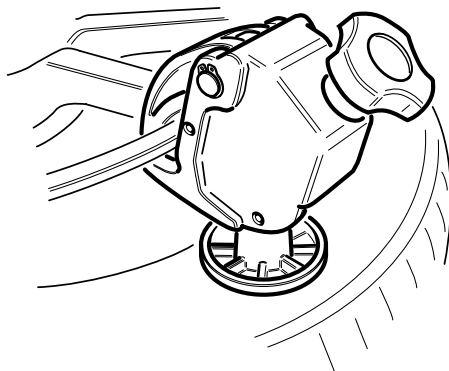

35 8-11100120

Morsetto basculante
Sliding bead pressing clamp

Q.tà: nr 1
Q.ty: 1

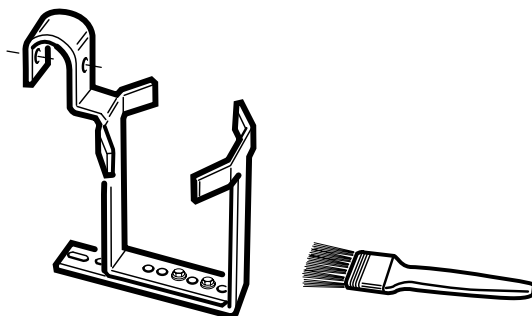

28 5-101236

Portagrasso universale
Universal grease bucket holder

Q.tà: nr 1
Q.ty: 1

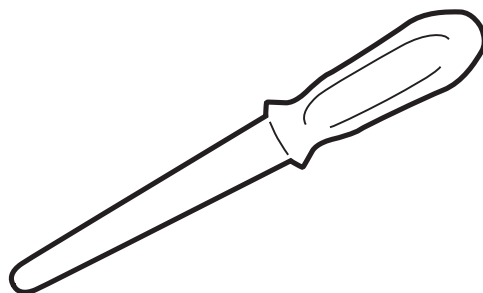

32 4-405496

Nuovo pugnale
New lever

Q.tà: nr 1

Q.ty: 1



11 8-11100086 Kit cerchi furgone
Pick-up rim kit

- 12 Cono Ø187 (M15).....4-103233
Cone Ø187 (M15)
- 13 Anello distanziale (M10)5-100690
Spacer ring (M10)

Q.tà: nr 1

Q.ty: 1

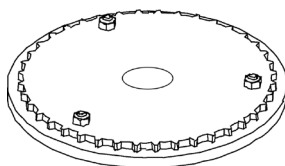

16 8-11100009 Kit "Wire Wheel" (da usare con il cod.5-101197)
"Wire Wheel" kit (to be used with code 5-101197)

Q.tà: nr 1

Q.ty: 1

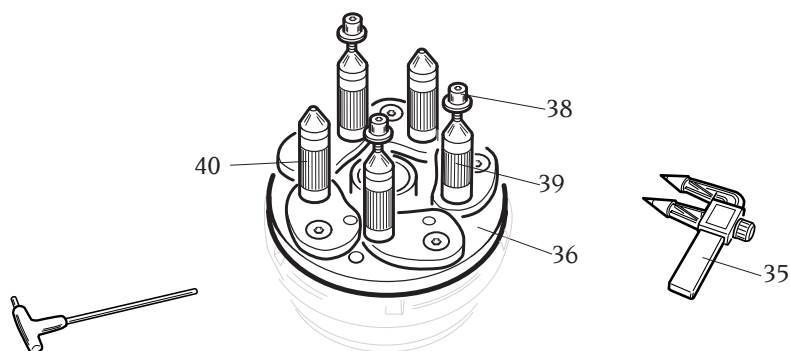

33	8-11100039	Flangia per ruote a canale rovescie <i>Reverse wheel flange</i>	
38		Ghiera di serraggio 4-102377 <i>Ring nut</i>	
39		Colonna con serraggio con biella..... 5-102721 <i>Column with locking device</i>	
40		Colonnelle con biella..... 5-102720 <i>Columns with locking device</i>	
36		Flangia universale..... 5-102422 <i>Universal flange</i>	
35		Rilevatore fori..... 441286 <i>Hole detector</i>	

Q.tà: nr 1

Q.ty: 1

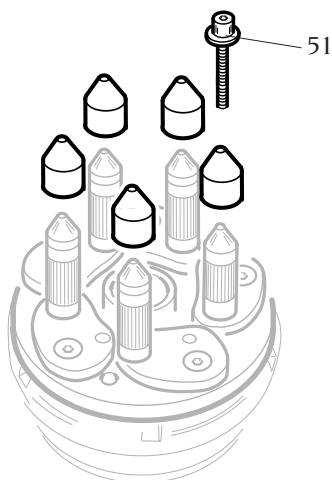

14 8-11100046 **Kit estensioni per flangia per ruote a canale rovescie e cieche
(da utilizzare esclusivamente con i seguenti codici 8-11100039,
8-11100087 e 8-11100110)**

***Extension kit for reverse and closed wheel (to be used with the accessories
code 8-11100039, 8-11100087 and code 8-11100110)***

51 Ghiera di serraggio lunga 4-102566
Long ring nut

Q.tà: nr 1

Q.ty: 1

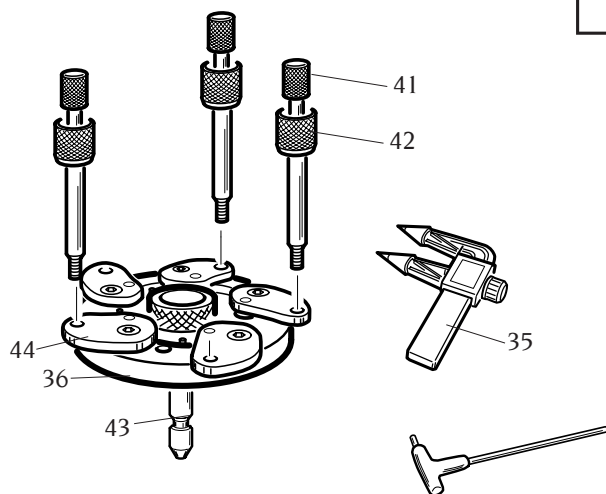

21	8-11100087	Flangia universale cerchi ciechi Universal flange for close centre rims
38		Ghiera di serraggio 4-102377 Ring nut
41		Vite fissaggio cerchi 361647 Rim fixing screw
42		Ghiera fissaggio cerchi 361648 Rim fixing ring nut
43		Barra attacco platorello 4-103765 Exagonal bar
44		Biella..... 4-107023 Connecting rod
36		Flangia universale..... 5-102422 Universal flange
35		Rilevatore fori..... 441286 Hole detector

Q.tà: nr 1

Q.ty: 1

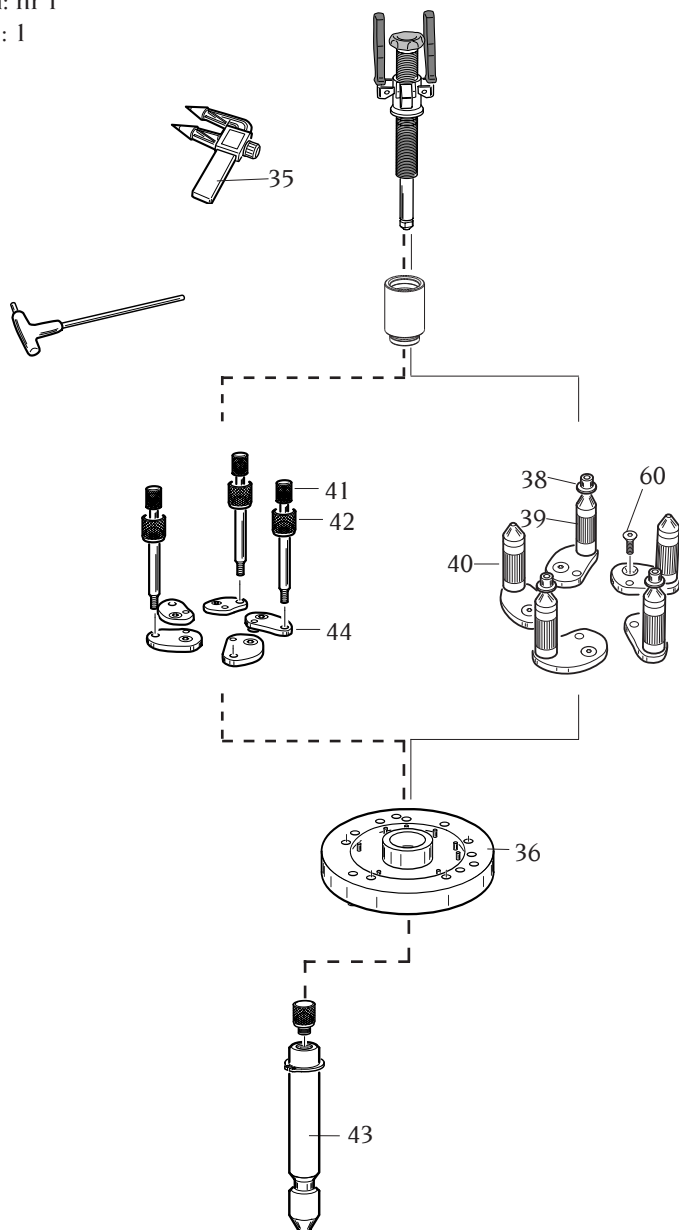

Cerchi ciechi / Close centre rim

Cerchi rovesci / Reverse rim

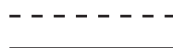

49	8-11100110	Kit ruote NON STANDARD Not STANDARD rim kit	
38		Ghiera di serraggio 4-102377 <i>Ring nut</i>	
39		Colonneta con serraggio con biella..... 5-102721 <i>Column with locking device</i>	
40		Colonnette con biella..... 5-102720 <i>Columns with locking device</i>	
36		Flangia universale..... 5-102422 <i>Universal flange</i>	
41		Vite fissaggio cerchi ciechi..... 361647 <i>Rim fixing screw</i>	
42		Ghiera fissaggio cerchi ciechi 361648 <i>Rim fixing ring nut</i>	
43		Barra attacco platorello 4-103765 <i>Exagonal bar</i>	
44		Biella 4-107023 <i>Connecting rod</i>	
35		Rilevatore fori..... 441286 <i>Hole detector</i>	
60		Vite fissaggio bielle 4-101250	

-

Q.tà: nr 1
Q.ty: 1

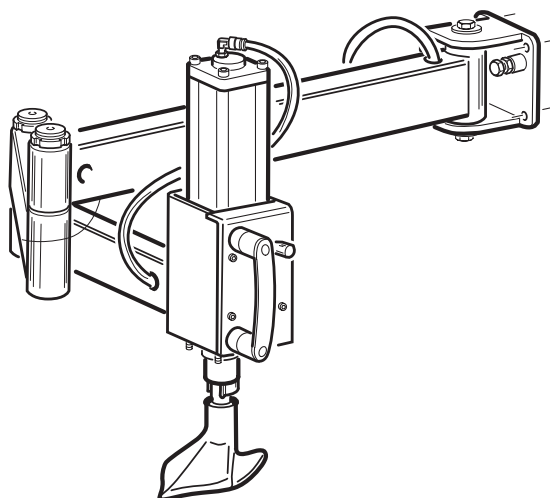

8-11100221

Premitallone
Bead pressing tool

Q.tà: nr 1
Q.ty: 1

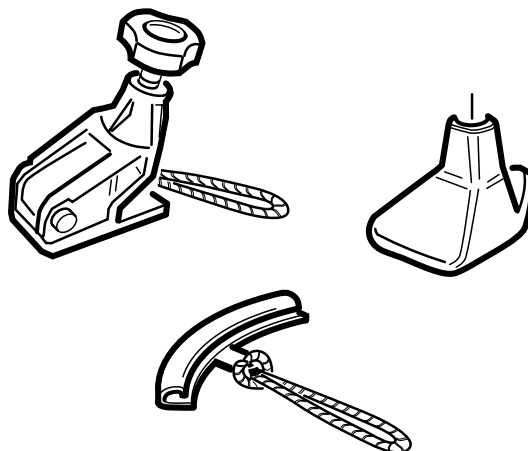

8-11100190

Kit Run Flat
Kit Run Flat

Q.tà: nr 1

Q.ty: 1

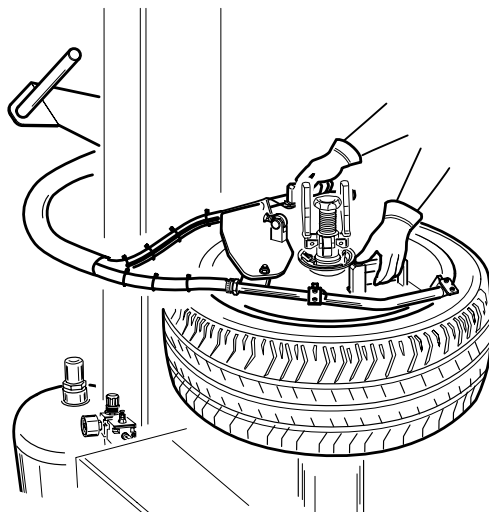

- 23 8-11100111 **Kit intallonamento rapido: T.I system**
T.I system kit

Q.tà: nr 1

Q.ty: 1

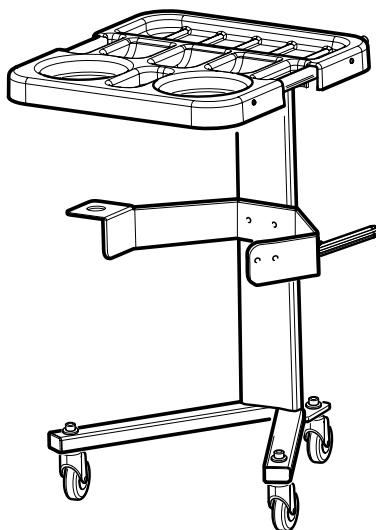

0-51100101/16

EasyTrolley carrello porta accessori
Accessory-holder EasyTrolley

Q.tà: nr 1

Q.ty: 1

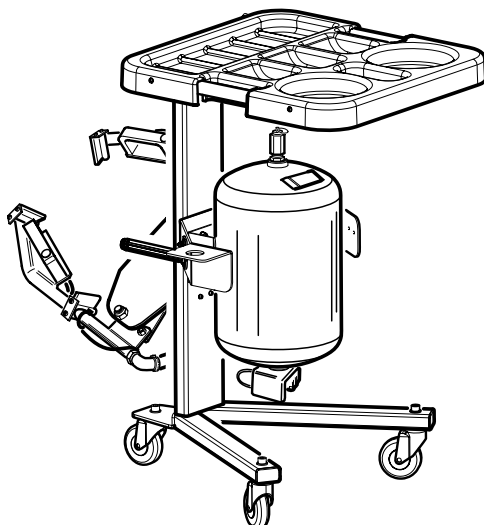

0-51100102/16

EasyTrolley carrello porta accessori + T.I. system CE
Accessory-holder EasyTrolley + T.I. system CE

0-51100103/16

EasyTrolley carrello porta accessori + T.I. system ASME (solo per mercato USA)
Accessory-holder EasyTrolley + T.I. system ASME (for USA market only)

Q.tà: nr 1

Q.ty: 1

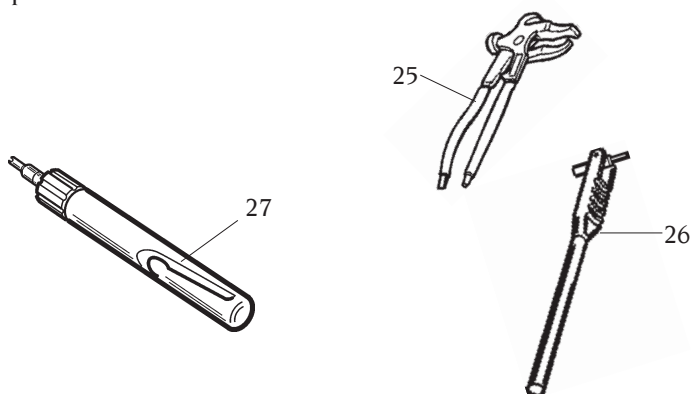

25 Pinza per applicare o togliere contrappesi 203841
Pliers for weight fixing and removing

26 Leva per posizionare la valvola 801461004
Valve-inserting lever

27 Attrezzo per svitare l'inserto valvola 801461005
Valve core screwdriver

Q.tà: nr 1

Q.ty: 1

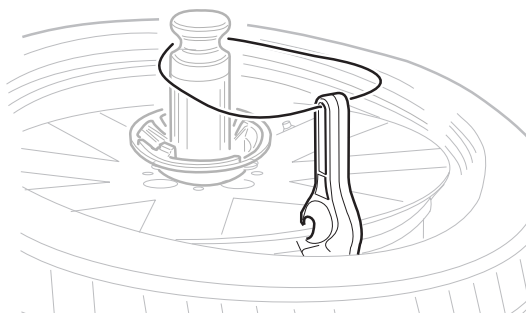

30 801261910 **Leva premitallone con cordino**
Plastic bead pressing lever whit cord

Q.tà: nr 1

Q.ty: 1

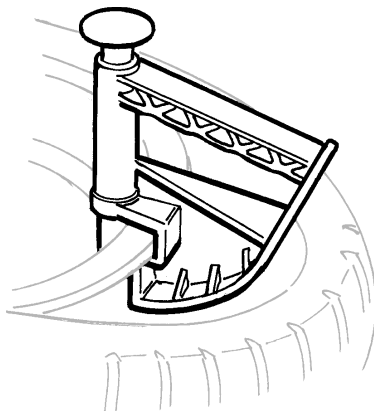

29 801435685

Pinza in plastica
Plastic bead pressing clamp

Q.tà: nr 1

Q.ty: 1

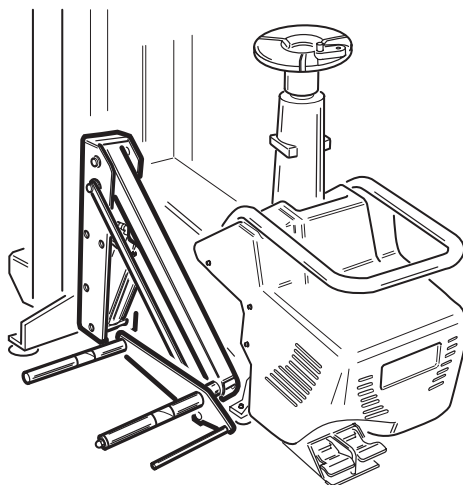

18 8-11100085

Kit sollevatore ruota
Wheel lifter kit

Q.tà: nr 1 staffa

Q.ty: 1 clamp

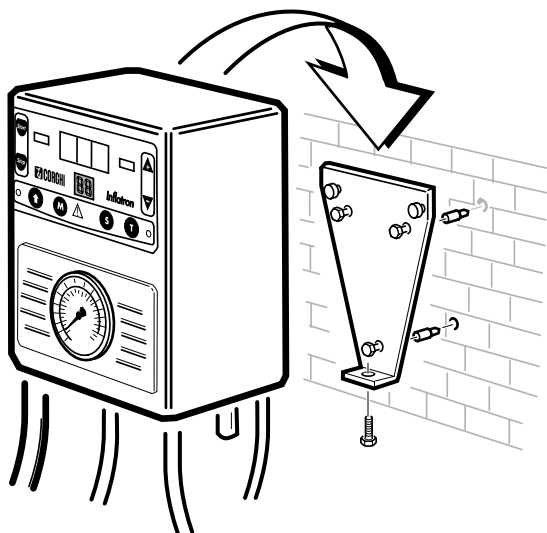

8-11400048

INFLATRON con installazione a muro
Wall mounting INFLATRON

Note

This image shows a full page of handwriting practice paper. It features ten identical rows of horizontal dashed lines, each consisting of three short segments separated by gaps. These lines are designed to help children learn letter height and placement. The entire page is enclosed within a thin black rectangular border.



CORGHI

CORGHI S.p.A. - Strada Statale 468 n.9
42015 CORREGGIO - R.E. - ITALY
Tel. ++39 0522 639.111 - Fax ++39 0522 639.150
www.corgi.com - info@corgi.com