



Pro Line 322

Pro Line 322 TI

Pro Line 122

Pro Line 122 Normal

Cod. 4-100045A del 07/11

Italiano

Manuale d'uso

3

English

Operator's manual

45

Français

Manuel d'utilisation

87

Deutsch

Betriebsanleitung

129

Español

Manual de uso

171

TRANSLATION OF ORIGINAL INSTRUCTIONS

TABLE OF CONTENTS

NAMEPLATE	46
GUARANTEE CLAUSE	46
INTRODUCTION	46
TRANSPORT, STORAGE AND HANDLING	47
Conditions for transporting the machine.....	47
Machine storage and shipping specifications.....	47
Handling.....	47
UNPACKING / ASSEMBLY	47
HOISTING	51
CUSTOMISATION	52
INSTALLATION CLEARANCES.....	56
Work environment conditions.....	56
ELECTRICAL AND PNEUMATIC CONNECTIONS	57
SAFETY REGULATIONS.....	58
TYRE CHANGER DESCRIPTION	56
TECHNICAL DATA.....	58
INTENDED OPERATING CONDITIONS.....	61
MAIN WORKING ELEMENTS OF THE MACHINE	61
WARNING AND INSTRUCTION DECALS APPLIED ON THE MACHINE	63
INSTRUCTIONS FOR USE	65
BEAD BREAKING	65
Deciding from which side of the wheel the tyre must be demounted	65
Special instructions	65
Bead breaking	66
PNEUMATIC DEMOUNTING.....	67
PNEUMATIC MOUNTING	69
INFLATING PROCEDURE.....	70
Warnings and Hazards.....	70
Inflation procedure.....	70
Procedure for tubeless tyres (TI versions only)	71
TROUBLE SHOOTING	71
MAINTENANCE	73
WIRING DIAGRAM	75
PNEUMATIC DIAGRAM	78
INFORMATION ABOUT DEMOLITION.....	82
ENVIRONMENTAL INFORMATION.....	82
ADVICE AND WARNINGS ON HYDRAULIC FLUID	83
RECOMMENDED FIRE EXTINGUISHING EQUIPMENT.....	84
GLOSSARY	84

UK

COMIM - Code 4~100045A - 07/11

NAMEPLATE

Note here the following information, obtained from the serial number plate.

SERIAL NUMBER:

MODEL NUMBER:

DATE OF MANUFACTURE:

GUARANTEE CLAUSE

The machine, including the operating system, tools and accessories, is covered by a 1-year guarantee after confirmation of the absence of damage or improper use. During this period, the manufacturer will repair or replace the parts returned or the machine itself, sustaining the costs but not accepting responsibility for normal wear and tear, incorrect use or transportation, or failure to carry out maintenance. The manufacturer will not inform the customer about any improvements to the products or the upgrading of the production lines, as the resulting difference is not covered by this guarantee. All the modifications in this guarantee clause refer to the model and serial number of the machine, and all complaints must indicate the above-mentioned information.

INTRODUCTION

The purpose of this manual is to provide the owner and machine operator with effective, safe instructions for the use and maintenance of the tyre changer.

Following these instructions carefully will ensure efficient, durable service from your machine, contributing to significantly facilitate your work.

The following paragraphs define the levels of danger regarding the machine associated with the warning captions found in this manual:

DANGER

Immediate danger, causing serious injury or death.

WARNING

Danger or unsafe procedures that could cause serious injury or death.

WARNING

Danger or unsafe procedures that could cause minor injury or material damage.

Read these instructions carefully before powering up the machine. Keep this manual and all illustrative material supplied with the machine in a folder near the tyre changer, where it is readily accessible for consultation by the machine operator.

The technical documentation supplied is considered an integral part of the machine, and must always accompany the equipment if it is sold or transferred to a new owner.

The manual is only to be considered valid for the machine of the model and serial number indicated on the nameplate applied to it.



WARNING

Adhere to the contents of this manual: The producer declines all liability in the **case of actions not specifically described** and authorised in this manual.

NOTE

Some of the illustrations contained in this manual were derived from photos of prototypes: the standard production machines may differ in some details.

These instructions are for the attention of personnel with basic mechanical skills. We have therefore condensed the descriptions of each operation by omitting detailed instructions regarding, for example, how to loosen or tighten the fixing devices on the machine. Do not attempt to perform operations unless properly qualified and with suitable experience. If in need of assistance, call an authorised assistance centre.

TRANSPORT, STORAGE AND HANDLING

Conditions for transporting the machine

The tyre changer must be transported in its original packaging and stowed in the position shown on the packaging itself.

Pro Line 322

- Packaging dimensions:
 - width mm 990
 - depth mm 1115
 - height mm 1050
- Packaging weight kg 285

Pro Line 322 TI

- Packaging dimensions:
 - width mm 990
 - depth mm 1115
 - height mm 1050
- Packaging weight kg 295

Pro Line 122

- Packaging dimensions:
 - width 990 mm
 - depth mm 1115
 - height mm 1050
- Packaging weight kg 270

Pro Line 122 NORMAL

- Packaging dimensions:
 - width 990 mm
 - depth mm 1115
 - height mm 1050
- Packaging weight kg 260

Machine storage and **shipping specifications**

Temperature range: -25° - +55°C.

WARNING

Do not stack other goods on top of the packaging or damage may result.

Handling

To move the packed machine insert the forks of a fork-lift truck in the channels at the base of the pallet (fig.1).

Before moving the machine refer to the **HOISTING AND HANDLING** chapter.

WARNING

Keep the original packages for possible future transportation.

UNPACKING / ASSEMBLY

WARNING

Take utmost care when unpacking, assembling, hoisting and installing the machine as described in this heading.

Failure to observe these instructions can damage the machine and compromise the operator's safety.

- Remove the upper part of the packing and make sure that the machine has not suffered damage in transit; identify the points at which the machine is anchored to the pallet.

- The machine comprises the following main units (fig.1):

UK

Pro Line 322

- 1 body
- 2 tower
- 3 column guard
- 4 included
- 5 arm guard

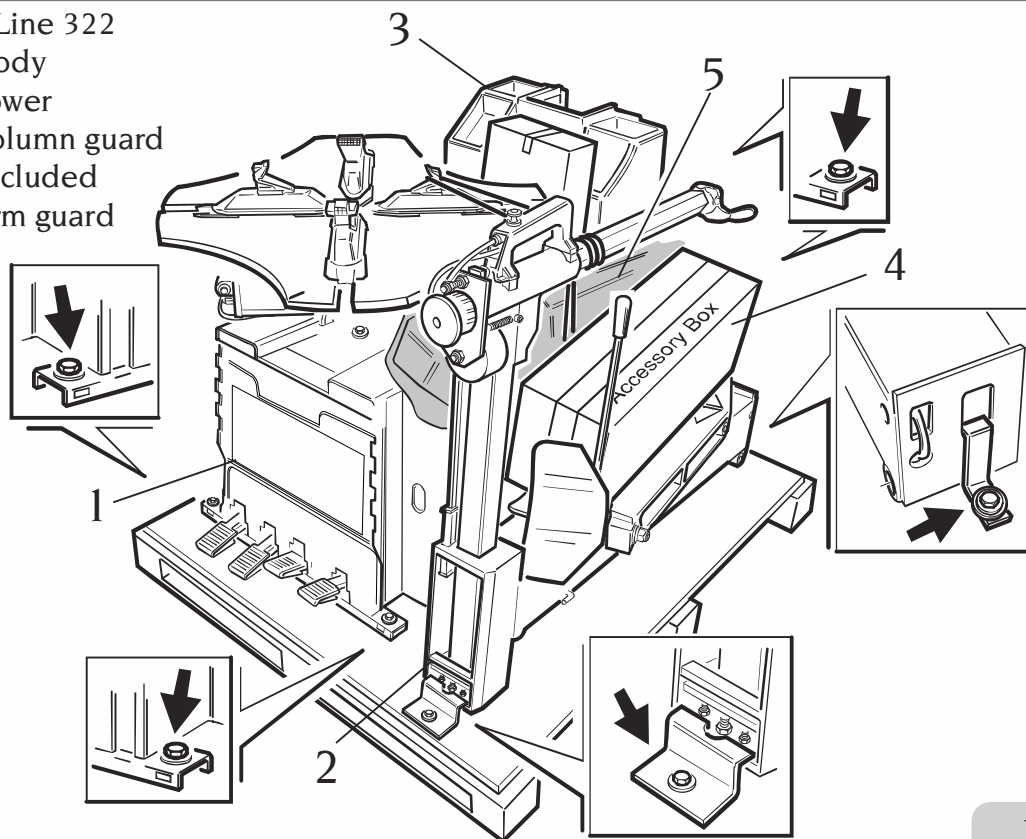

1

Pro Line 322 TI

- 1 body
- 2 tower
- 3 included
- 4 tank
- 5 tower guard
- 6 arm guard

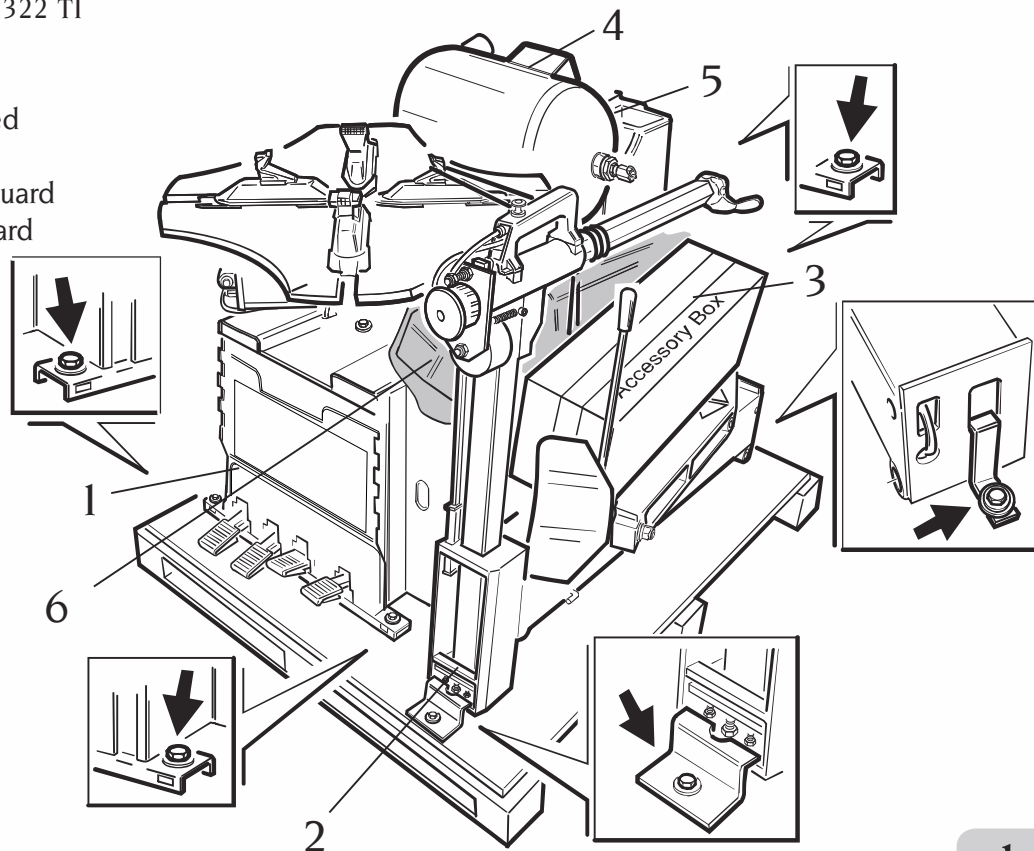

1

Pro Line 122 / 122N

- 1 body
- 2 tower
- 3 included

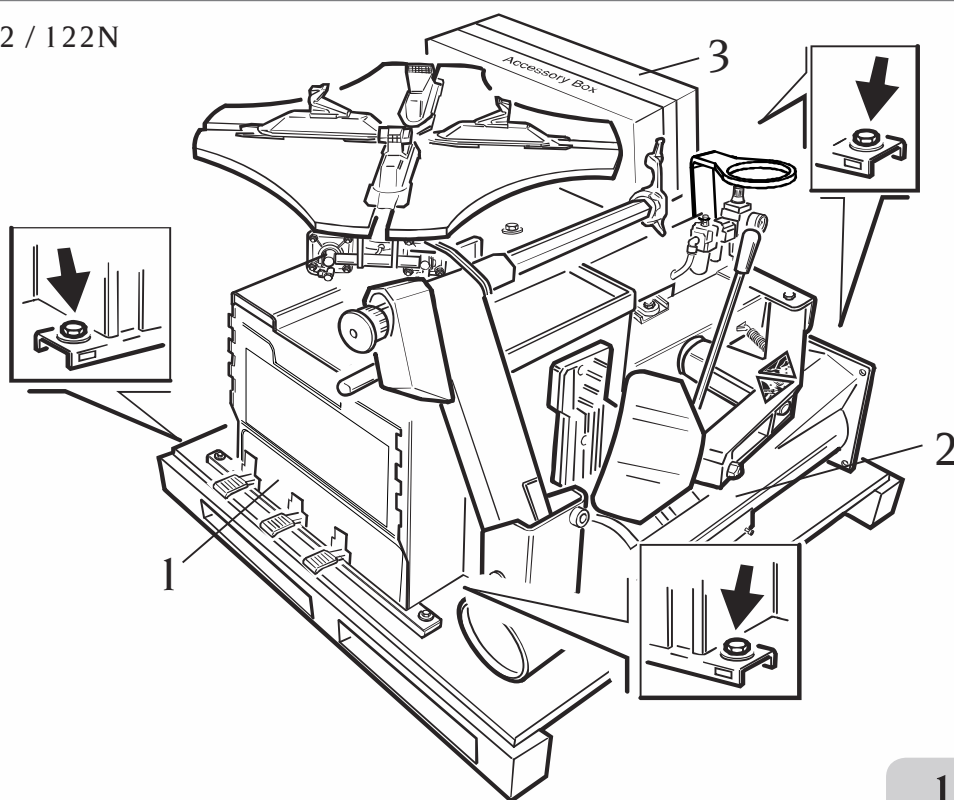

Pro Line 322- 322

- After removing the tower 2, preferably keep it in horizontal position to prevent it from falling and being damaged. (Fig. 1).
- Remove the side cover.
- Insert the air hose G (fig. 2) into the hole behind the column tilting cylinder.
- Assemble head 2, insert pin B into hole

C and lock it with the screw and washer D. (Fig. 2).

- Insert pin E into hole F and into the U-bolt A of the column tilting cylinder, and fasten with ring M (Fig. 2).
- Connect the hose G to the intermediate coupling (H). (Fig. 6).

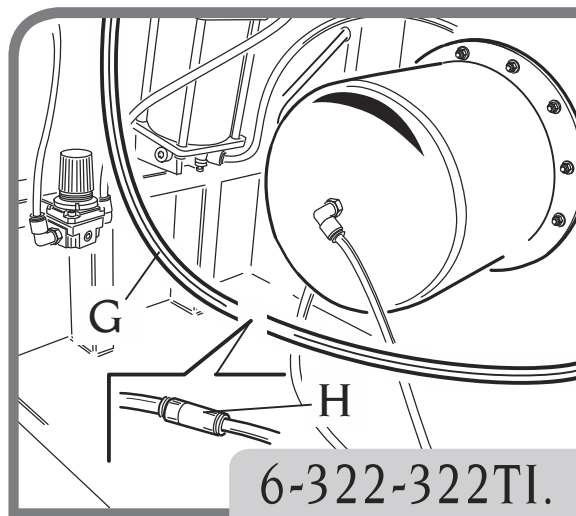
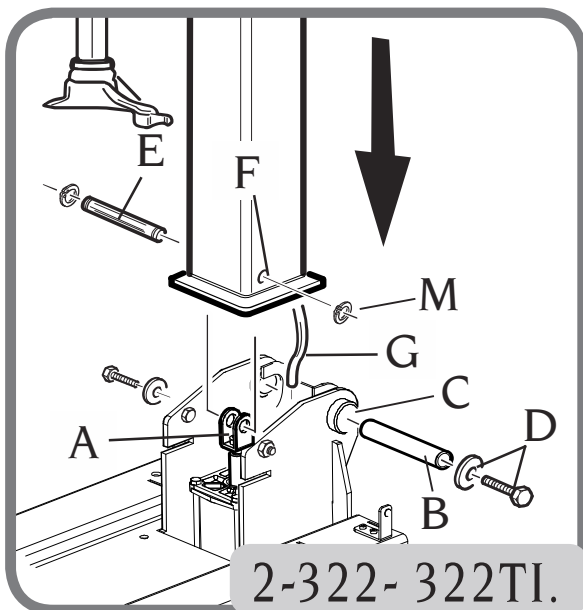

- Fit the arm guard 5. (Fig. 4).
- Fit the spring (1) and the knob (2); tighten the screw (3). (Fig. 4).

UK

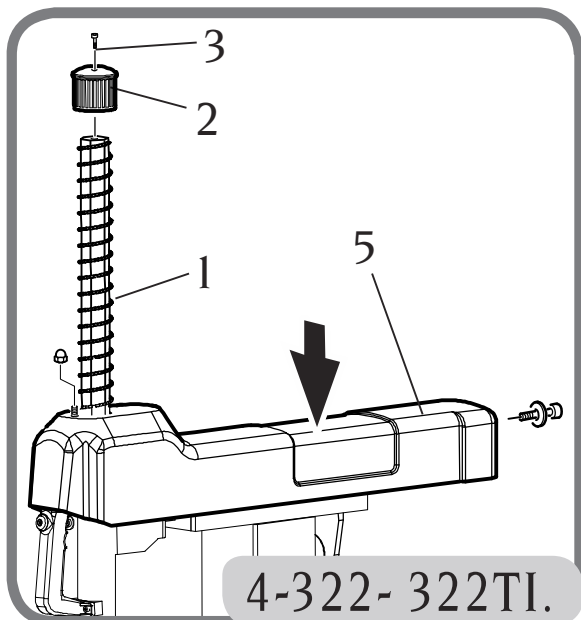

- Fit the column guard and fasten with the screws L (Fig. 3).

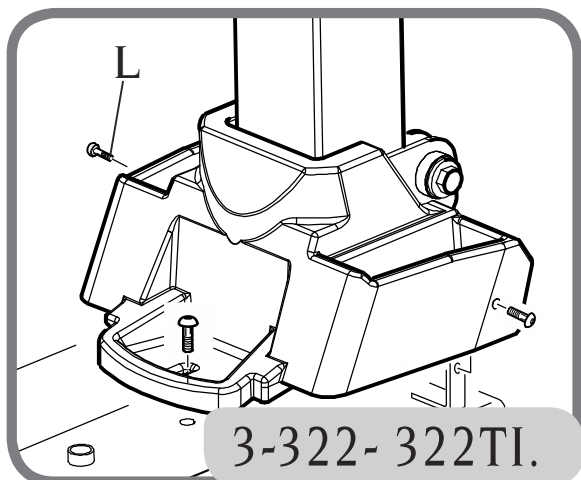

- Fit the grease container on the mounting (Fig.8).



- Refit the cover.

Pro Line 122 - 122 Normal

- After removing the tower 2, preferably keep it in horizontal position to prevent it from falling and being damaged. (Fig. 1).
- Remove the side cover.
- Fit the tower (Fig.3).

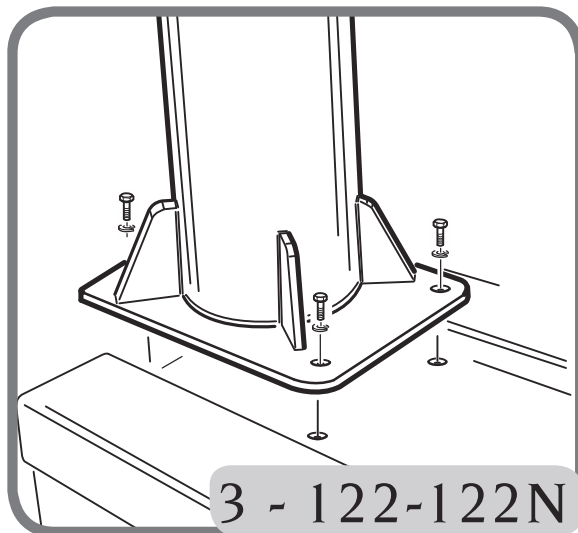

- Fit the spring (1) and the knob (2); tighten the screw (3). (Fig. 2).
- Fit the adjustment knob (4). (Fig. 2).
- Fit the box with pressure gauge (5) on the column. (Fig. 2) (ONLY PRO LINE 122).
- Fit the safety valve (6) (Fig. 2) (ONLY PRO LINE 122).

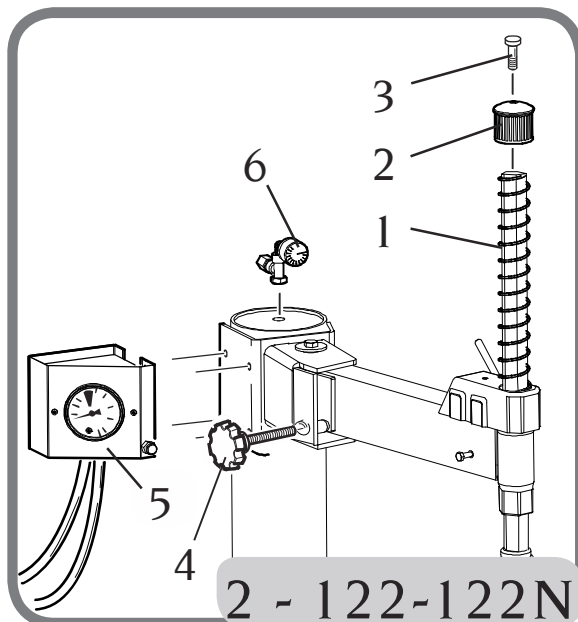

- Connect pipe G to the valve (Fig.4) (ONLY PRO LINE 122).

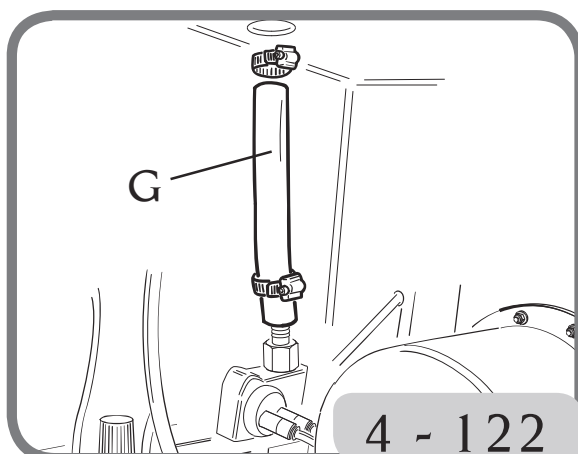

- Fit the grease container on the mounting (Fig.8).



- Refit the side cover

HOISTING

To remove the machine from the pallet, attach as shown in (Fig.7).

This lifting point must be used whenever you need to change the position of the machine.

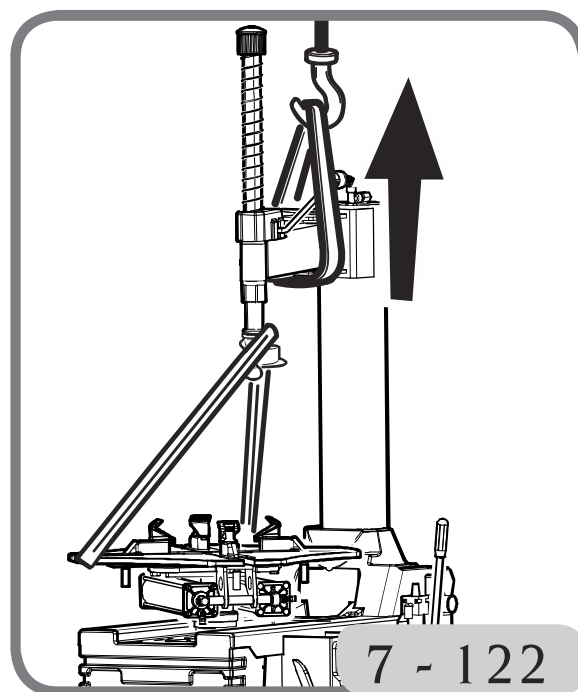
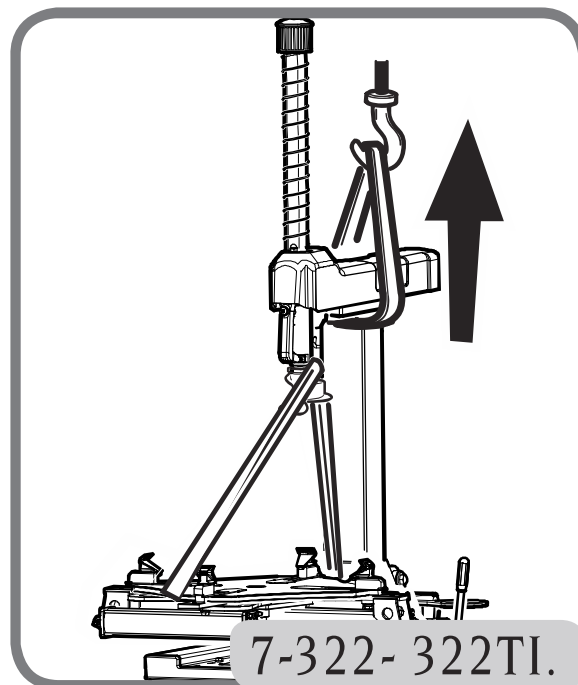

Do not attempt to move the machine until it has been disconnected from the electrical and air networks.

UK

CUSTOMISATION

Pro Line 322

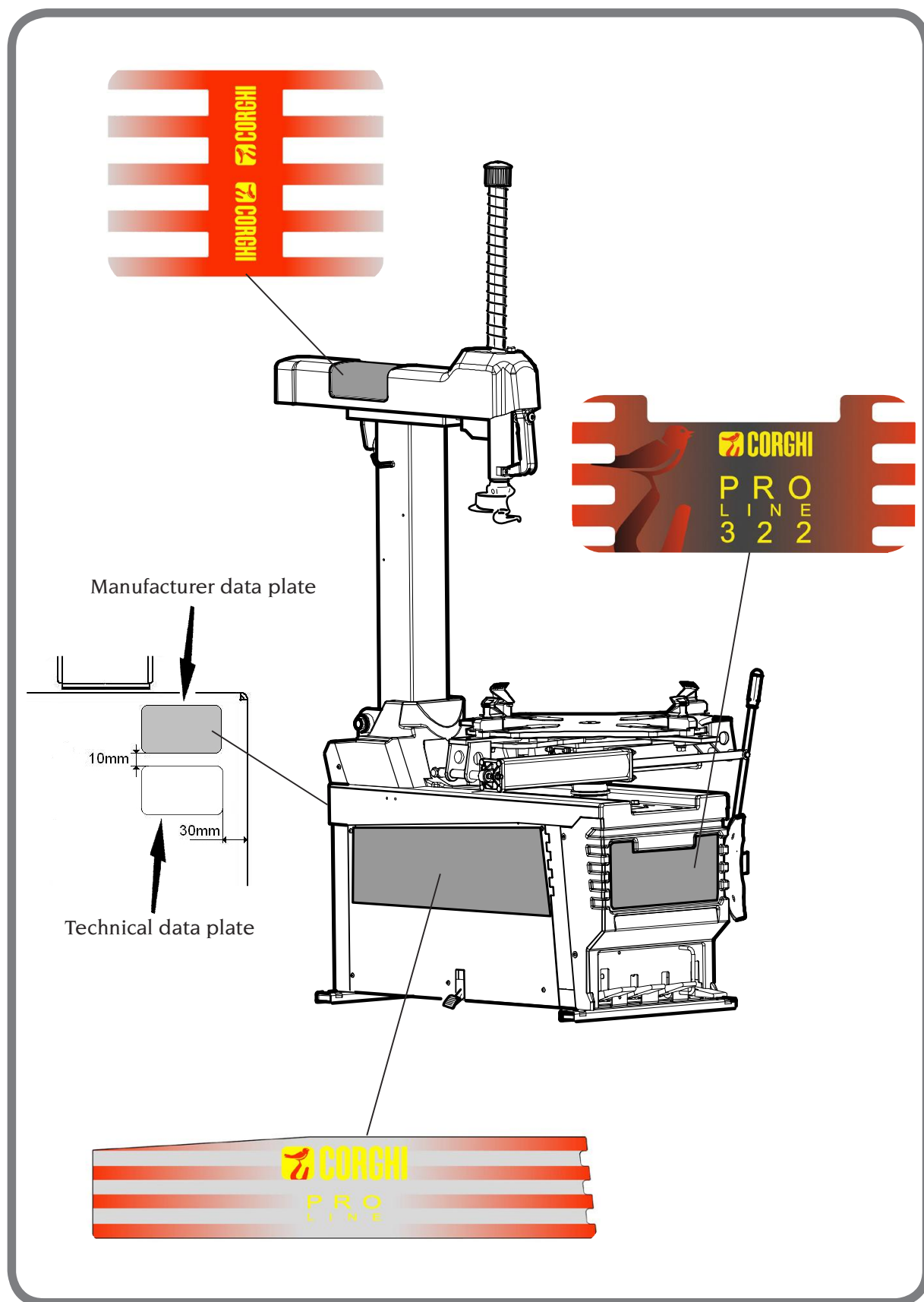

Pro Line 322 TI

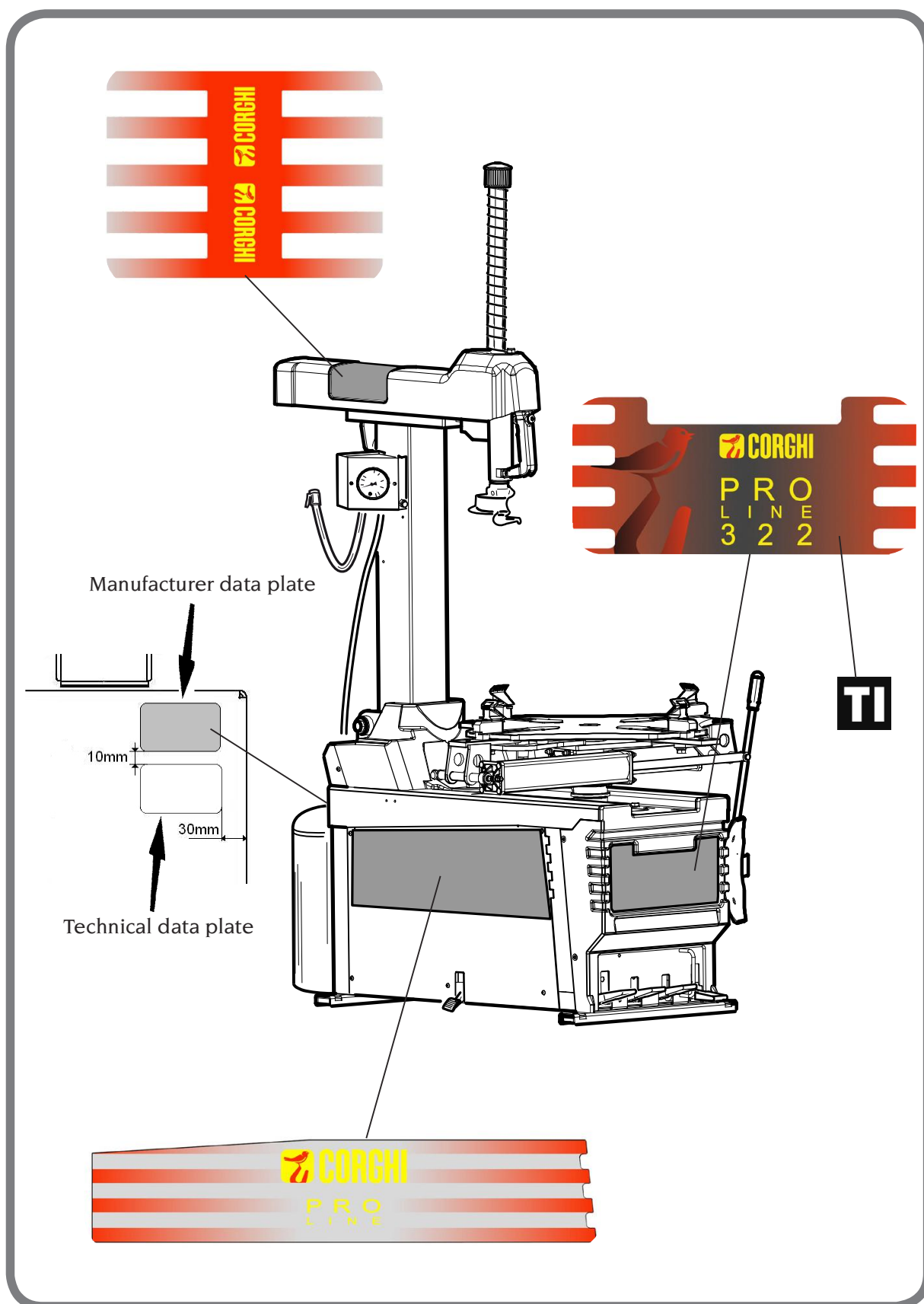

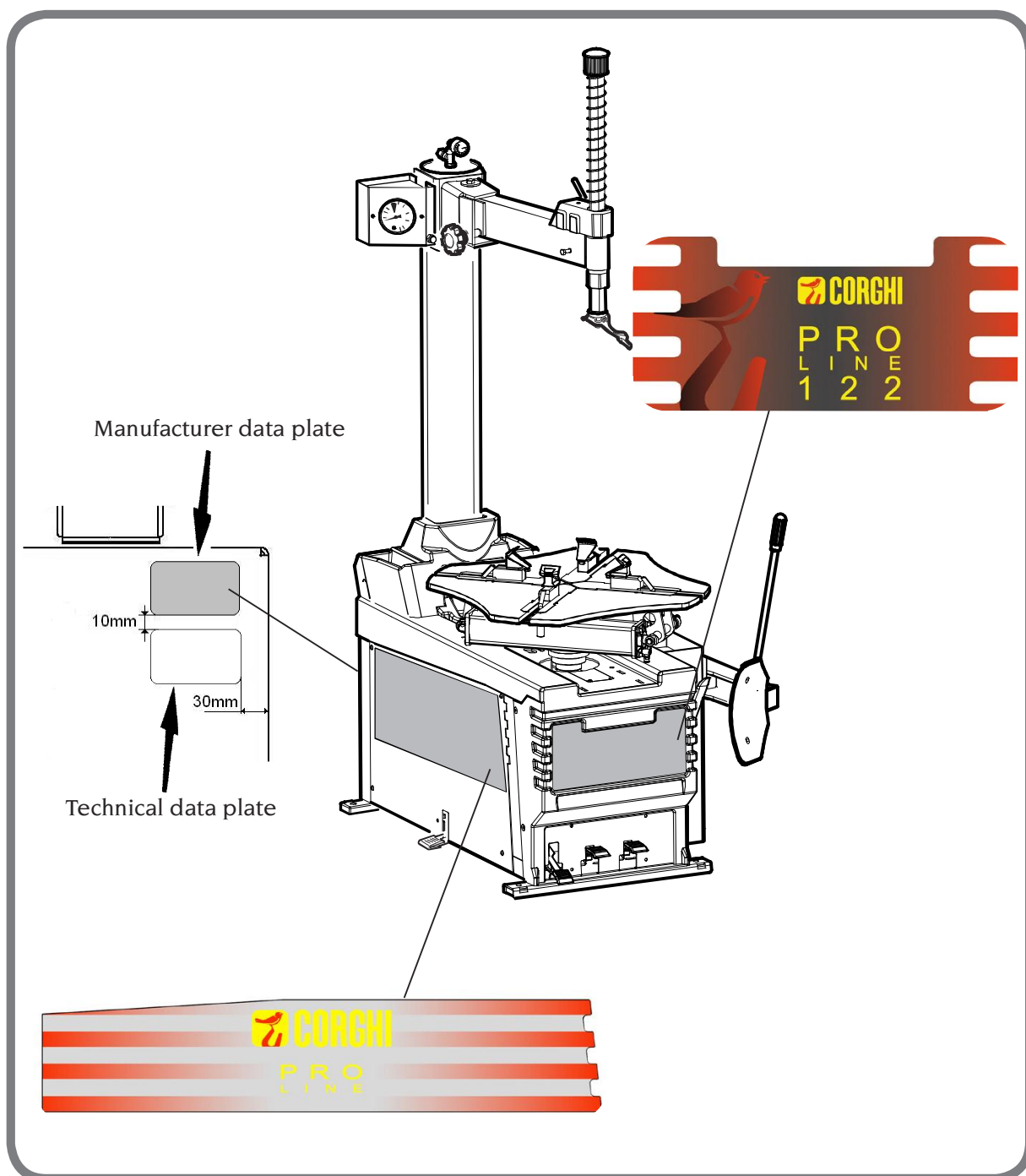

Pro Line 122 Normal

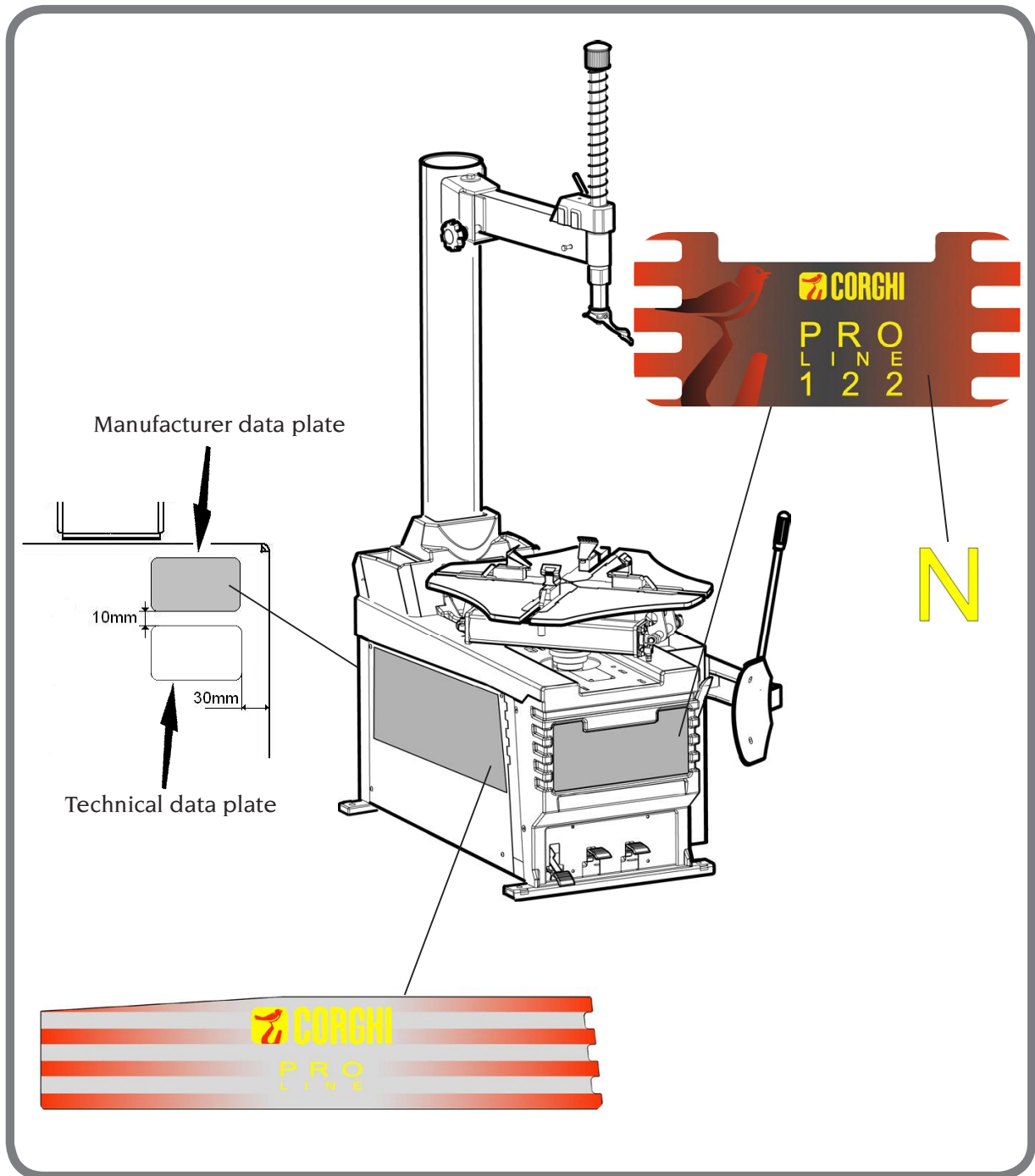

UK

INSTALLATION CLEARANCES

WARNING

Choose the place of installation in strict observance of local regulations regarding safety in the workplace.

IMPORTANT: for the correct and safe operation of the machine, the lighting level in the place of use should be at least 300 lux.

WARNING

If the machine is installed outdoors, it must be properly sheltered under a roof.

WARNING

The floor must be able to support a load equal to the sum of the weight of the equipment plus the maximum load allowed, taking into consideration also the resting base and any fixing means envisaged.

Install the tyre changer in the desired position, observing the minimum clearances indicated in fig.9.

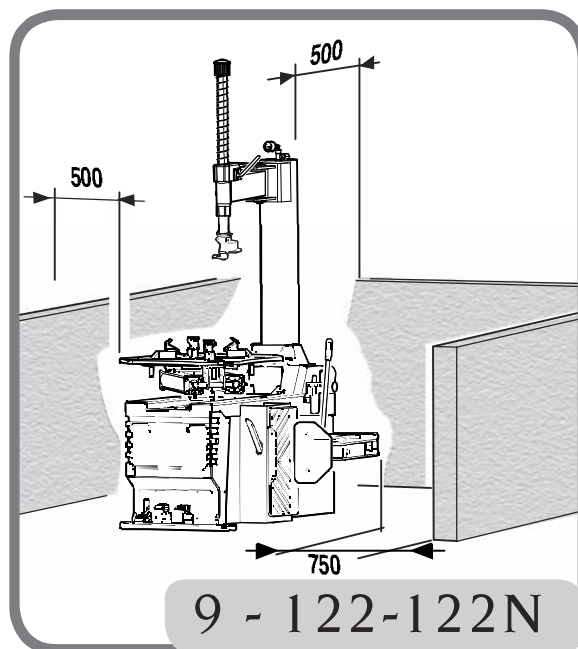
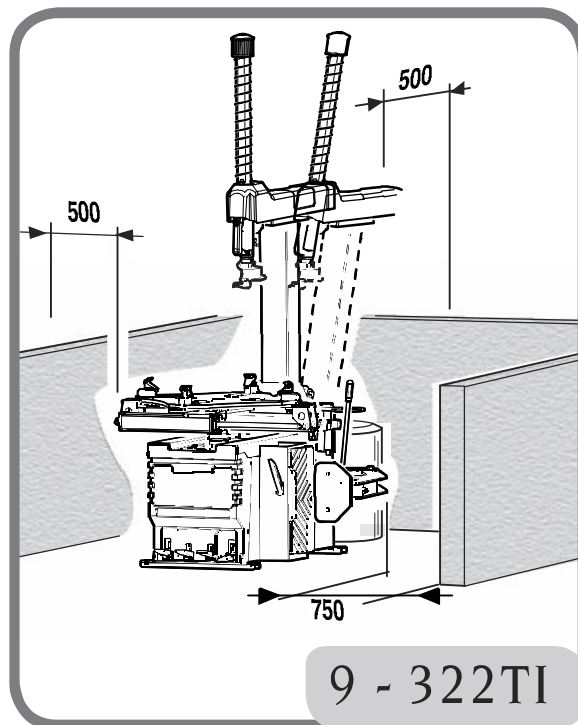
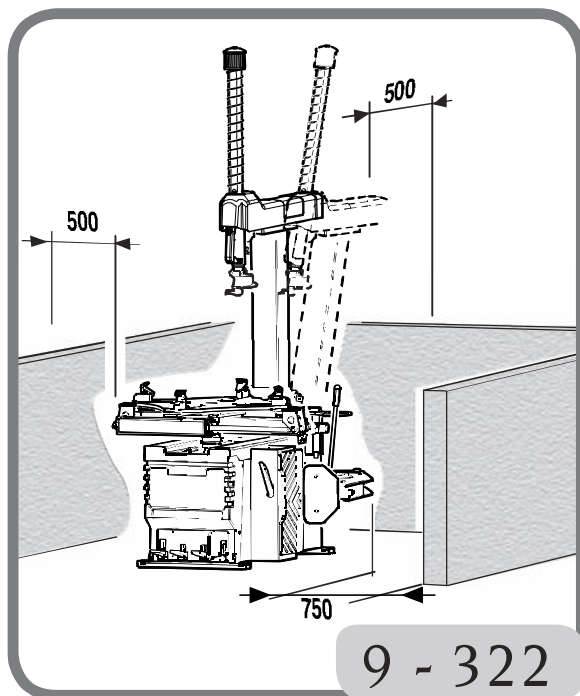

- Work environment conditions
- Relative humidity from 30% to 95% without condensation.
 - Temperature range from 0°C to 50°C.

WARNING

The machine must not be operated in a potentially explosive atmosphere.

ELECTRICAL AND PNEUMATIC CONNECTIONS

WARNING

Any operations to hook up to the electrical board of the workshop must only be carried **out by qualified personnel, in accordance** with the regulations of the current laws, and this is the duty and responsibility of the customer.

- The electrical hook-up must be performed according to:
 - absorbed power specifications indicated on the machine dataplate.
 - the distance between the machine and the power supply hook-up point, so that voltage drops under full load do not exceed 4% (10% during start-up) compared with the rated voltage specified on the data plate.
- The operator must:
 - a dedicated power plug in compliance with the relevant electrical safety standards;
 - a type A and B suitable differential circuit-breaker (residual current set to 30 mA) on the mains connection;
WARNING: only a type A and B differential security breaker of the specified kind will be tripped correctly in response to all the failure currents which may occur on the machine.
 - mount power line protection fuses, suitably sized according to the specifications indicated on the main wiring diagram contained in this manual;
 - a suitable earthing system installed on the workshop mains line.
- Prevent unauthorised use of the machine, always disconnect the power supply plug when the machine is not used (switched off) for extended periods of time.
- If the machine is connected directly to the power supply by means of the main electrical panel and without the use of a

plug, install a key-operated switch or suitable lock-out device to restrict machine use exclusively to qualified personnel.

For the correct operation of the machine the compressed air supply line must provide a pressure range from a minimum of 8 bar to a maximum of 12 bar.

NOTE

The machine is equipped with a pressure regulator set at 10 bar (standard machine operation). If you are working with easily deformable rims (motor cycle wheels for example) we recommend lowering the pressure temporarily to 7 or 8 bar.

WARNING

For the correct functioning of the machine it is vital to have a good ground connection.

NEVER connect the grounding line to gas or water lines, to telephone wires, or to other non-suitable objects.

For Pro Line 322 - 322TI only

Before making the electrical and pneumatic hook-ups, make sure that the machine is configured as described below (fig.14):

- pedals, indicated by the arrows, in fully depressed position
- column vertical (not tilted).

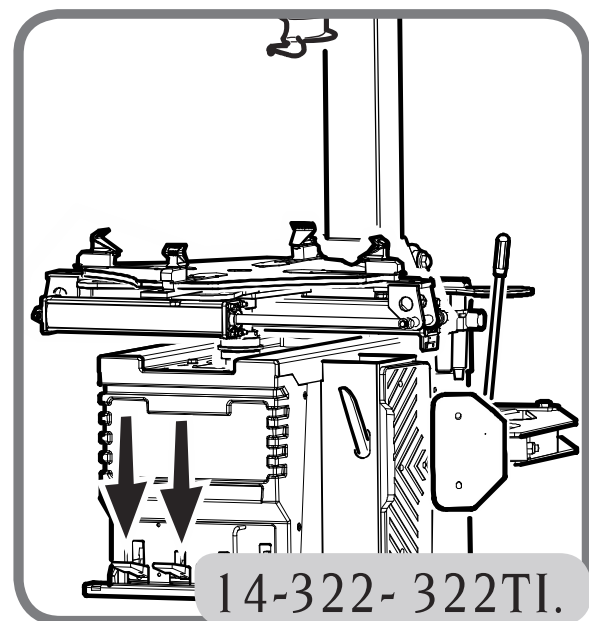

UK

SAFETY REGULATIONS



WARNING

Failure to comply with the instructions and danger warnings can cause serious injuries to the operator or other persons. Do not operate the machine until you have read and understood all the danger/warning notices in this manual.

In order to operate the machine correctly, it is necessary to be a qualified and authorised operator, able to be trained and to know the safety regulations. Operators are expressly forbidden from using the machine under the influence of alcohol or drugs capable of affecting physical and mental capacity.

The following conditions are essential:

- read and understand the information and instructions described in this manual;
- have a thorough knowledge of the features and characteristics of the machine;
- keep unauthorised persons well clear of the working area;
- make sure that the machine has been installed in compliance with all relevant standards and regulations in force;
- Make sure that all machine operators are suitably trained, that they are capable of using the machine correctly and safely and that they are adequately supervised during work;
- do not touch power lines or the inside of electric motors or other electrical equipment before making sure that they have been powered off;
- read this booklet carefully and learn how to use the machine correctly and safely;
- always keep this user manual in a place where it can be readily consulted and do not fail to refer to it.



WARNING

Do not remove or deface the DANGER, WARNING, CAUTION or INSTRUCTION decals. Replace any missing or illegible decals. If one or more decals have been detached or damaged, replacements can be obtained from your nearest dealer.

- When using and carrying out maintenance on the machine, observe the unified industrial accident prevention regulations for high voltage industrial equipment and rotating machinery.
- Any unauthorised changes or modifications made to the machine shall automatically release the manufacturer from any liability for damage or accidents attributable to such alterations. Specifically, tampering with or removal of the machine safety devices is a breach of the regulations relating to Safety at work.



WARNING

During work and maintenance operations, always tie back long hair and do not wear loose clothing, ties, necklaces, wristwatches or any other items that may get caught up in the moving parts.

TYRE CHANGER DESCRIPTION

The Pro Line 322, 322 TI, 122 and 122 Normal are electro-pneumatic tyre changers. These tyre changer models are designed to mount and demount tyres on all types of integral wheels with drop centre and weights and dimensions as described in the TECHNICAL BRIEF section.

The machine is solidly constructed. It operates with the wheel in a vertical position for bead breaking and a horizontal position for mounting and demounting tyres. All machine movements are controlled by the operator by means of the pedals.

TECHNICAL DATA

Pro Line 322- 322

- Turntable clamping capacity:
 - internal clamping 12" to 24"
 - external clamping..... 10" to 22"
- Bead breaking pressure..... 12000 N (at 10 bar)
- Bead breaker opening 400 mm
- Max. tyre diameter 1140 mm (44.5")
- Max. tyre width 350 mm (14")
- Air pressure 8 - 10 bar
- Power supply voltage
 - Single-phase motor 115/230 10% Volt 50/60 Hz
 - three-phase..... 400 10% Volt 50/60 Hz

Model	Motor rating	kW	Rotation speed rpm	Torque Nm	Weight of electric/ electronic part kg
Pro Line 322 322 TI	400 Volt 3 ph 50 Hz	0,75	7,5	1100	11,5
	200-230 Volt 3 ph 50 Hz	0,75	7,5	1100	11,5
	200-230 Volt 3 ph 60 Hz	0,75	7,5	1100	11,5
	200/230 Volt 1 ph 50 Hz	0,75	7,5	1100	11,5
	200/230 Volt 1 ph 60 Hz	0,75	7,5	1100	11,5
	115 Volt 1 ph 60 Hz	1,1	6	1000	11,5

UK

- Weight.....255 Kg (Pro Line 322) -265 Kg (Pro Line 322 TI)
- Machine dimensions (Fig.10)
- Noise level in operating conditions< 70 dB (A)

Pro Line 122

- Turntable clamping capacity:
 - internal clamping 12" to 24"
 - external clamping..... 10" to 22"
- Bead breaking pressure 12000 N (at 10 bar)
- Bead breaker opening 400 mm
- Max. tyre diameter 1140 mm (44.5")
- Max. tyre width 350 mm (14")
- Air pressure 8 - 10 bar

- Power supply voltage

- Single-phase motor 115/230 10% Volt 50/60 Hz
- three-phase..... 230/400 10% Volt 50/60Hz

Model	Motor rating	kW	Rotation speed rpm	Torque Nm	Weight of electric/ electronic part kg
Pro Line 122 - 122 Normal	400 Volt 3 ph 50 Hz	0,75	7,5	1100	11,5
	200-230 Volt 3 ph 50 Hz	0,75	7,5	1100	11,5
	200-230 Volt 3 ph 60 Hz	0,75	7,5	1100	11,5
	200/230 Volt 1 ph 50 Hz	0,75	7,5	1100	11,5
	200/230 Volt 1 ph 60 Hz	0,75	7,5	1100	11,5
	115 Volt 1 ph 60 Hz	1,1	6	1000	11,5

- Weight:..... 230 kg (Pro Line 122) -225 kg (Pro Line 122 N)

- Machine dimensions (Fig.10)

- Noise level in operating conditions< 70 dB (A)

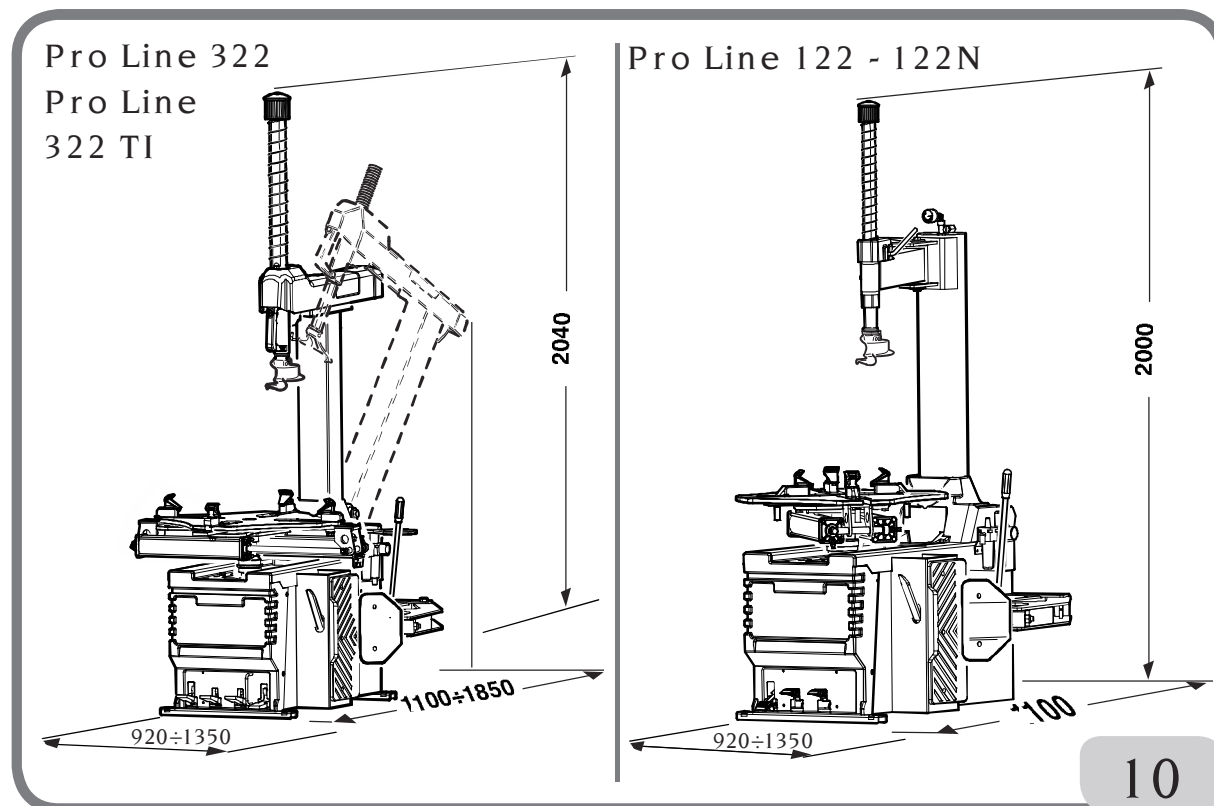

INTENDED OPERATING CONDITIONS

The Pro Line 322, 322 TI, 122 and 122 Normal tyre changers are designed exclusively for mounting and demounting tyres, using the tools the machines are equipped with in accordance with the instructions in this manual.

WARNING

Any use other than those described in this manual is to be considered improper and unreasonable.

The 322 TI and 122 machines are equipped with an inflation system that operates independently of the other functions described above. The 322 and 122N, on the other hand, are equipped solely with a connector for an inflating gun (INFLATING GUN NOT SUPPLIED TOGETHER WITH MACHINE). Take great care when using it (read the INFLATION chapter).

WARNING

You are strongly advised not to use non-original equipment or tools.

Figure 10A shows the operator's working positions at the different working stages:

- A Bead breaking
- B Tyre demounting and mounting
- C Inflation area.

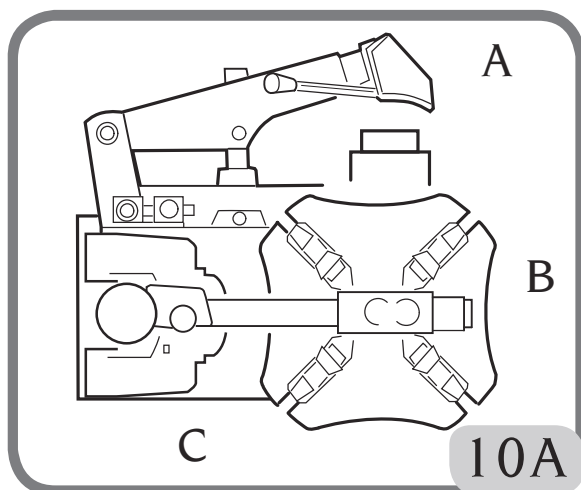

MAIN WORKING ELEMENTS OF THE MACHINE

WARNING

Get to know your machine: your familiarity with its exact operation is the best guarantee of safety and performance.

Learn the function and location of all controls. Carefully check that all the commands on the machine are working properly. To avoid accidents and injury, the machine must be installed properly, operated correctly and serviced regularly.

Pro Line 322- 322TI (Fig. 11)

- 1 Arm clamp/release button.
- 2 Vertical and horizontal arm (to position the mounting/ demounting tool).
- 3 Mounting/ demounting tool (to mount and demount the tyre from the rim).
- 4 Tilting movable column.
- 5 Clamp gripper (secures the rim to the turntable).
- 6 Turntable (rotary platform supporting the wheel).
- 7 Movable column control pedal (4) (two-position pedal for tilting the column unit).
- 8 Clamp grippers (5) opening and closing control pedal (three-position pedal for opening and closing rim clamps).
- 9 Bead breaker control pedal (two-position pedal to operate the bead breaker shoe (11)).
- 10 Turntable (6) rotation control pedal (three-position pedal):
 - position 0: table stop (stationary)
 - Pressed down (Unstable position) clockwise rotation.
 - Lifted (Unstable position) anti-clockwise rotation.

UK

- 11 Bead breaker shoe (movable shoe to detach the bead from the rim).
- 12 Rim support.
- 13 FilterRegulator+LubricatorUnit (regulates pressure, filters, removes humidity of and lubricates the compressed air supply).
- 14 Pressure gauge (reads tyre pressure) (Pro Line 322 TI only)
- 15 Bead lifting lever (raises and positions the tyre bead on the mounting/demounting tool).
- 16 Connector for inflation gun (not supplied with machine)

- 17 Air tank with safety valve (Pro Line 322 TI only).
- 18 Doyfe inflator chuck (clips on to the tyre valve for inflation).
- 19 Inflation nozzles (air introduced through the nozzle pushes the tyre bead outward out, forming a seal and permitting inflation) (Pro Line 322 TI only)
- 20 Inflation pedal (three-position pedal for inflating tyre through the Doyfe connector) (Pro Line 322 TI only).

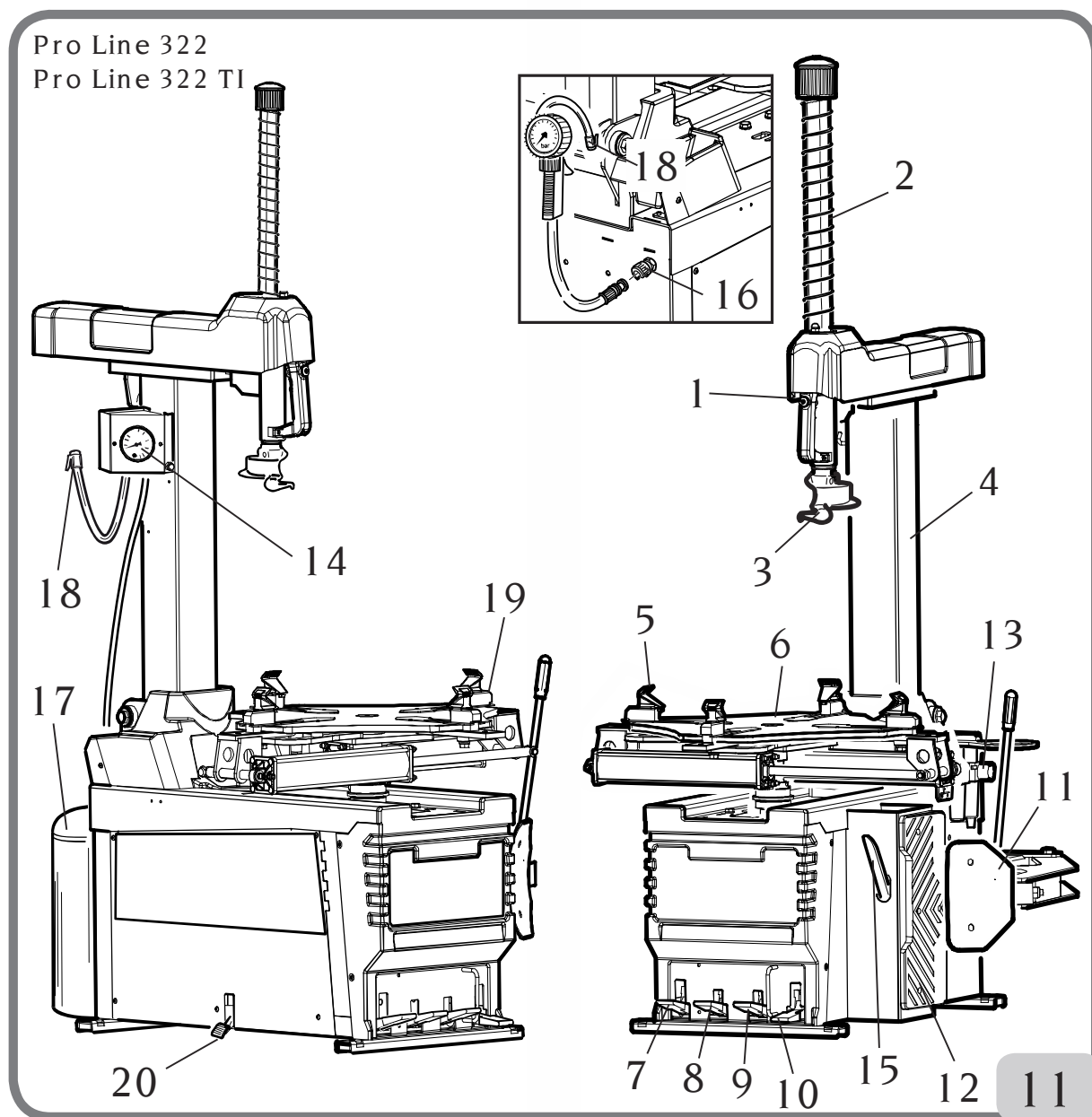

Pro Line 122 - 122 Normal (Fig. 12)

- 1 Arm clamp/release lever.
- 2 Vertical arm (to position the mounting/demounting tool).
- 3 Mounting/ demounting tool (to mount and demount the tyre from the rim).
- 4 Inflation pedal (three-position pedal to inflate the wheel through the Doyfe inflator chuck) (only Pro Line 122).
- 5 Clamp gripper (secures the rim to the turntable).
- 6 Turntable (rotary platform supporting the wheel).
- 7 Deflation push-button (button to remove the extra air inside the wheel) (only Pro Line 122).
- 8 Clamp grippers (5) opening and closing control pedal (three-position pedal for

opening/closing rim clamps).

- 9 Bead breaker control pedal (two-position pedal to operate the bead breaker shoe (11)).
- 10 Turntable (6) rotation control pedal (three-position pedal):
 - position 0: table stop (stationary)
 - Pressed down (Unstable position) clockwise rotation.
 - Lifted (Unstable position) anticlockwise rotation.
- 11 Bead breaker shoe (movable shoe to detach the bead from the rim).
- 12 Rim support
- 13 FilterRegulator+LubricatorUnit (regulates pressure, filters, removes humidity of and lubricates the compressed air supply).
- 14 Adjustment knob

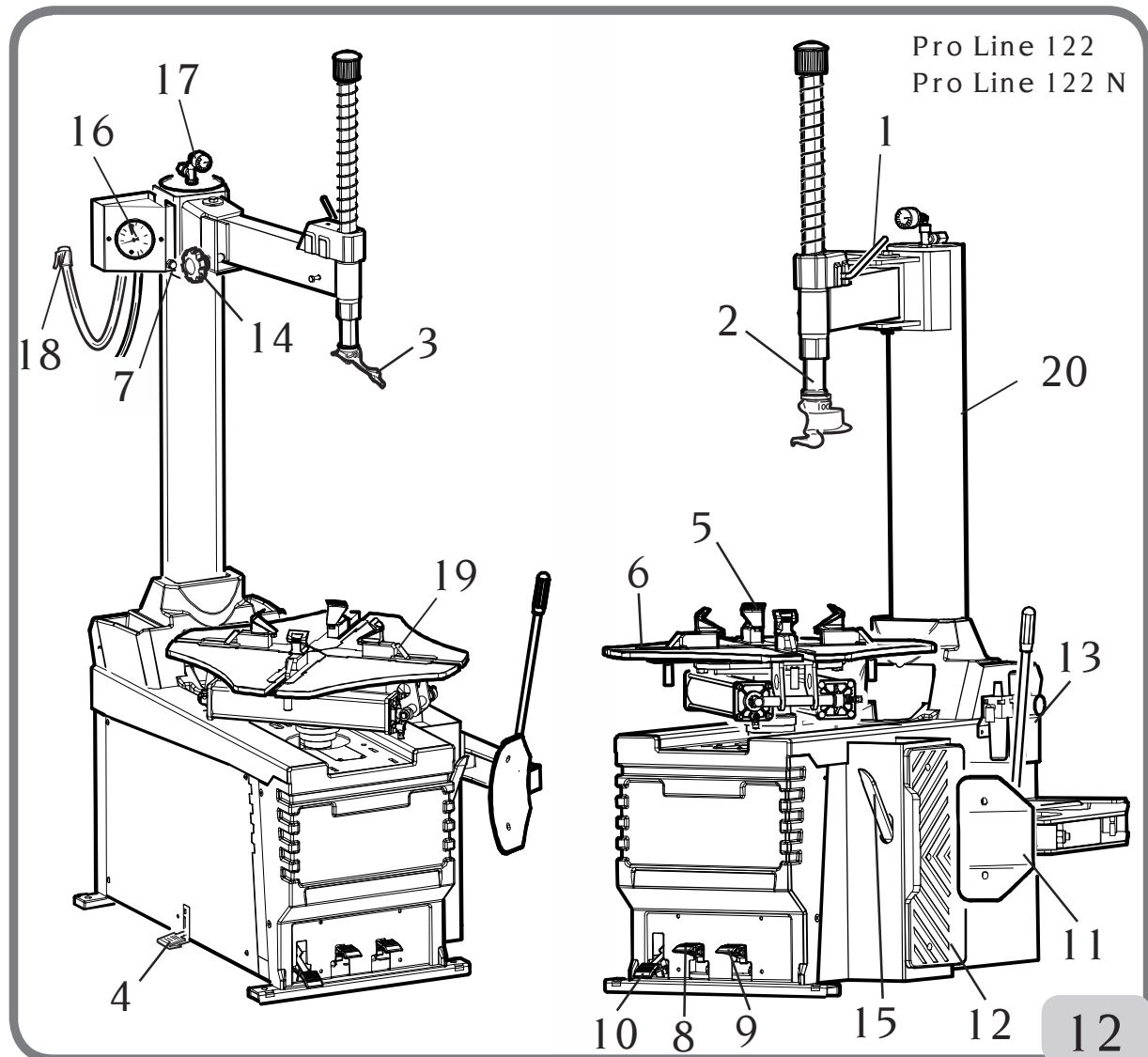

UK

- 15 Bead lifting lever (raises and positions the tyre bead on the mounting/demounting tool).
- 16 Pressure gauge (reads the wheel pressure) (only Pro Line 122)
- 17 Safety relief valve (max. pressure 12 bar) (only Pro Line 122).
- 18 Doyfe inflator chuck (clips on to the tyre valve for inflation) (only Pro Line 122).
- 19 Inflation nozzles (through these nozzles, an air jet makes tyre beads expand for sealing and for enabling inflation) (only Pro Line 122)
- 20 Column (with internal air tank on Pro line 122).

WARNING AND INSTRUCTION DECALS APPLIED ON THE MACHINE



Risk of crushing.
Never insert body parts
between the bead breaking
shoe, rim and rim rest.



When locking the rim on the
turntable, never insert your
hands between the rim and
the clamp gripper.



NEVER stand behind the
machine.



NEVER insert your hands
between the wheel and the
head when lowering the
head.



To protect the eyes, operators
should wear protective goggles
when tyres are being inflated
using the machine equipped with
the GT system.



Never place your hands between
the rim and the tyre when the tyre
is being inflated in order to avoid
any injury to operators.

INSTRUCTIONS FOR USE

Only trained technicians can operate the machine.

BEAD BREAKING



WARNING

This operating phase may involve noise levels of 85 dB (A).
Wearing ear defenders is recommended.

Deciding from which side of the wheel the tyre must be demounted

(Fig. 16)

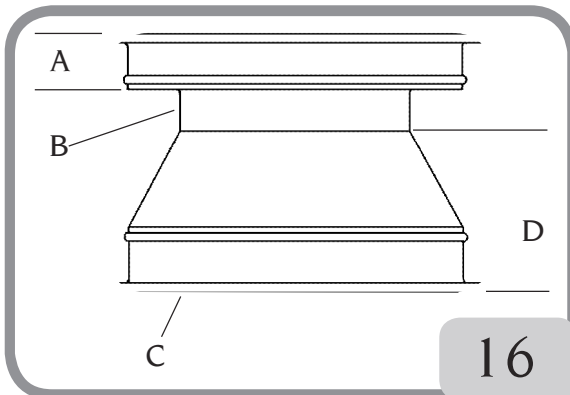

- A Narrow side - Side for mounting the tyre
- B Rim well
- C Wheel
- D Wider side - You cannot mount tyres from this side

The two sides may be almost identical, but only the narrow side serves for tyre mounting and demounting

Identify the side for tyre mounting and make sure that this side is facing upward when you install the tyre on the table top (i.e. facing toward the mount/demount head)

Special instructions

Alloy wheels

Some alloy wheels on the market have minimal rim wells or are even completely without rim wells (these wheels are not DOT approved).

Fig.16a

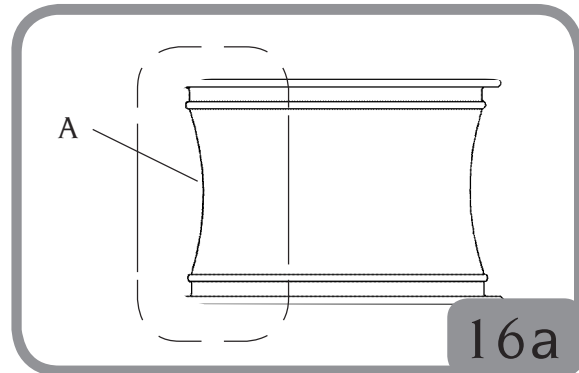

- A No rim well



DANGER

When working on this tyre type, the tyre, the rim or both may get damaged, with the risk of the tyre exploding due to pressure causing serious injuries or even death. When mounting tyres on this type of wheel, use the utmost caution.

European style high performance wheels (asymmetrical curvature)

Certain European wheels feature a very pronounced curvature that continues around the entire circumference of the wheel, with the exception of the area near the valve hole. On this type of wheel, bead breaking must be performed near the valve hole, on both the lower and upper sides of the wheel.

Fig.16b

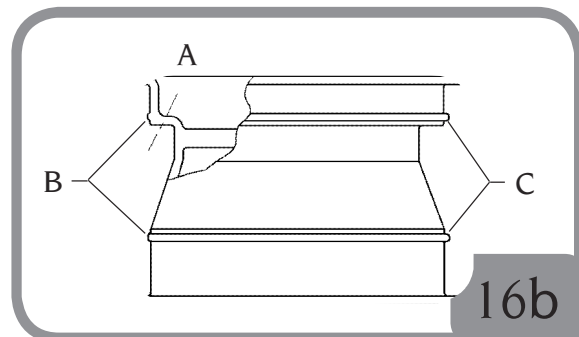

- A Valve hole
- B Slight curvature
- C Pronounced curvature

UK

Wheels for Corvette, BMW, Lamborghini and other wheels with "Low pressure indicator system"

Some types of high performance wheels are equipped with a pressure transmitter secured to the rim with a belt on the side opposite the valve hole. On this type of wheel bead breaking must be done initially in correspondence with the valve hole, on both sides of the rim.

Fig.16b

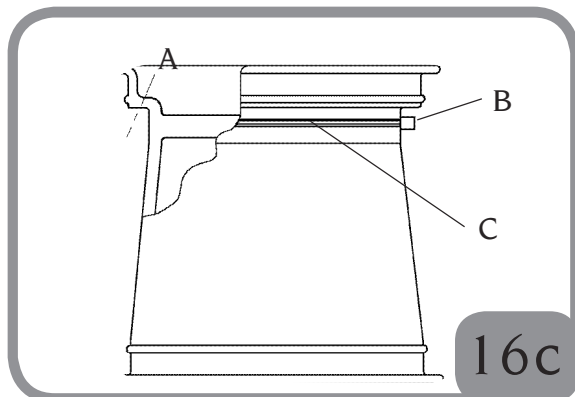

- A Valve hole
- B Transmitter
- C Attachment belt

Bead breaking

- Fully deflate the tyre, removing the valve

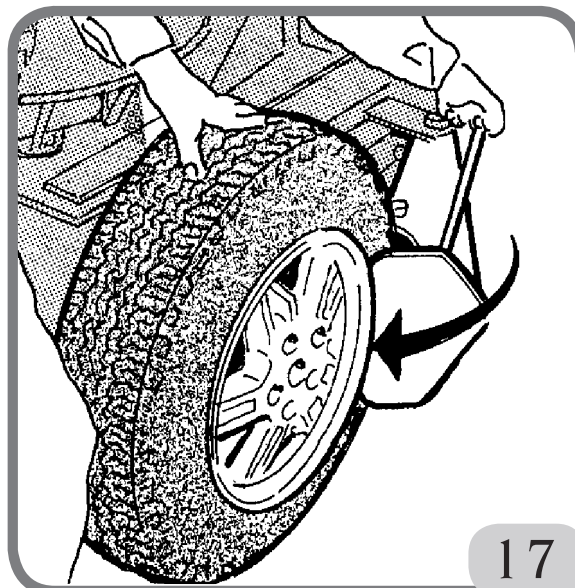

- Position the wheel as shown in fig.17 and

bring the bead breaker shoe to the edge of the rim.

IMPORTANT: Preferably keep the turntable closed (clamp gripper towards the centre) during bead breaking (Fig.17a).

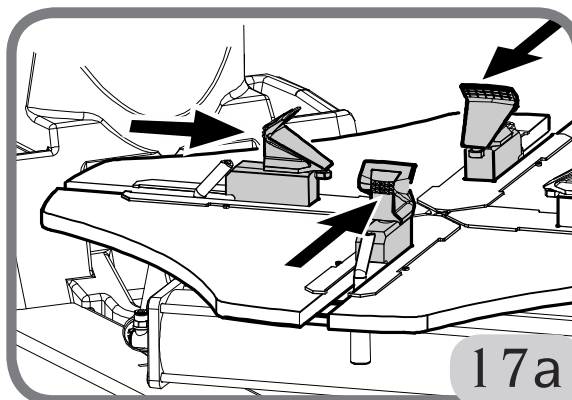

- Press the pedal (Fig.17b) to operate the bead breaker and detach the bead from the rim.

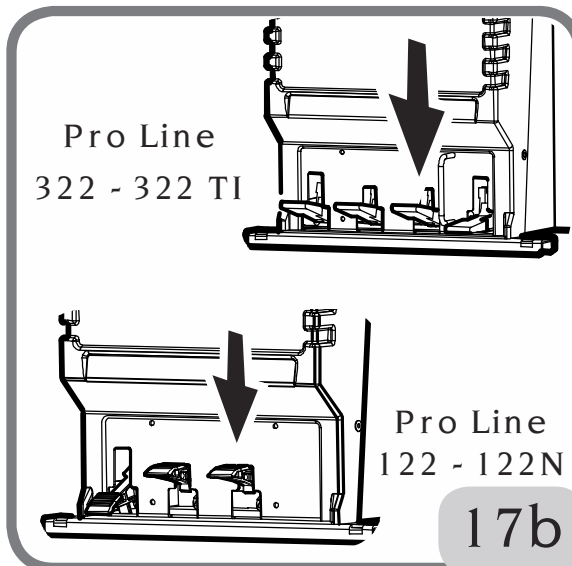

Repeat this operation on the other side of the wheel.

It may be necessary to break the bead at several points to free it completely.

PNEUMATIC DEMOUNTING

After detaching the beads, remove the old balancing weights.

- Thoroughly lubricate the sides of the tyre around the entire circumference of the lower and upper bead to facilitate demounting and avoid damaging the beads.
- Tilt the column backwards while holding the button in the "clamped" position (Pro Line 322 - 322 TI)(Fig.19) and move the arm away (Pro Line 122 - 122N)(Fig.20).

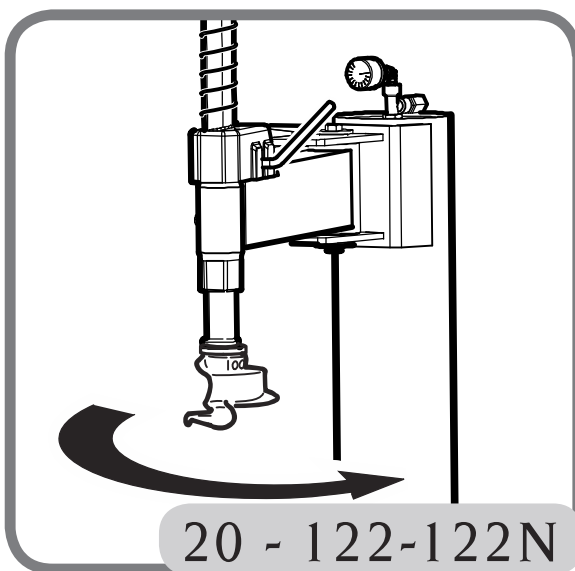
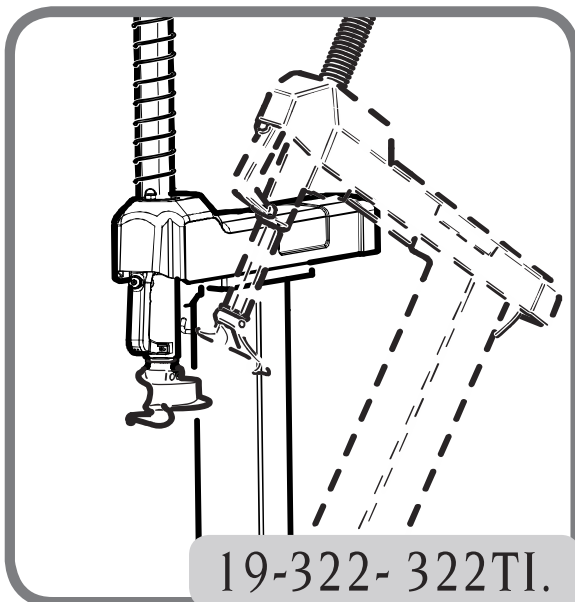

- Place the grippers in open or closed position.

Place the wheel on the turntable (with the narrow part of the rim structure facing upwards), push lightly downwards and use the control pedal to lock the wheel in position (fig.21).

Pro Line
322 - 322 TI

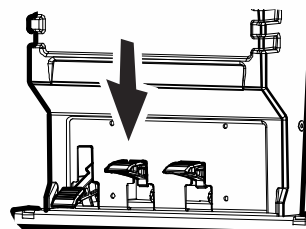
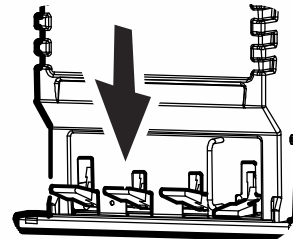

Pro Line
122 - 122N

21

- Move the column forward again (Pro Line 322 - 322 TI, Fig.19) or bring the arm closer (Pro Line 122 - 122N, fig.20).
- Release the clamp button (Pro Line 322 - 322 TI, Fig.22) or release the lever (Proline 122 - 122N, fig.22a) to free the arms and bring the mounting/demounting device into the correct position against the wheel rim (Fig.23)

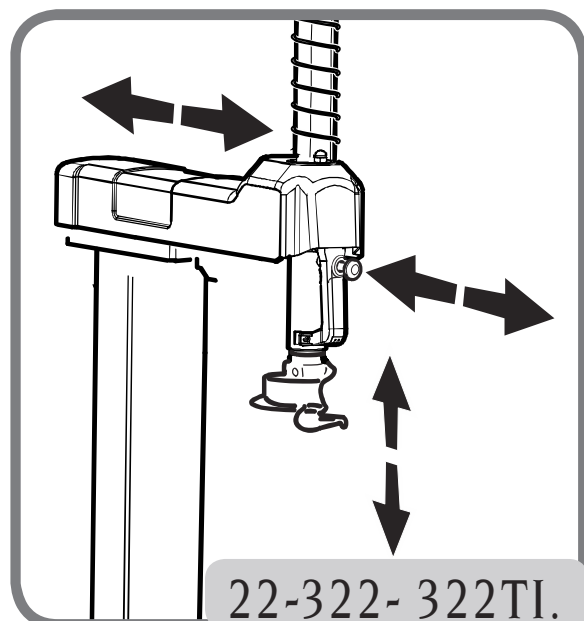

UK

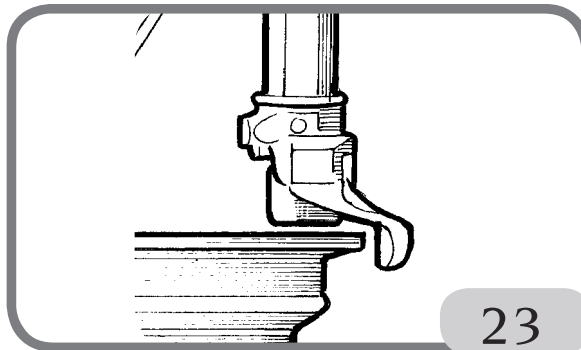
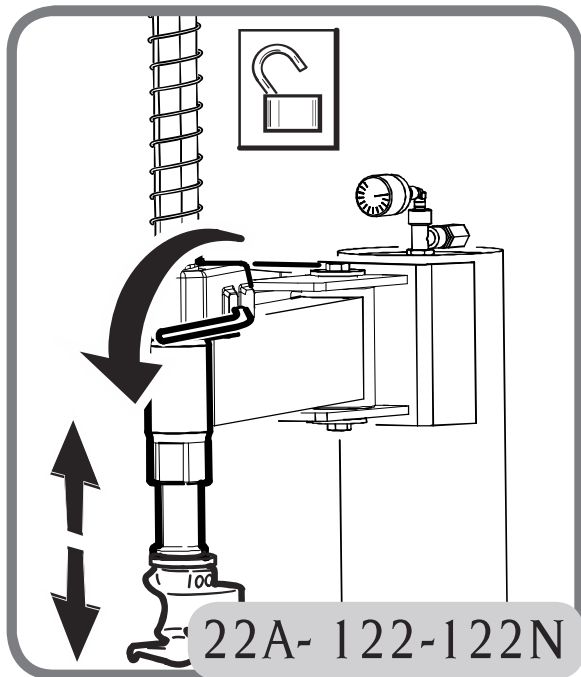

IMPORTANT: when the button is pressed (Pro Line 322 - 322 TI, Fig.22), both the vertical and horizontal arms are clamped simultaneously, while the mounting/demounting head rises slightly, moving away from the rim edge (fig.22). On the Pro Line 122 - 122N, turn the lever to clamp the vertical arm (Fig. 22a) and use the knob to adjust the horizontal position (Fig. 25).

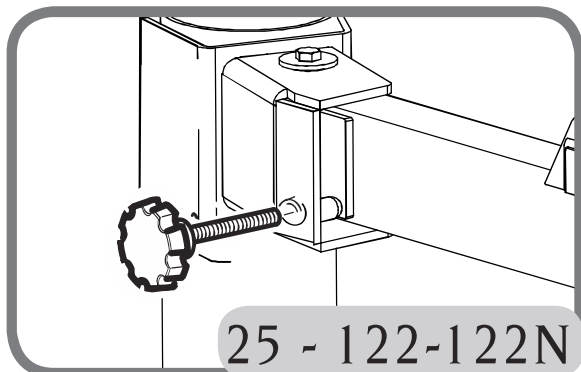

This space between the rim and the vertical slide will be maintained for as long as the button is in the locking position.

The operator can tilt the tower freely (e.g. when demounting wheels of the same size) without repositioning the vertical slide.

- Insert and position the bead lifting tool on the mounting vertical slide (fig.26).

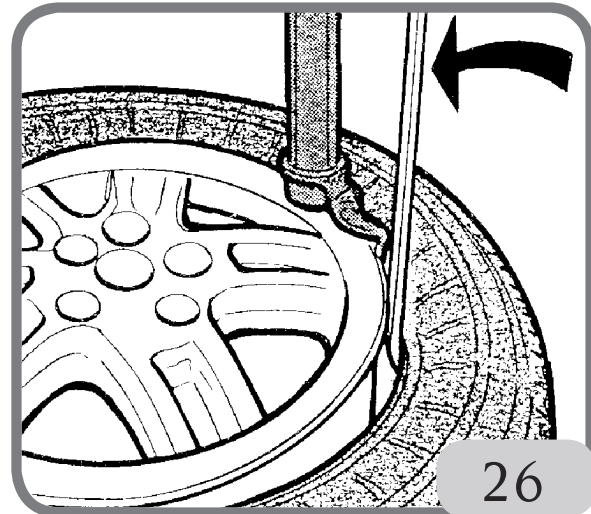

When working with alloy wheels or wheels with delicate paintwork, you are advised to remove the bead lifting tool before proceeding with the demounting.

WARNING

Grip the bead lifting tool firmly during use.

- Lift the upper bead above the rear part of the demounting head (fig. 26a) and force part of the upper bead into the rim well by pushing down on the side wall of the tyre nearest to the operator. (Fig.26b)

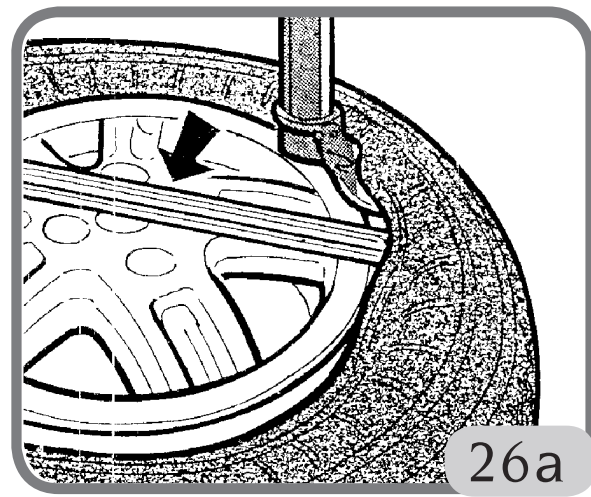

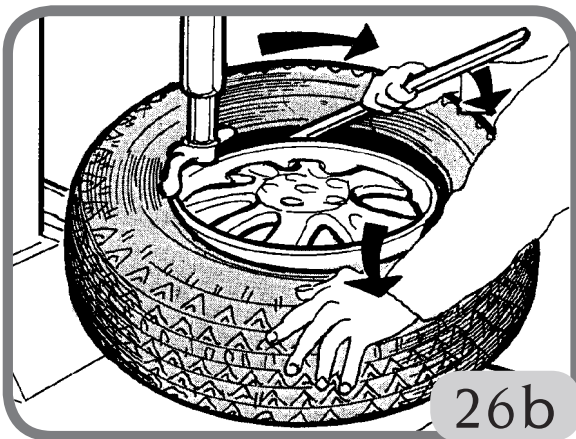

- Press the turntable pedal (fig. 26c) by turning the wheel clockwise. The upper bead will be automatically guided up and over the rim edge (fig. 26b).

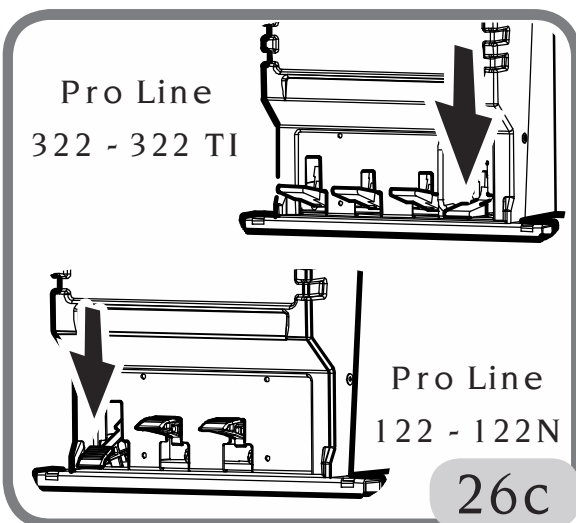

Repeat the last three points to detach the lower bead.

- Tilt the column backwards.

Notes: If the tyre has an inner tube, after detaching the upper bead, tilt the tower back and remove the inner tube before proceeding to demount the lower bead.

The rotation of the turntable can be stopped at any moment by releasing the drive pedal.

For rotation in the opposite direction, just lift the pedal.

PNEUMATIC MOUNTING

WARNING

Always check that the tyre size is compatible with the rim size before mounting.

- Before you start with tyre mounting operations, lubricate the beads (fig. 27).

Lubricated beads require less force to mount/seat and are protected against torsional damage.

Check that the tyre is in good condition with no signs of damage.

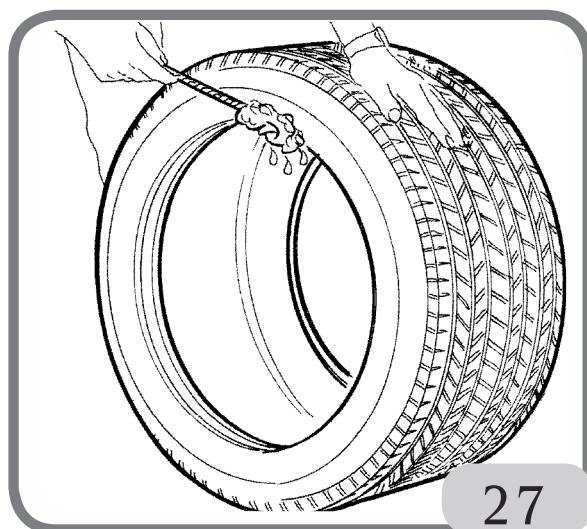

- Place the tyre over the wheel and tilt the tower forward. Position the bottom bead (fig. 28) beneath the right hand side of the mount/demount head.

UK



- Press the table top control pedal to turn the table clockwise and mount the bead. Use the drop centre by pressing the sidewall opposite the head to reduce tensional force on the bead as the wheel rotates (fig.29).
- Once you have mounted the bottom bead, repeat the same steps for the upper bead (fig.29).

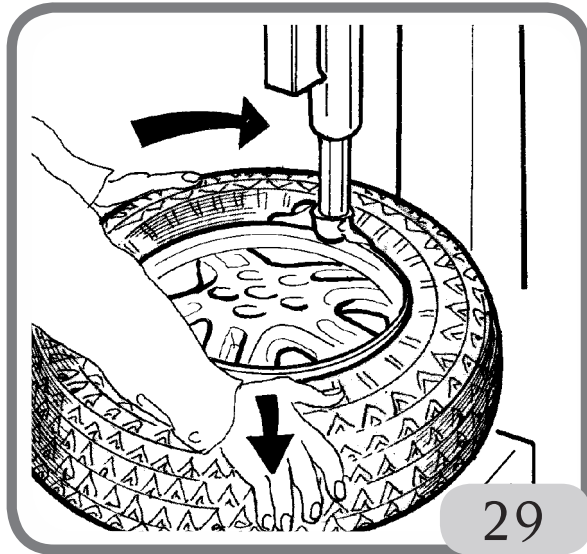

- Tilt the column backwards (Pro Line 322 - 322 TI), or move the arm away (Proline 122 - 122N), release the wheel and remove from the tyre changer.

INFLATING PROCEDURE

Warnings and Hazards

WARNING: Inflation can notoriously be dangerous. This operation must be performed according to the instructions specified below.

CAUTION: This operating phase may involve noise levels of 85 dB (A). It is therefore suggested that ear protectors be worn.

WARNING: During bead insertion and inflation, the use of ear protectors and goggles is recommended.

DANGER: Although it limits pressure, the machine does not ensure sufficient protection in case of tyre explosion during inflation.

Failure to comply with the instructions below will render tyre inflation dangerous.

DANGER: NEVER exceed the pressure value recommended by the tyre manufacturer. Tyres may explode if inflated beyond these limits or their structure may be damaged seriously although not visibly at that moment. **KEEP THE HANDS AND BODY AWAY FROM THE TYRE DURING INFLATION.** Avoid being distracted during this operation and check the tyre pressure often to prevent the tyre from being excessively inflated. A bursting tyre can cause serious injuries or even death.

- Keep your hands and body away from moving parts during operation so as to prevent any injury. Make sure the tyre does not get damaged during inflation and its pressure does not exceed 3.5 bar.

Inflation procedure

- Release the wheel from the sliding clamps on the table top.
- Bring the horizontal arm to the fully extended position.
- Lower the vertical rod until it touches the rim.
- Lock the horizontal arm and the vertical rod in the positions described above (Fig. 30).

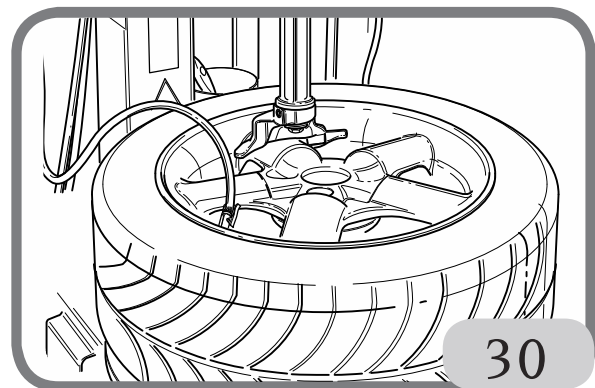

- Connect the Doyfe inflator chuck on the air hose to the valve stem.

Inflate the tyre by operating the proper gun (NOT INCLUDED) at short intervals; check the pressure gauge frequently to make sure that the pressure **NEVER** exceeds the maximum pressure specified by the tyre manufacturer.

Procedure for tubeless tyres (TI versions only)

WARNING

Before carrying out the operations described below, always make sure that there is no dirt, dust or other impurities on the jaws near the air outlet holes.

- Make sure that the wheel is secured to the table top with inside clamping.
- Connect the Doyfe inflator chuck on the air hose to the valve stem.
- Hold the tyre with your hands and lift it until there is a slight gap between the lower bead and bottom edge of the rim in order to close the upper bead and the top of the rim.
- Press the inflation pedal fully down for a short period to the bead seating position (fig. 30). The tyre will expand and the beads will seat.
- Continue to press the pedal in the inflation position (fig. 31) until the beads are completely sealed.

Note: to improve the operation of the tubeless tyre inflation system the compressed air line pressure must be between 8/10 bar.

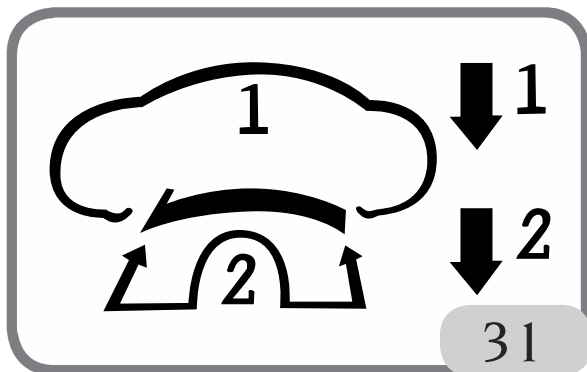

TROUBLE SHOOTING

Turntable will not turn

Earth line wire.

- ➔ Check the wiring.

Motor in short-circuit.

- ➔ Replace the motor.

Rotation control pedal fails to return to central position

Control spring broken.

- ➔ Replace the control spring.

Bead breaker pedal and table top pedal do not return to home position

Control spring broken.

- ➔ Replace the pedal return spring.

No oil in lubricator.

- ➔ Top up lubricator with SAE20 non-detergent oil.

Air leak inside the machine

Air leak from bead breaker cock.

- ➔ Replace the cock.
- ➔ Replace bead breaker cylinder.

Air leak from the table top cock.

- ➔ Replace turntable cylinder.
- ➔ Replace swivel connector.

Bead breaker cylinder lacks force, fails to break beads and leaks air

Silencer plugged.

- ➔ Replace silencer

Cylinder gaskets worn.

- ➔ Replace seals.
- ➔ Replace bead breaker cylinder.

UK

**Bead breaker cylinder leaks
air around the rod**

Air gaskets worn.

- ➡ Replace seals.
- ➡ Replace bead breaker cylinder.

**Turntable will not rotate in
either direction**

Inverter faulty.

- ➡ Replace inverter.

Belt broken.

- ➡ Replace belt.

Gear unit clamped.

- ➡ Replace gear unit.

**Gear unit noisy. The turntable
makes 1/3 of a spin and then stops**

Gear unit seizing.

- ➡ Replace gear unit.

Turntable fails to clamp rims

Turntable does not clamp rim.

- ➡ Replace turntable cylinder.

Clamp grippers are worn.

- ➡ Replace clamp grippers.

**Turntable mounts or demounts
wheels with difficulty**

Insufficient belt tension.

- ➡ Adjust belt tension (Fig. 32-32a) or replace belt.

**Vertical head does not raise or
does it too far from rim**

Clamping plate not adjusted.

- ➡ Adjust plate.

Vertical slide ascends under strain

Defective clamping plate.

- ➡ Replace plate.

Clamping plate not adjusted.

- ➡ Adjust plate.

**When the column tilts back,
the arm and vertical slide slip
to their limit stops**

(for Pro Line 322 - 322 TI only)

Defective clamping plate.

- ➡ Replace plate.

Clamping plate not adjusted.

- ➡ Adjust plate.

**Vertical and horizontal clamp
functions do not work**

(for Pro Line 322 - 322 TI only)

No air passage through cock.

- ➡ Replace the cock.

Column does not tilt

(for Pro Line 322 - 322 TI only)

Faulty tower tilt cylinder.

- ➡ Replace column tilting cylinder.

No air supply to cylinder.

- ➡ Replace the cock.

Air escapes from cock.

- ➡ Replace cock or column tilting cylinder.

**Air leakage from vertical and
horizontal arm clamp cock**

(for Pro Line 322 - 322 TI only)

Valve seal damaged.

- ➡ Replace cock handle.

**Air leakage from
arm clamping cylinders**

(for Pro Line 322 - 322 TI only)

Faulty piston or gaskets.

- ➡ Replace pistons and seals.

**Tyre pressure gauge needle
fails to return to 0**

Pressure gauge faulty or damaged.

- ➡ Replace the pressure gauge.

WARNING

The “Spare parts” handbook does not authorise the user to carry out work on the machine with the exception of those operations explicitly described in the User Manual. It only enables the user to provide the technical assistance service with precise information, to minimise delays.

MAINTENANCE

The following maintenance operations must be performed at least once every month. Before performing any maintenance operation, disconnect the machine from the power supply and air source.

Only specialised technicians are authorised to perform maintenance operations.

Check the oil level in the compressed air cup periodically. If it needs to be topped up, disconnect the machine from the air supply, then fill up with SAE20 oil.

- Clean and lubricate all the moving parts of the turntable (fig. 33).

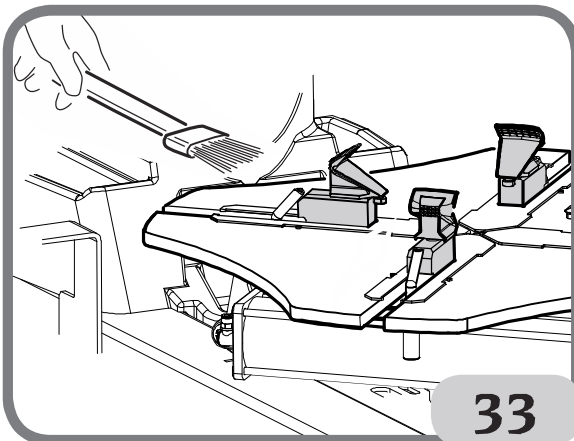

- Check all connection nuts and parts periodically and tighten them if necessary.
- Keep the hexagonal vertical axle clean and lubricate periodically (Pro Line 122 - 122N, Fig.34).

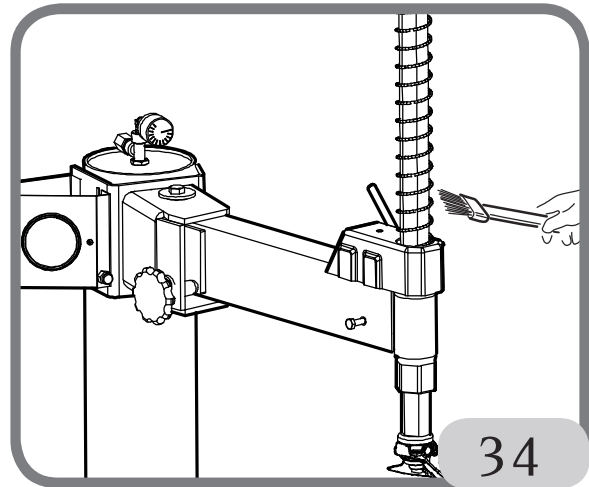

- Keep the hexagonal vertical axle and the horizontal axis guides clean and lubricate periodically (Pro Line 322 - 322 TI, Fig.34a).

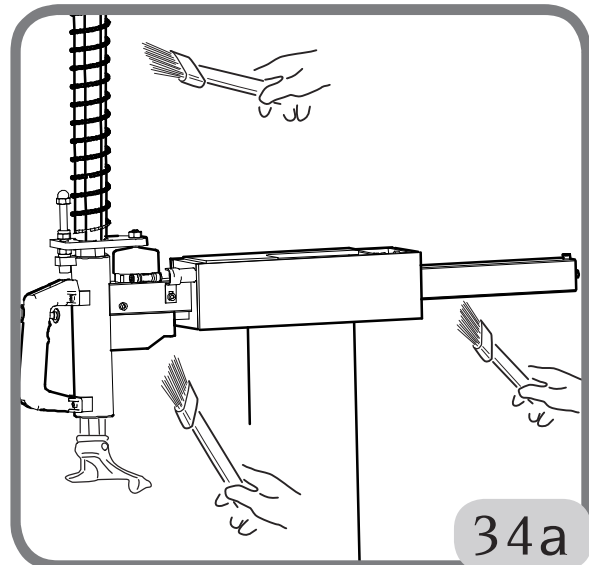

- Check and adjust the driving belt tension (Fig. 32).

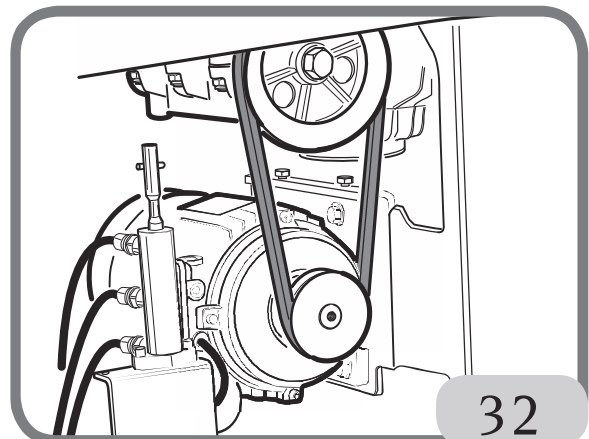

UK

Loosen the 4 bolts (A, Fig. 32a).
Adjust the belt tension with the motor
height adjustment nuts (B, Fig. 32a).
Retighten the bolts (A).

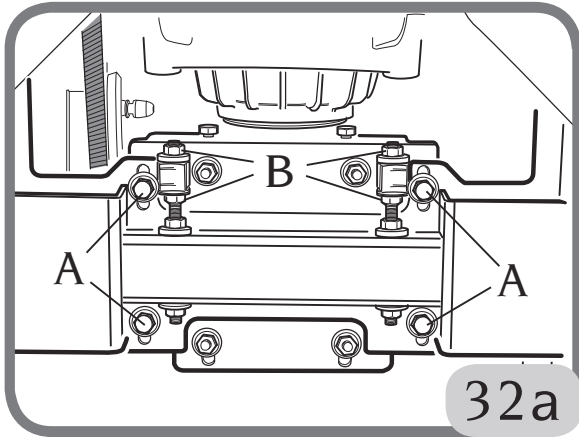

- Keep the machine and the working area clean so as to prevent dust from entering the moving parts.
- Lubricate the entire moving side of the machine weekly.
- Set a dehumidifier near the air compressor so as to reduce the amount of water in the air entering the machine.

WIRING DIAGRAM

- Make sure the machine is grounded before starting it up.
- Operations involving the electrical system must be performed by an authorised operator.

Wiring diagram for tyre changers with
three-phase power supply system

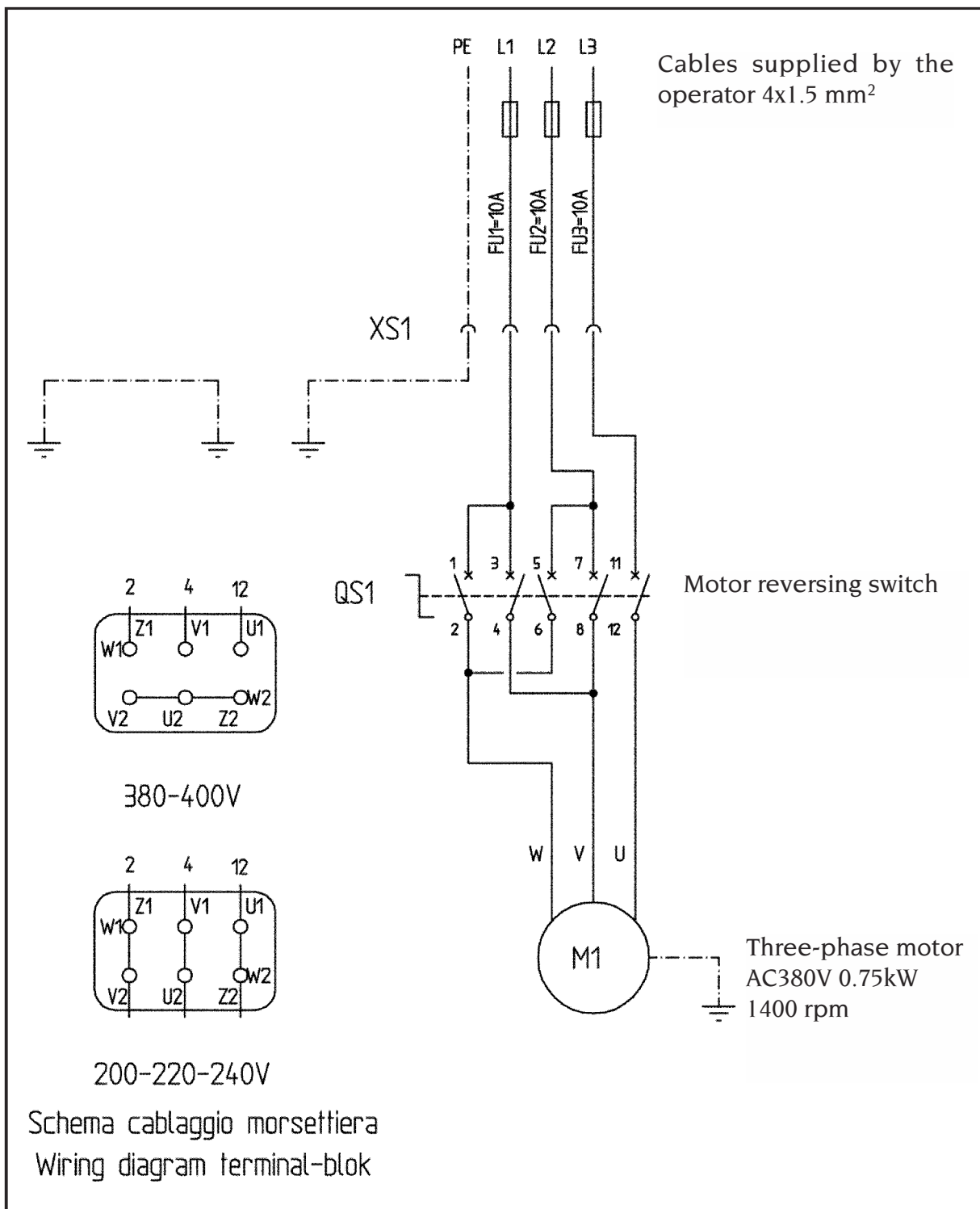

Wiring diagram for tyre changers with 220V single-phase power

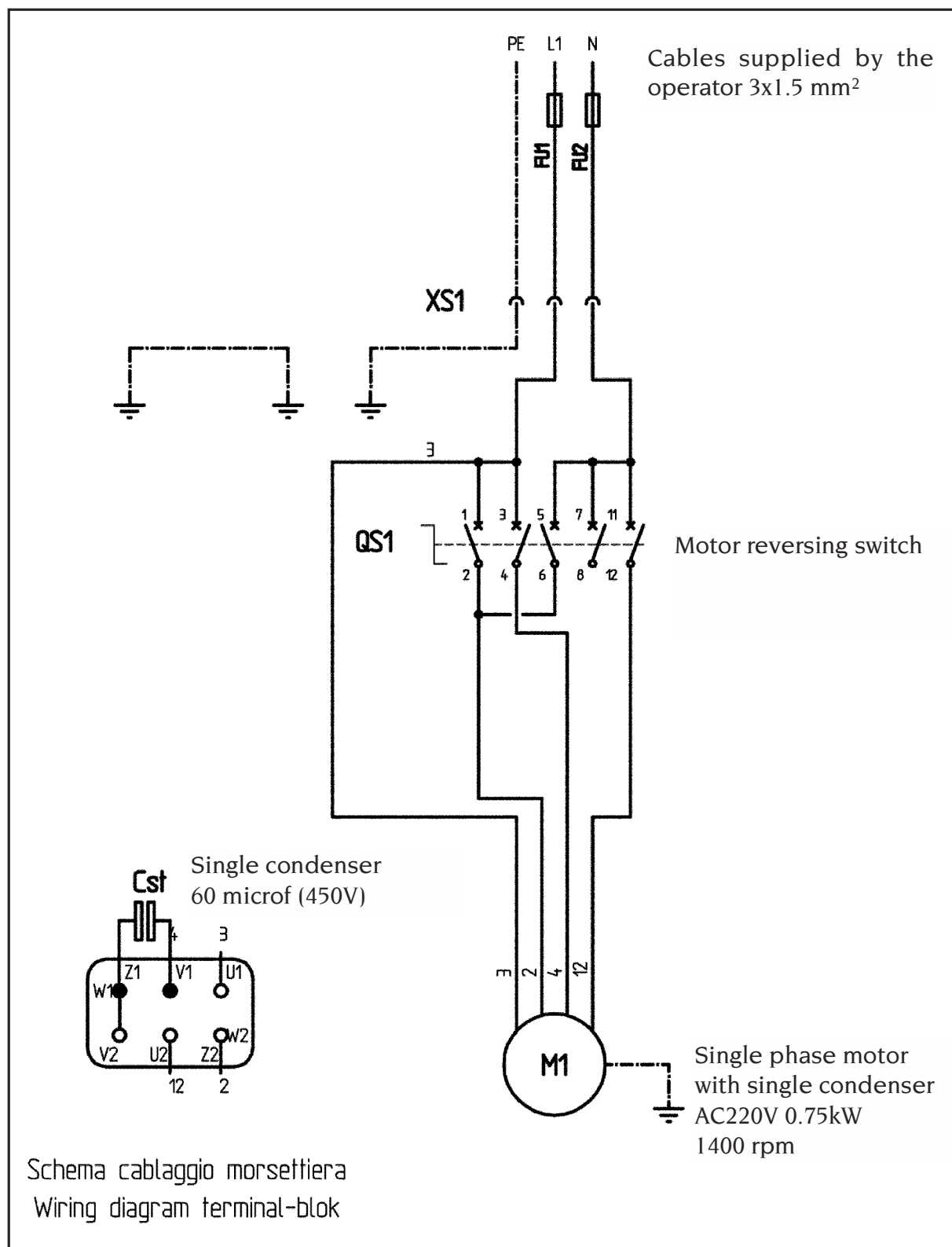

Wiring diagram for tyre changers with 110V single-phase power

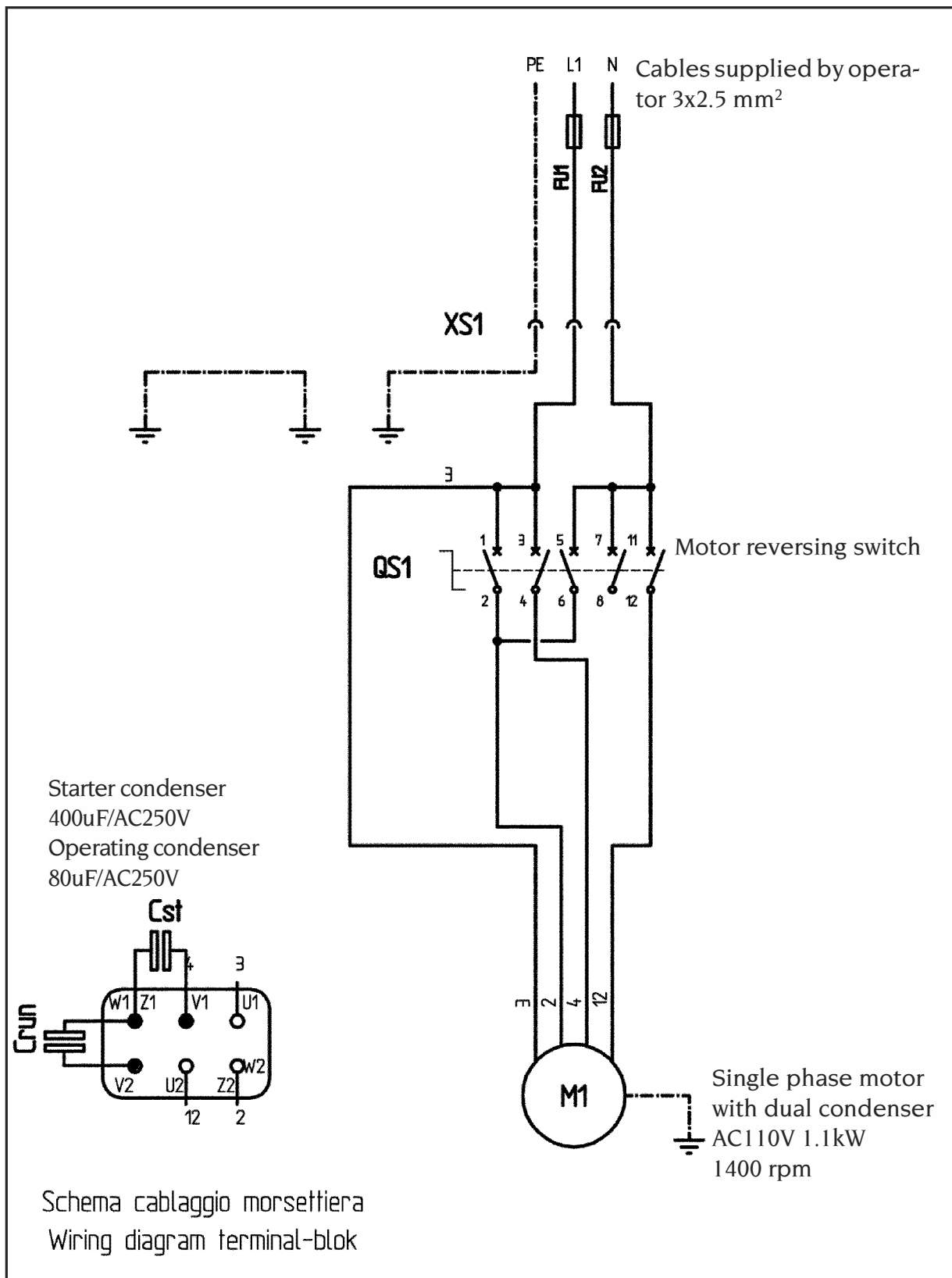

PNEUMATIC DIAGRAM

Pro Line 322

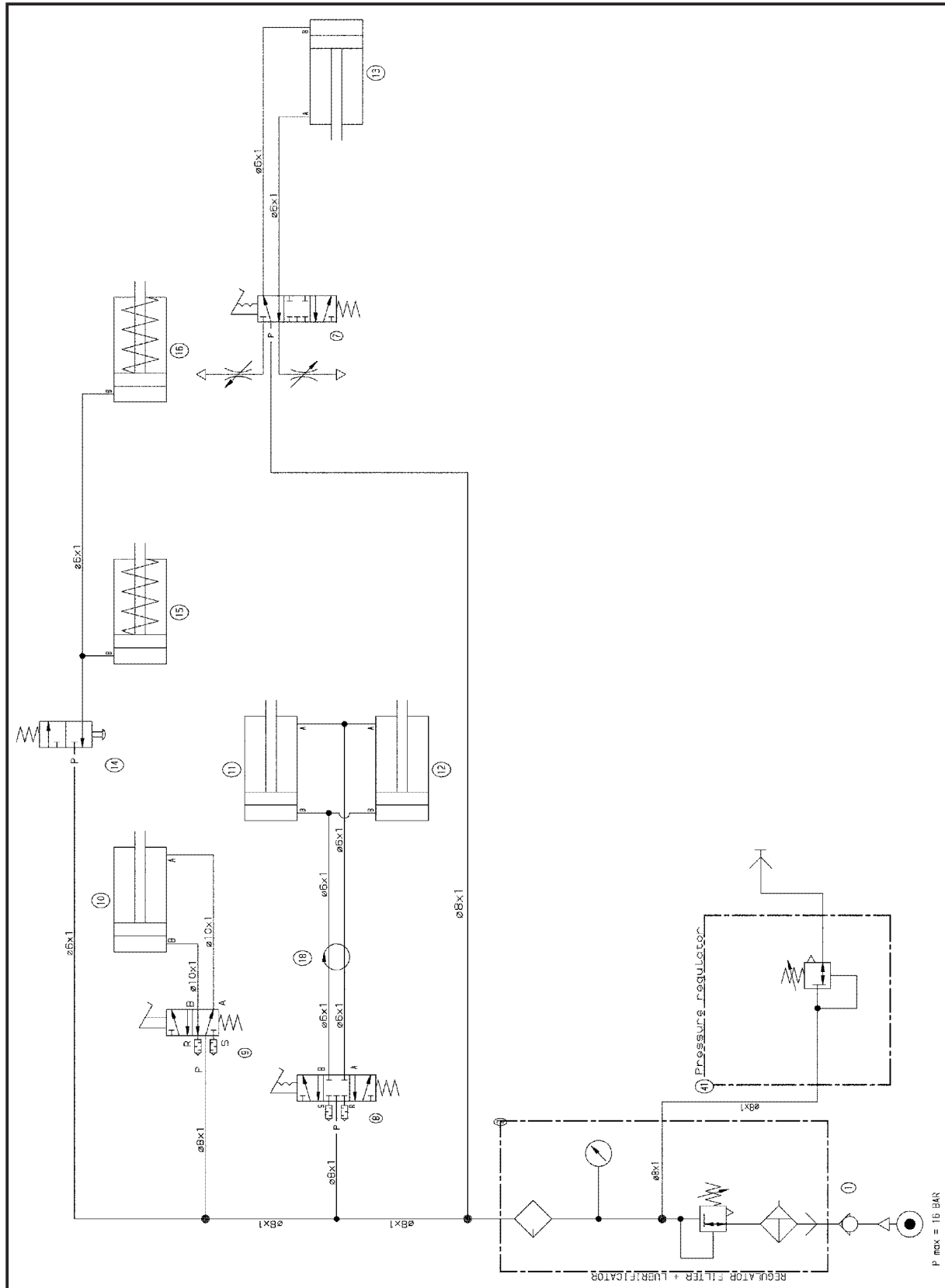

Pro Line 322 TI

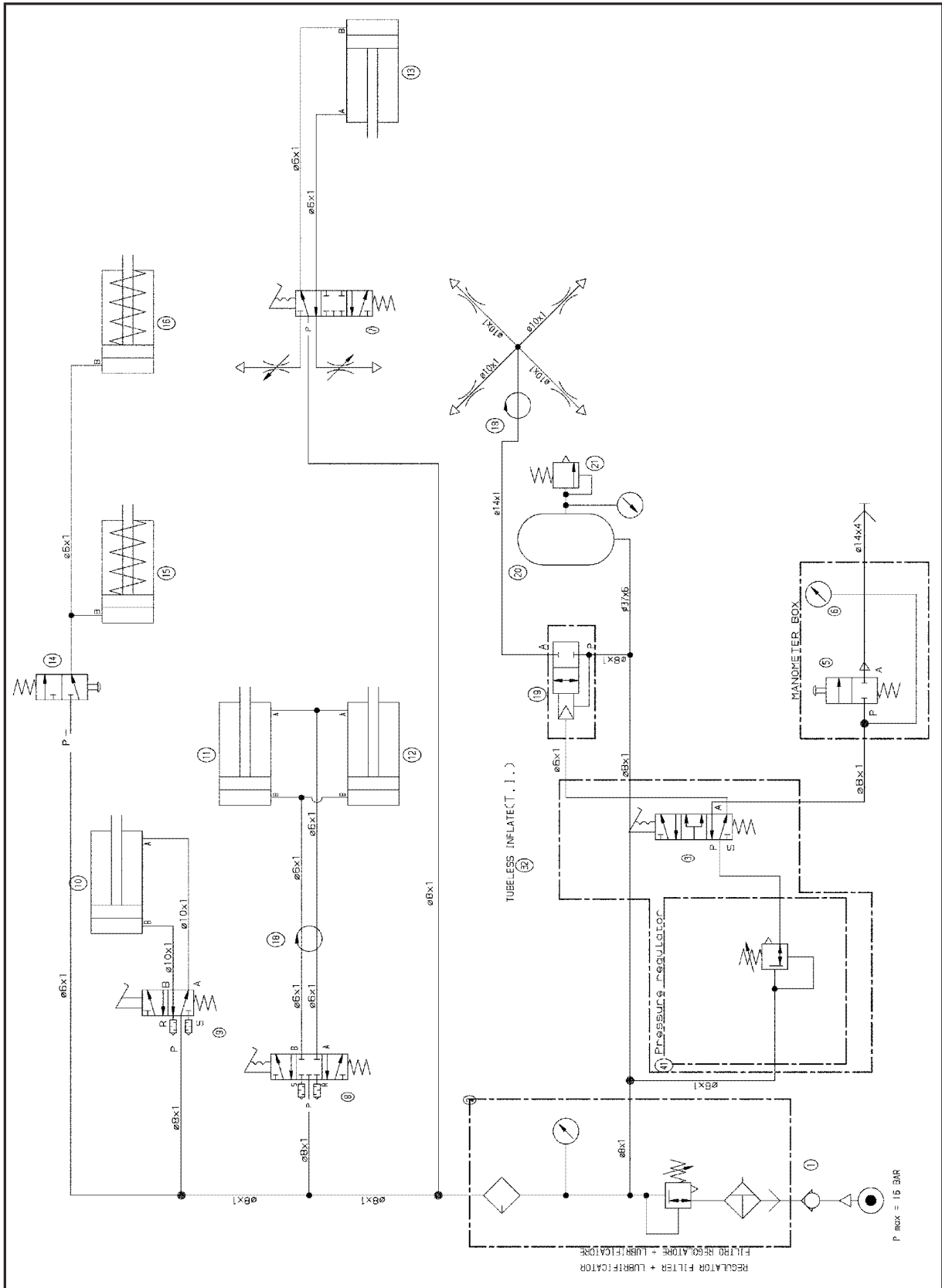

UK

Pro Line 122 Normal

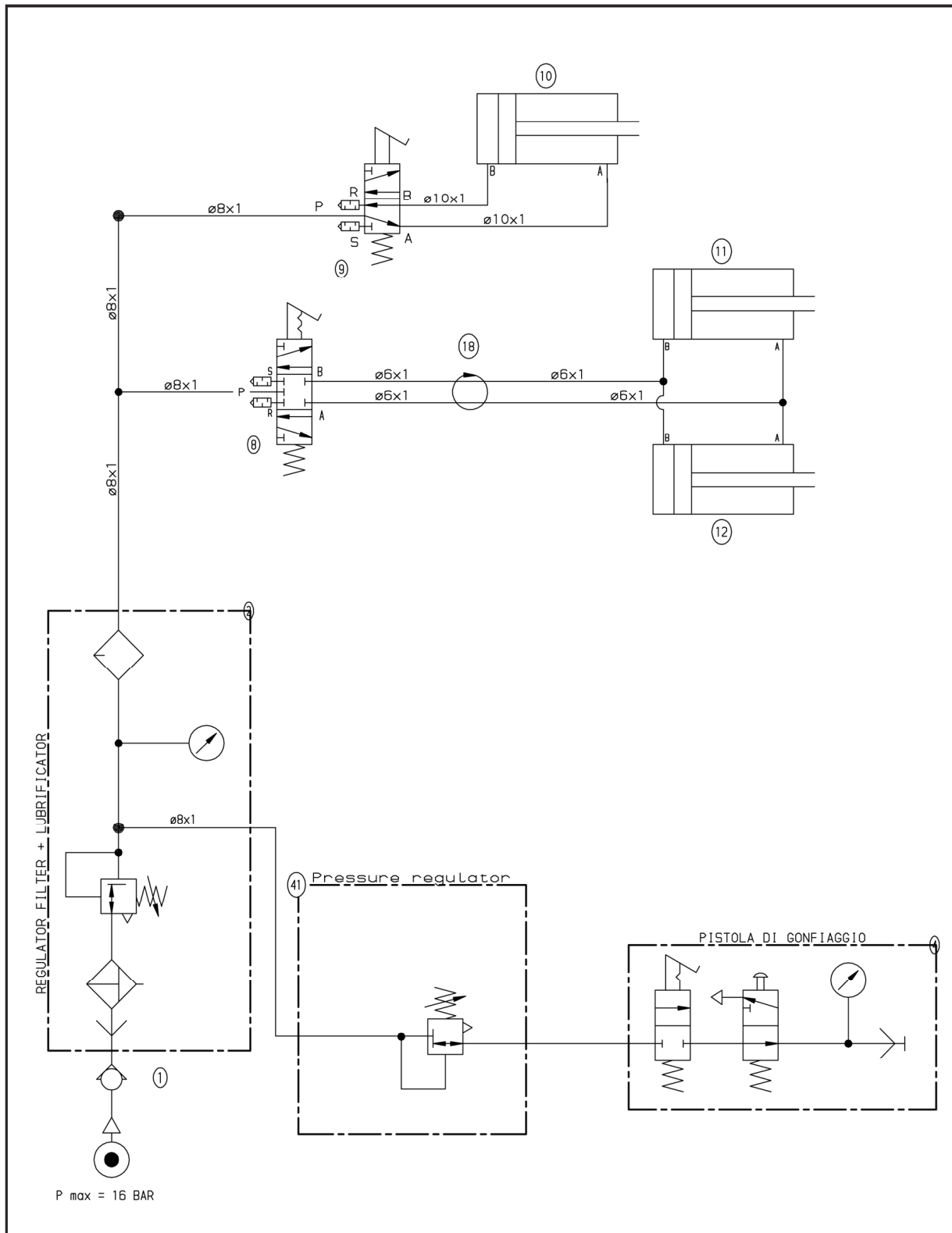

UK

Pneumatic diagram component key

1	Quick release connector
2	Regulator filter + lubricator unit
3	Inflation pedal
5	Deflation button
6	Pressure gauge
7	Column translation valve
8	Turntable valve
9	Bead breaker valve
10	Bead breaker cylinder
11	RH turntable cylinder
12	LH turntable cylinder
13	Column tilting cylinder
14	Clamping handle valve
15	Front clamping cylinder
16	Rear clamping cylinder
18	Swivel union
19	Delivery valve
20	Air tank
21	Overpressure valve
32	Inflation limiter unit
41	Pressure regulator, 0-5 bar

INFORMATION ABOUT DEMOLITION

If the machine is to be scrapped, remove all electrical, electronic, plastic and metal parts and dispose of them separately in accordance with current provisions as prescribed by law.

ENVIRONMENTAL INFORMATION

The disposal procedure described below only applies to machines with the symbol of



the waste bin with a bar across it  on their data plates.

This product may contain substances that can be hazardous to the environment and to human health if it is not disposed of properly.

We are therefore providing you with the information below in order to prevent these substances from being released into the environment, and to improve the use of natural resources.

This product may contain substances that can be hazardous to the environment and to human health if it is not disposed of properly.

We are therefore providing you with the information below in order to prevent these substances from being released into the environment, and to improve the use of natural resources.

Electrical and electronic equipment must never be disposed of in the usual municipal waste but must be separately collected for their proper treatment.

The crossed-out bin symbol, placed on the product and on this page, reminds the user that the product must be disposed of properly at the end of its life.

Thus, the hazardous consequences that non-specific treatments of the substances contained in these products, or improper use of parts of them, may have on the environment or on human health are prevented. Furthermore, this helps to recover, recycle and reuse many of the materials contained in these products.

Electrical and electronic manufacturers and distributors set up proper collection and treatment systems for these products for this purpose.

At the end of the product's working life, contact your supplier for information about disposal procedures.

When you purchase this product, your supplier will also inform you that you may return another worn-out appliance to him free of charge, provided it is of the same type and has provided the same functions as the product just purchased.

Any disposal of the product performed in a different way from that described above will be liable to the penalties provided for by the national regulations in force in the country where the product is disposed of.

Further measures for environmental protection are recommended: recycling of the internal and external packaging of the product and proper disposal of used batteries (only if contained in the product).

Your help is crucial to reduce the amount of natural resources used for manufacturing electrical and electronic equipment, minimise the use of landfills for product disposal and improve the quality of life, preventing potentially hazardous substances from being released in the environment.

ADVICE AND WARNINGS ON HYDRAULIC FLUID

Disposing of spent fluid

Do not dispose of used oil in sewers, storm drains, rivers or streams; collect it and consign it to an authorised disposal company.

Fluid leaks or spills

Contain the spilt product from spreading using soil, sand or any other absorbent material. The contaminated zone must be degreased with solvent, taking care not to allow vapours to form or stagnate, and the residual material from the cleaning process must be disposed of as envisaged by law.

Precautions for the use of hydraulic fluid

- Avoid contact with skin.
- Avoid formation and spreading of oil mists into the atmosphere.
- Adopt the following simple sanitary precautions:
 - avoid spatters (suitable clothing, protective shields on machines)
 - wash frequently using water and soap; do not use cleaning products or solvents that irritate the skin or remove its natural protective oil
 - do not dry your hands using soiled or greasy rags
 - change your clothes if soaked or, in any case, at the end of the work shift
 - do not smoke or eat with greasy hands
- Adopt the following preventive and protective measures as well:
 - mineral oil resistant gloves with plush lining
 - goggles, in case of spatters

UK

- mineral oil resistant aprons
- protective shields, in case of spatters

Mineral oil: first aid indications

- Swallowing: seek medical attention immediately and provide all characteristics of the oil type ingested.
- Inhalation: for exposure to high concentrations of fumes or oil mist, move the affected person to the open air and seek medical attention immediately.
- Eyes: bathe with plenty of running water and seek medical attention immediately.
- Skin: wash with soap and water.

RECOMMENDED FIRE EXTINGUISHING EQUIPMENT

When choosing the most suitable fire extinguisher consult the following table:

	Dry materials	Flammable liquids	Electrical equipment
Water	YES	NO	NO
Foam	YES	YES	NO
Powder	YES*	YES	YES
CO ₂	YES*	YES	YES

YES* Use only if more appropriate extinguishers are not at hand and when the fire is small.



WARNING

The indications given in this table are of a general nature and should be used as a general guide. All the applications of each type of extinguisher must be obtained from the relevant manufacturer.

GLOSSARY

Tubeless tyre inflation system

Inflation system that makes easier the inflation of tubeless tyres.

Insertion system

Operation that is obtained during inflation and that ensures perfect centring between the bead and rim edge.

Bead breaking

Operation that allows detaching the tyre bead from the rim edge.

Bead

Cover edge in contact with the rim.

Tubeless

Air pressure tyre.

Notes

UK

Notes

Dichiarazione CE di conformità

Noi CORGHI SPA, Strada Statale 468 n°9, Correggio (RE), ITALY,
come produttore, dichiara che il prodotto

smontagomme Pro Line 122 Normal - 322 - 322TI

al quale questa dichiarazione si riferisce e di cui abbiamo costituito e deteniamo il relativo fascicolo tecnico, è conforme alle seguenti norme e/o documenti normativi:

- EN ISO 12100
- EN 60204-1

in base a quanto previsto dalle direttive:

- 2006/42/CE
- 2006/95/CE
- 2004/108/CE
- 86/217/CEE
- 2009/105/CE*

* VALIDO SOLO PER VERSIONE TI

Correggio, 07 / 11



CORGHI S.p.A.
Direttore Tecnico
Ing. Corrado Bassoli

IMPORTANTE: La presente dichiarazione perde di efficacia nel caso di modifiche del prodotto rispetto alla conformazione in cui è venduto o di modifiche ai suoi componenti non previamente autorizzate dal costruttore, come pure per il caso di inosservanza delle indicazioni contenute nel manuale d'uso.

Il modello della presente dichiarazione è conforme a quanto previsto nella EN ISO/IEC 17050-1 e EN ISO/IEC 17050-2.

EC Declaration of conformity

We, CORGHI SPA, Strada Statale 468 no.9, Correggio (RE), ITALY, as producer declare that the product

Pro Line 122 Normal - 322 - 322TI tyre changer

to which this statement refers, manufactured by us and for which we hold the relative technical dossier, is compliant with the following standards:

- EN ISO 12100
- EN 60204-1

according to directives:

- 2006/42/EC
- 2006/95/EC
- 2004/108/EC
- 86/217/CEE
- 2009/105/EC*

* only for TI version

Correggio, 07 / 11



CORGHI S.p.A.
Technical Director
Ing. Corrado Bassdi

IMPORTANT: This declaration shall no longer apply if changes are made to the product with respect to its conformation at the time of sale or if changes are made to the components without the prior authorization of the manufacturer, or in the case of non-compliance with the information contained in the user manual.

The model for this declaration complies with what is set forth in EN ISO/IEC 17050-1 and EN ISO/IEC 17050-2

Déclaration de conformité CE

Nous, CORGHI SPA, Strada Statale 468 n°9, Correggio (RE), ITALIE, en tant que producteur déclarons que l'appareil

démonte-pneus Pro Line 122 Normal - 322 - 322TI

objet de cette déclaration et duquel nous avons élaboré et possédons le Livret technique le concernant, est conforme aux normes et/aux documents légaux suivants :

- EN ISO 12100
- EN 60204-1

sur la base de ce qui est prévu par les directives :

- 2006/42/CE
- 2006/95/CE
- 2004/108/CE
- 86/217/CEE
- 2009/105/EC*

* Seulement pour version avec T.I.

Correggio, 07 / 11

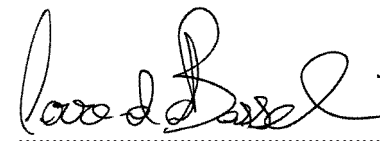

CORGHI S.p.A.
Directeur Technique
Ing. Corrado Bassdi

IMPORTANT: Cette déclaration devient caduque en cas de modifications du produit par rapport à sa conformation d'origine ou de modifications non autorisées par le fabricant, ainsi qu'en cas de non-observance des instructions contenues dans cette notice technique.

Cette déclaration est conforme au modèle prévu par les normes EN ISO/IEC 17050-1 et EN ISO/IEC 17050-2.

EC - Konformitätserklärung

Wir, CORGHI SPA, Strada Statale 468 Nr. 9, Correggio (RE), ITALIEN, erklären, dass das Produkt

Reifenmontiermaschine Pro Line 122 Normal - 322 - 322TI

worauf sich die vorliegende Erklärung bezieht und dessen technische Akte diese Firma entwickelt hat und innehält, den Anforderungen folgender Normen entspricht:

- EN ISO 12100

- EN 60204-1

auf Grundlage der Vorgaben durch folgende Richtlinien:

- 2006/42/EG

- 2006/95/EG

- 2004/108/EG

- 86/217/CEE

- 2009/105/EC*

* Nur version T.I.

Correggio, 07 / 11



CORGHI S.p.A.
Technische Abteilung Direktor
Ing. Corrado Bassoli

WICHTIG: Die vorliegende Konformitätserklärung verliert ihre Gültigkeit, wenn die Beschaffenheit, in der das Produkt verkauft wurde, geändert wird oder nicht zuvor vom Hersteller genehmigte Umrüstungen an seinen Komponenten durchgeführt werden sowie im Falle einer Nichtbeachtung der im Betriebshandbuch enthaltenen Anweisungen. Das Modell dieser Erklärung entspricht den Vorgaben von EN ISO/IEC 17050-1 und EN ISO/IEC 17050-2.

Declaración CE de conformidad

Nosotros CORGHI SPA, Strada Statale 468 N°9, Correggio (RE), ITALY, como productor declara que el producto

desmontagoma Pro Line 122 Normal - 322 - 322TI

al cual se refiere la presente declaración y del que hemos redactado y poseemos el correspondiente expediente técnico, es conforme a las siguientes normas:

- EN ISO 12100 - EN 60204-1

en conformidad con lo establecido por las Directivas:

- 2006/42/EG

- 2006/95/EG

- 2004/108/EG

- 86/217/CEE

- 2009/105/EC*

* Solo por version con T.I.

Correggio, 07 / 11



CORGHI S.p.A.
Director Técnico
Ing. Corrado Bassoli

IMPORTANTE: La presente declaración pierde su validez en caso de modificaciones del producto respecto a la configuración en la que es vendido o de modificaciones en sus componentes no autorizadas previamente por el fabricante, así como en el caso de inobservancia de las indicaciones contenidas en el manual de uso.

El modelo de la presente declaración es conforme a lo dispuesto en la EN ISO/IEC 17050-1 y EN ISO/IEC 17050-2.



CORGHI S.p.A. - Strada Statale 468 n.9
42015 CORREGGIO - R.E. - ITALY
Tel. ++39 0522 639.111 - Fax ++39 0522 639.150
www.corgi.com - info@corgi.com

COMIM - Cod. 4-100045A del 07/11