



ACCESSORI ORIGINALI

Se è vero che il cinquanta per cento di una buona equilibratura dipende dal sistema di centraggio, perché rischiare?

La dichiarazione CE di conformità decade nel caso in cui la macchina non venga utilizzata unicamente con accessori originali CORGHI.

ORIGINAL ACCESSORIES

If it's true that fifty per cent of a good wheel balancing depends on centering system, why to run risks?



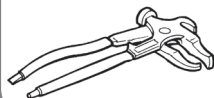
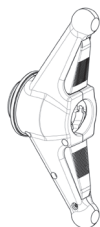
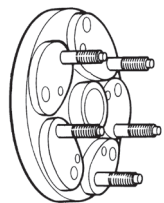
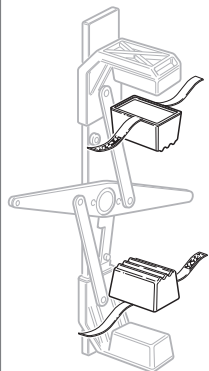

The EC Conformity Declaration is cancelled if the machine is not used exclusively with CORGHI original accessories.

Cod. 4-104667K - 09-2013







INDICE



Serie EM

	Accessori auto	4
	Accessori moto.....	20
	Accessori comuni.....	30
	Accessori di serie	33

Serie ET

	Accessori camion	35
	Accessori auto	38
	Accessori comuni.....	40
	Accessori di serie	41

Serie EF











	Accessori comuni.....	42
	Accessori di serie	43

Specifici per singolo prodotto	44
-----------------------------------	-------	----

IMPORTANTE

I codici 8-211xxxx o 802xxxxxx sono accessori (colonna di sinistra).

TABLE OF CONTENTS

EM		Accessories for car	4
		Accessories for motorcycle.....	20
		Common accessories	30
		Standard accessories	33
ET		Accessories for truck	35
		Accessories for car	38
		Common accessories	40
		Standard accessories	41
EF		Common accessories	42
		Standard accessories	43
Specific for single product		44

IMPORTANT

Code Nbrs. 8-211xxx or 802xxxxxx refer to accessories (left column).

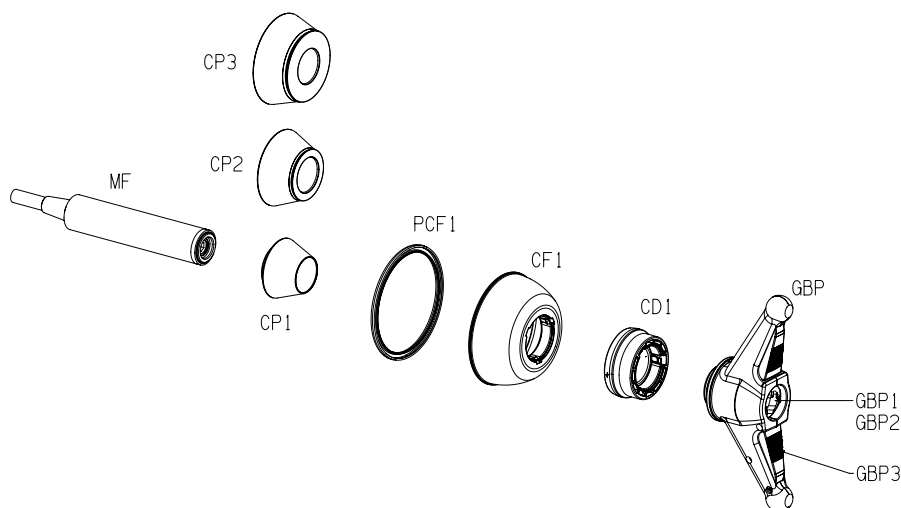

EVO 3 8-21100202 Accessorio di centraggio e bloccaggio per ruote auto a foro centrale da Ø42 a 103,5

Car accessory for centre and clamping hole wheel from Ø42 to 103,5

PCF1	Protezione da montare su CF1 per centraggio cerchi in lega.....	4-115868
	<i>Guard to fix on CF1 for centering alloy wheels</i>	
CF1	Calotta fissaggio ruota	4-115863
	<i>Wheel fixing cap</i>	
CP1	Cono centraggio Ø42-68	4-104790B
	<i>Centering cone Ø42-68</i>	
CP2	Cono centraggio Ø60-87	4-102571B
	<i>Centering cone Ø60-87</i>	
CP3	Cono centraggio Ø83-103,5	4-102572B
	<i>Centering cone Ø83-103,5</i>	
CD1	Distanziale ruota	4-115864
	<i>Wheel spacer</i>	
GBP	Ghiera fissaggio ruota	5-101561
	<i>Ring nut</i>	
GBP 1	Cricchetto dx per ghiera	4-104798
	<i>Clamp "R"</i>	
GBP 2	Cricchetto sx per ghiera	4-104799
	<i>Clamp "L"</i>	
GBP 3	Leva.....	4-104796
	<i>Lever</i>	
MF	Mozzo filettato	5-101514
	<i>Threaded hub</i>	

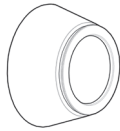

CS1 **8-21100200** **Cono intermedio Ø55-72**
Middle cone Ø55-72-

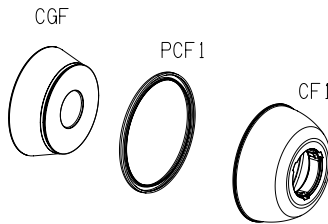

ARF **8-21100080** **Accessorio per ruote fuoristrada con foro centrale da Ø101 a 119**
Accessory for centre hole 4x4 wheel vehicles from Ø101 to 119

CGF	Cono fuoristrada (furgoni) Ø101,25-119.....	4-104793
	4 X 4 cone (van) Ø101,25-119	
PCF1	Protezione da montare su CF1 per centraggio cerchi in lega.....	4-115868
	Guard to fix on CF1 for centering alloy wheels	
CF1	Calotta fissaggio ruota	4-115863
	Wheel fixing cap	

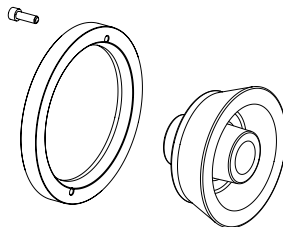

CLT **8-21100201** **Accessorio per ruote SUV-LT e VAN con foro centrale da Ø110 a 132**
Accessory for centre hole SUV-LT and VAN wheel vehicles from Ø110 to 132

Cono SUV-LT Ø110-132.....	4-112320
SUV-LT cone (van) Ø110-132	
Flangia distanziale per appoggio cerchi furgoni.....	341843
Spacer flange for van wheels	



OR



CBG

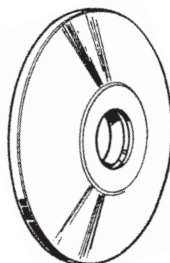

CBG 802459564 Calotta Ø210 per bloccaggio cerchi in lega Ø210
Wheel fixing cup Ø210

OR Anello elastico in gomma462817
 Elastic rubber ring

CBB



CBB 8-21100196 Calotta bifronte serraggio cerchi in lega
Alloy Wheel fixing cup, two sides

DX1



CF1

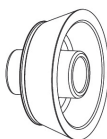

CF2

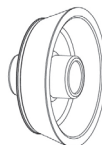

DX/CBF 8-21100141 Accessorio di centraggio per furgoni e fuoristrada con foro
CF1-CF2 centrale da Ø117 a 173
Centring accessory for vans and off-road vehicles with central hole from
Ø117 to 173

DX1 Distanziale 4-107426
Space

CF1 Cono furgoni Ø117 - 147 4-107423
 Van cone Ø117 - 147

CF2 Cono furgoni Ø143 - 173 4-107424
 Van cone Ø143 - 173

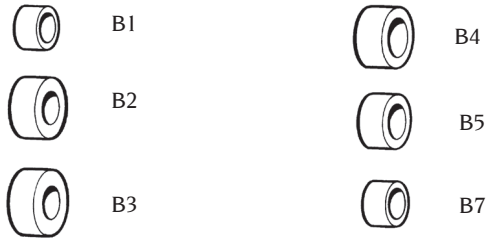

SBC 8-21100082 Set di sei boccole di centraggio posteriore
Set of six wheel centering bushes

B1	Boccola Ø56,5-57,1 (1).....	4-105075
	<i>Bushing Ø56,5-57,1 (1)</i>	
B2	Boccola Ø65-67 (2).....	4-105076
	<i>Bushing Ø65-67 (2)</i>	
B3	Boccola Ø73,2-75,4 (3).....	4-105077
	<i>Bushing Ø73,2-75,4 (3)</i>	
B4	Boccola Ø63,3-64,2 (4).....	4-105078
	<i>Bushing Ø63,3-64,2 (4)</i>	
B5	Boccola Ø58-60,1 (5).....	4-105079
	<i>Bushing Ø58-60,1 (5)</i>	
B7	Boccola Ø54-56,1 (7).....	4-105080
	<i>Bushing Ø54-56,1 (7)</i>	
(1)	Smart (Mercedes), SEAT, Chevrolet, Fiat (Grande Punto), Opel, Audi, Skoda, VW	
(2)	Citroen, Fiat (Scudo), Ford (Transit), Opel, Peugeot, Saab, Volvo, VW, Nissan, Audi (A4), Mercedes, Hyundai, Kia, Mazda, Mitsubishi	
(3)	Aston Martin, BMW (X5, X6), Suzuki (Carry), Jaguar	
(4)	Ford, Jaguar, Mazda (121, Mazda 2), Volvo, Honda, Alfa Romeo	
(5)	Alfa Romeo, Citroen, Fiat, Lancia, Peugeot, Lada, Nissan, Dacia, Renault, Subaru, Toyota	
(7)	Citroen (C1), Daihatsu, Hyundai, Kia, Mazda, Opel (Agila), Peugeot (106, 107), Subaru, Suzuki, Toyota, Honda, Mini (BMW), Proton	

B6



B6 **8-21100083** **Boccola Racing Ø67 (Ferrari - Maserati)**
Racing bushing Ø67 (Ferrari - Maserati)

B9



B9 **8-21100085** **Boccola OPEL Ø56,5 - Ø65 - Ø70,1**
OPEL bushing Ø56,5 - Ø65 - Ø70,1

BMCC



B1



KIT-MERCEDES **8-21400022** **Boccole centraggio Mercedes**
Mercedes centering bushes

B1 Boccola Ø 57 4-105075
Bushing Ø 57

BMCC Boccola Ø 66,5-84 4-115259
Bushing Ø 66,5-84

B2



B11



KIT-BMW **8-21100228** **Boccole centraggio BMW**
BMW centering bushes

B2 Boccola Ø 66,5 4-105076A
Bushing Ø 66,5

B11 Boccola Ø 56,5 - 72,5 - 74 4-112535
Bushing Ø 56,5 - 72,5 - 74

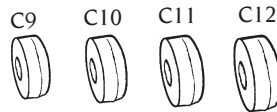

SBT 8-21100205 Set di 4 boccole per ruote SUV, veicoli industriali leggeri, furgoni
Set of 4 bushing for SUV, light truck and van wheels

C9	Boccola (lato A Ø100 ; Lato B Ø105-106) 4-112534 Bushings (side A Ø100 ; side B Ø105-106)
C10	Boccola (lato A Ø107-108 ; Lato B Ø109-110) 4-112535 Bushings (side A Ø107-108 ; side B Ø109-110)
C11	Boccola (lato A Ø113 ; Lato B Ø115,8-116,8) 4-112536 Bushings (side A Ø113 ; side B Ø115,8-116,8)
C12	Boccola (lato A Ø121,6 ; Lato B Ø124-125) 4-112537 Bushings (side A Ø121,6 ; side B Ø124-125)

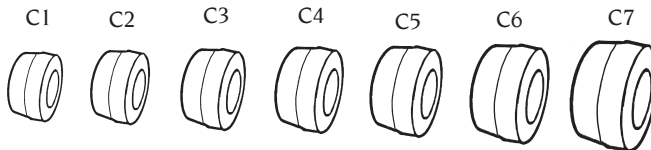

SBV 8-21100204 Set di 7 boccole per ruote da autovettura
Set of 7 bushing for passenger car wheels

C1	Boccola (lato A Ø54 ; Lato B Ø56-56,5-57) 4-112527 Bushings (side A Ø54 ; side B Ø56-56,5-57)
C2	Boccola (lato A Ø58-58,5 ; Lato B Ø59-59,5-60) 4-112528 Bushings (side A Ø58-58,5 ; side B Ø59-59,5-60)
C3	Boccola (lato A Ø63,3-64 ; Lato B Ø65-65,5-66-66,5) 4-112529 Bushings (side A Ø63,3-64 ; side B Ø65-65,5-66-66,5)
C4	Boccola (lato A Ø67-68 ; Lato B Ø69,5-70-70,5) 4-112530 Bushings (side A Ø67-68 ; side B Ø69,5-70-70,5)
C5	Boccola (lato A Ø71-71,5-72-72,5 ; Lato B Ø73,8-74-74,5) 4-112531 Bushings (side A Ø71-71,5-72-72,5 ; side B Ø73,8-74-74,5)
C6	Boccola (lato A Ø77,8-78 ; Lato B Ø84-85) 4-112532 Bushings (side A Ø77,8-78 ; side B Ø84-85)
C7	Boccola (lato A Ø87 ; Lato B Ø92,5-93) 4-112533 Bushings (side A Ø87 ; side B Ø92,5-93)

B10



B12



B13



B14



B15



OK-RENAULT

8-21100229

Boccole centraggio Renault
Renault centering bushes

B10 4-105106

Boccola RENAULT Ø60
RENAULT bushing Ø60

B12 4-107025

Boccola RENAULT "Laguna" Ø66
RENAULT "Laguna" bushing Ø66

B13 4-107026

Boccola RENAULT "Trafic" Ø71
RENAULT "Trafic" bushing Ø71

B14 4-107027

Boccola RENAULT Ø89
RENAULT bushing Ø89

B15 4-107028

Boccola RENAULT Ø130
RENAULT bushing Ø130

DM



DM 8-21100088

Distanziale riduttore per ruote Mini Morris
Spacer for MINI MORRIS

ARS

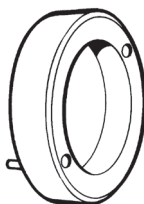

DARS



ARS 8-21100089

Accessorio "Racing" per ruote sportive, da usare con boccola Racing
(utilizzabile anche in coppia: es. Ferrari F348)
Racing accessory for sport wheels to be used with racing bushing (possible use in couple es.: Ferrari F348)

DARS

Distanziale da 30mm 4-105171
Spacer of 30mm

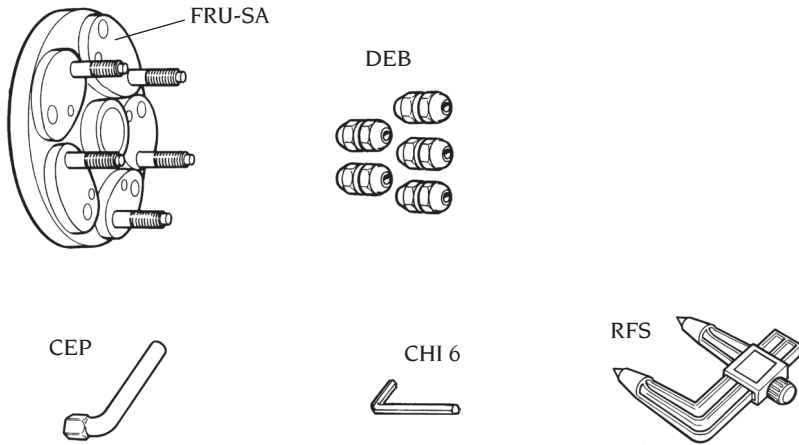

FRU-SA 8-21100091	Flangia autocentrante UNIVERSALE per ruote con o senza foro centrale Ø foratura min.90 max.210mm UNIVERSAL selfcentering flange for open and close centre wheels, PCD min.90 max.210mm
FRU SA	Biella con perno2401415 <i>Connecting rod with pin</i>
DEB	Dado BIFRONTI (conico e sferico) per fissaggio ruote.....321878 <i>Conical/spheric nut for wheel fixing</i>
RFS	Rilevatore fori per misura distanza fori fissaggio ruota.....441286 <i>Caliper</i>
CEP	Chiave esagonale a pipa (ch22) per serraggio DEB.....426517 <i>Hexagonal key (22mm)</i>
CHI 6	Chiave esagonale CH6.....600906 <i>Hexagonal key CH6</i>

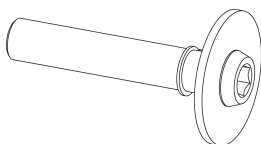

8-21100207 Disco fissaggio boccole di centraggio (flangia FRU/STD)
Centering bushing fixing disk (FRU/STD flange)

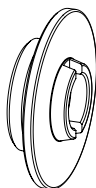

8-21100208 Disco fissaggio boccole di centraggio (flangia FRU/ELS)
Centering bushing fixing disk (FRU/ELS flange)

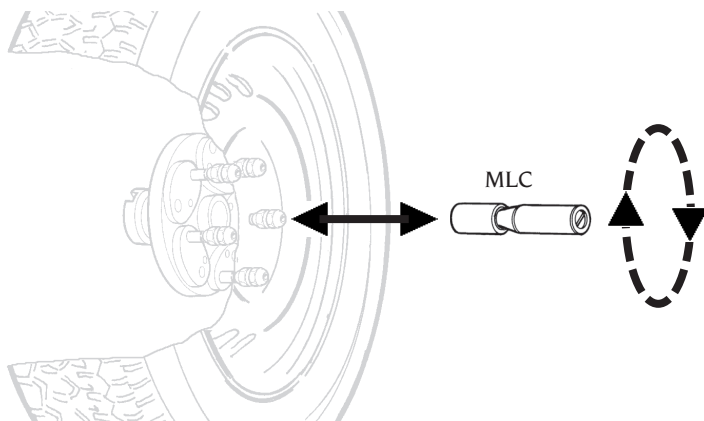

MLC 802244344 Manovella lancio ruote montate su flange FRU
Hand spin handle for flanges FRU

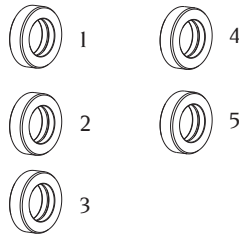

BVFF 8-21100092 Set di 5 boccole per un preciso centraggio sulla flangia FRU-SA
Set of 5 bushings for accurate wheel centring on FRU-SA flange

1	Boccola Ø55 Peugeot4-105110 Bushings Ø55 Peugeot
2	Boccola Ø58,1 Fiat Ritmo e Citroën CX/Evasion, Peugeot 806 4-105174 Bushings Ø58,1 Fiat Ritmo and Citroën CX/Evasion, Peugeot 806
3	Boccola Ø60,1 Renault4-105175 Bushings Ø60,1 Renault
4	Boccola Ø65 Peugeot, Citroën4-105176 Bushings Ø65 Peugeot, Citroën
5	Boccola Ø57 BMW, VW, AUDI, SEAT4-106570 Bushings Ø57 MW, VW, AUDI, SEAT

DC5

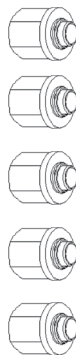

DC5 802262700 Set di cinque dadi speciali per il bloccaggio delle ruote in lega Citroën C5 sulla flangia FRU
Set of five nuts for fixing the Citroën C5 alloy wheels on FRU flange

BCO



- BCO 802321387** Set di cinque rondelle coniche da utilizzare con DCL o DEB in caso di fori con Ø maggiore di 21mm
Set of five conical bushings to be used with DCL or DEB when wheel holes are longer Ø21mm

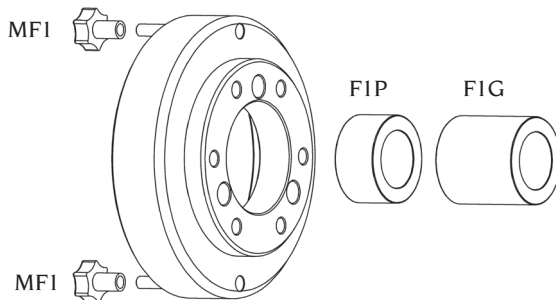

- ARF1 8-21100093** Flangia speciale per ruote da F1
Special flange for F1 wheel
- | | | |
|-----|-----------------------------------|----------|
| FIG | Distanziale L=60 | 4-105181 |
| | L=60 spacer | |
| FIP | Distanziale L=30 | 4-105171 |
| | L=30 spacer | |
| MF1 | Manopola per distanziale F1 | 459932 |
| | F1 spacer knob | |

Accessorio ruote F1 compatibile con attacchi Ferrari, McLaren, Toyota.
Wheel accessory F1 compatible with Ferrari, McLaren, Toyota adapters.

DCL



DCL 802322075 Set di cinque dadi conici per ruote in lega con flange FRU
Set of five conical nuts for alloy wheels on FRU flanges

BC BOS VF

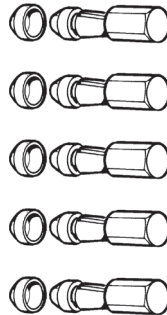

SDR 802231479 Set di cinque dadi per fissaggio rapido ruote con flange FRU
Set of five quick fixing nuts for FRU flanges

BC	Boccola conica	431481
	<i>Conical bush</i>	
BOS	Boccole sferica	431482
	<i>Spheric bush</i>	
VF	Vite fissaggio rapido	431480
	<i>Quick fixing screw</i>	



DMS

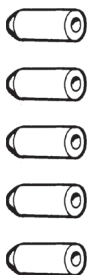

- DMS 802322076** Set di cinque dadi sferici per bloccaggio ruote in lega con flangia FRU
Set of five spheric nuts for alloy wheels when fixing on FRU flanges

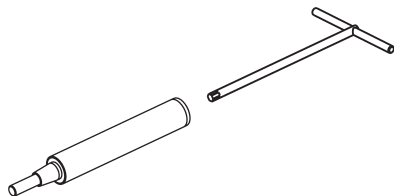

- TR40X220 8-21100193** Mozzo filettato "oversize" \varnothing 40 con chiave fissaggio
"Oversize" threaded hub \varnothing 40 with fixing key

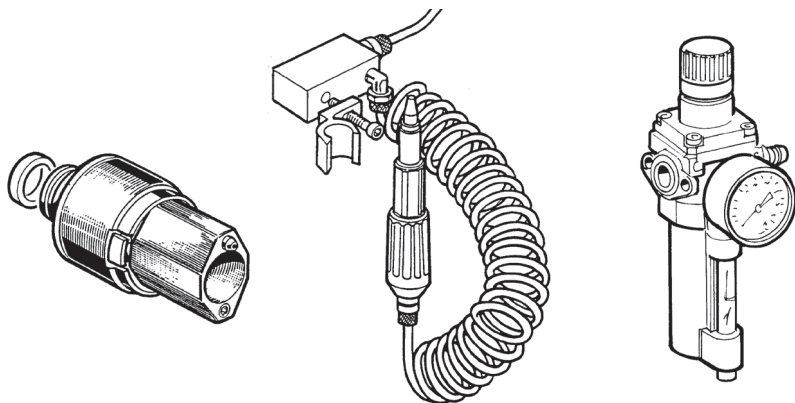

- QLN 8-21100095** Ghiera rapida pneumatica Q.L.
Q.L. quick ring nut

VNT

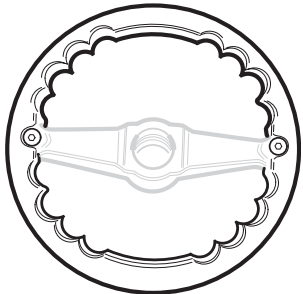

VGBP 802260682 Volantino ghiera fissaggio ruota
Hand wheel for fixing ring nut

VNT Volantino per ghiera460507
Hand wheel for ring nut

FPF BMW

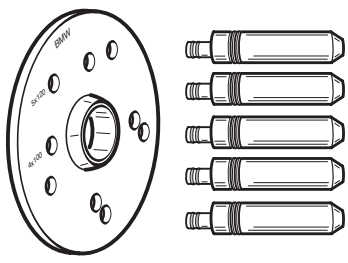

FPF-2 BMW 8-21100145 Flangia universale per ruote con foro centrale
ø 4x100 / 5x120 / 5x112

Universal flange for wheels with central hole
ø 4x100 / 5x120 / 5x112

PBMW



PBMW-120 4-115856 Perno BMW 120 mm
Pin BMW 120 mm

FPF PREMIUM

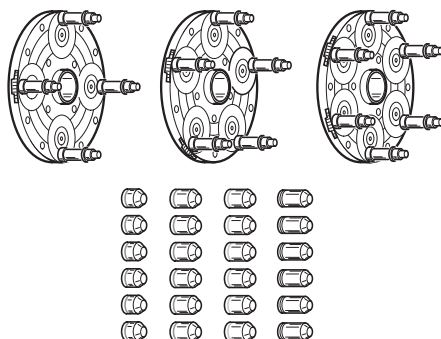

FPF PREMIUM 8-21100150

Kit flangie universali per ruote con foro centrale
Universal flange kit for wheels with central hole

HST1	Tappo ø 24,5 l 28.....	4-108078
	Plug ø 24,5 l 28	
HST2	Tappo ø 24,5 l 38.....	4-108079
	Plug ø 24,5 l 38	
HR	Tappo ø 24,5 l 38.....	4-108080
	Plug ø 24,5 l 38	
HLT	Tappo ø 22,5 l 48.....	4-108081
	Plug ø 22,5 l 48	
UEC	Unità eccentrica.....	4-108082
	Eccentric unit	

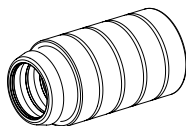
**8-21100212 Manicotto per versioni ELS**
Extension for ELS version

FPF PROFESSIONAL

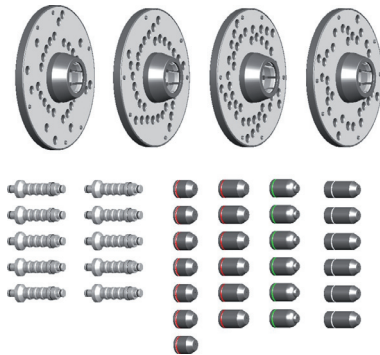

FPF PROFESSIONAL 8-21100151

Kit flangie universali per ruote con foro centrale
Universal flange kit for wheels with central hole

HST1	Tappo ø 24,5 l 28.....	4-108078
	Plug ø 24,5 l 28	
HST2	Tappo ø 24,5 l 38.....	4-108079
	Plug ø 24,5 l 38	
HR	Tappo ø 24,5 l 38.....	4-108080
	Plug ø 24,5 l 38	
HLT	Tappo ø 22,5 l 48.....	4-108081
	Plug ø 22,5 l 48	
PPR	Perno Professional	4-108083
	Professional Pin	

FPF BASIC

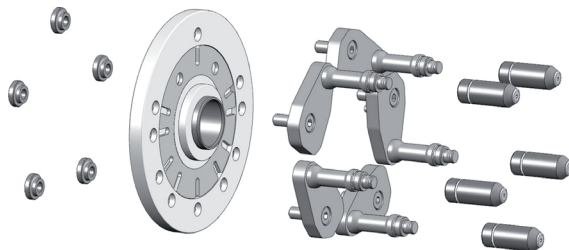

FPF BASIC 8-21100152

Flangia universale per ruote con foro centrale
Universal flange for wheels with central hole

HLT2	Tappo ø 22,5 l 58.....	4-109127
	Plug ø 24,5 l 28	
PET	Petalo Basic.....	4-108097
	Petalo Basic	

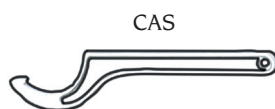
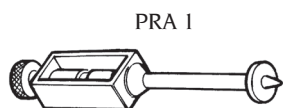
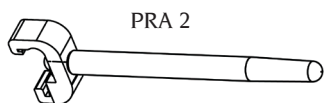
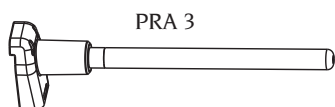
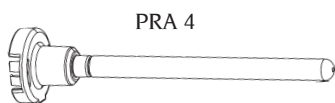
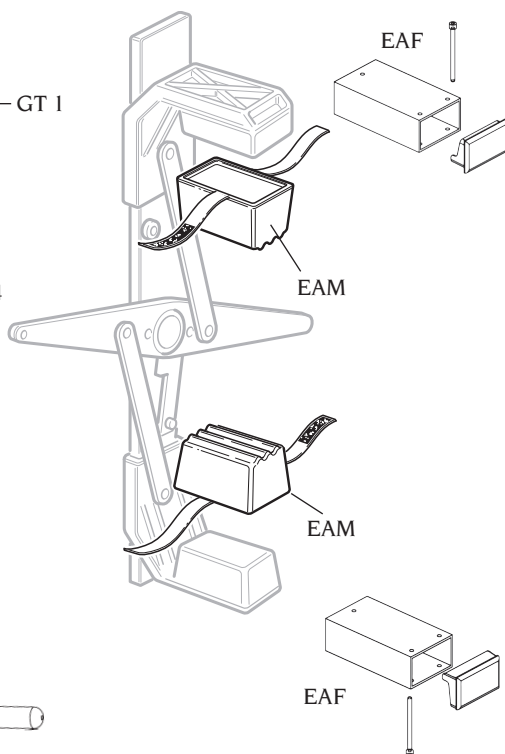
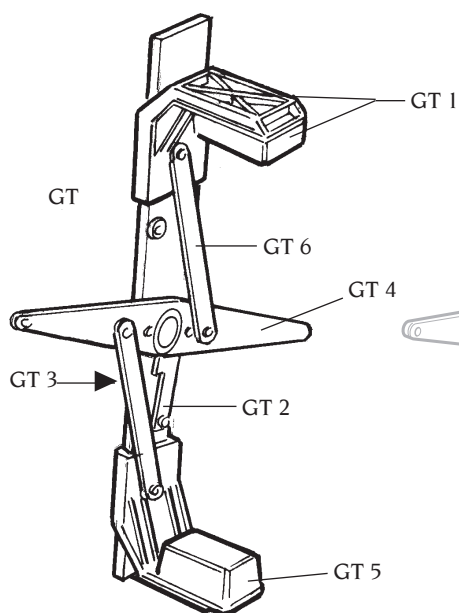

AUMO 2 8-21100094		Autocentrante per ruote moto (deve essere completato con i gruppi GAPR) Motorcycle adapter (to be completed with GAPR groups)
GT	Gruppo trascinatore.....	5-101657 <i>Dragging group</i>
GT1	Griffa	235991 <i>Jaw</i>
GT2	Cricchetto	359728 <i>Clamp</i>
GT3	Disco dentato	359730 <i>Serrated disk</i>
GT4	Impugnatura.....	359729 <i>Handle</i>
GT5	Tampone per griffa	239059 <i>Jaw plug</i>
GT6	Biella	235992 <i>Connecting rod</i>
PRA 1	Prolunga rilevatore per rilevamento distanza moto.....	238326 <i>Motorcycle distance measuring extension</i>
PRA 2	Prolunga rilevatore per rilevamento distanza moto (EM83X0).....	5-100831 <i>Motorcycle distance measuring extension (EM83X0)</i>
PRA 3	Prolunga rilevatore per rilevamento distanza moto (EM74X0-EM72X0clip) <i>Motorcycle distance measuring extension (EM74X0-EM72X0clip)</i>	5-102024
PRA 4	Prolunga rilevatore per rilev. distanza moto (EM72X0)	5-103066 <i>Motorcycle distance measuring extension (EM72X0)</i>
CHI 6	Chiave esagonale per serraggio viti VTS.....	600906 <i>Allen wrench</i>
VTs	Vite speciale M8x22 per fissaggio GT a flangia equilibratrice	340687 <i>Special screw M8x22</i>
CA 15	Chiave aperta per serraggio APR ad albero equilibratrice	443032 <i>Open wrench</i>
CAS	Chiave aperta a settori per serraggio APR ELS	4-107210 <i>Open wrench to sectors</i>
EAM 802257337	Coppia di adattatori mobili per ruote scooter 10" Pair of mobile adaptor for scooter wheels 10"	
EAF 802250704	Coppia di adattatori fissi per ruote scooter 12" Pair of fixed adaptor for scooter wheels 12"	
SMGA 802247715	Coppia di manovelle per ghiera AUMO 2 (solo per modelli a lancio manuale) Pair of hand spin handles for AUMO 2 (only for hand spin models)	
PRA 3 8-21100116	Prolunga rilevatore per rilevamento distanza moto (EM74X0-EM72X0clip)* Motorcycle distance measuring extension (EM74X0-EM72X0clip)*	
PRA 4 8-21100155	Prolunga rilevatore per rilev. distanza moto (EM72X0)* Motorcycle distance measuring extension (EM72X0)*	

* : già presente nel kit AUMO (8-21100094) - *Already available in 8-21100094*

Gruppi GAPR per equilibratrici STD *GAPR groups for STD wheel balancer*



GAPR 10 802235997 Gruppo albero Ø10 con boccole ***Shaft assembly Ø10 with bushes***

APR 10	Albero porta ruota Ø10.....	335999
	<i>Wheel holding shaft Ø10</i>	
K 10	Cono centraggio ruota Ø10-23mm.....	335998
	<i>Wheel centering cone Ø10-23mm</i>	
V 10	Boccola Ø20x40.....	323076
	<i>Bush Ø20x40</i>	
J 10	Distanziale esterno Ø25x15	323072
	<i>Outer spacer Ø25x15</i>	
GR 10	Ghiera	344318
	<i>Collet</i>	

Gruppi GAPR per equilibratrici STD GAPR groups for STD wheel balancer

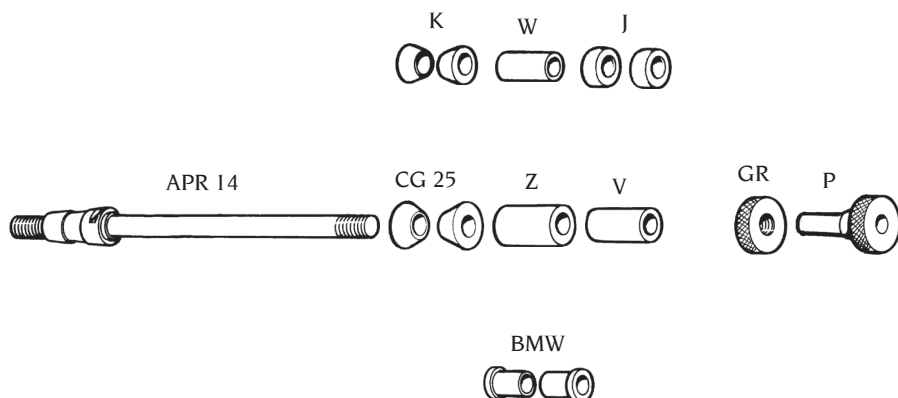

GAPR 14 802235989

Gruppo albero Ø14 con boccole Shaft assembly Ø14 with bushes

APR 14	Albero porta ruota Ø14.....	335969
	Wheel holding shaft Ø14	
BMW	Boccole per ruote BMW Ø17.....	319231
	Bushing for BMW wheels Ø17	
GR	Ghiera	344317
	Collet	
P	Ghiera con prolunga da 70mm	344335
	Collet with extension of 70mm	
K	Cono centraggio ruota Ø14-25mm.....	335970
	Wheel centering cone Ø14-25mm	
W	Boccola Ø17x40.....	316151
	Bushing Ø17x40	
J	Distanziale esterno Ø25x15	316164
	Outer spacer Ø25x15	
CG 25	Cono per ruote BMW Ø14-30	335972
	Cone for BMW wheels Ø14-30	
Z	Boccola Ø25x40.....	316153
	Bushing Ø25x40	
V	Boccola Ø20x40.....	316152
	Bushing Ø20x40	

Gruppi GAPR per equilibratrici STD GAPR groups for STD wheel balancer

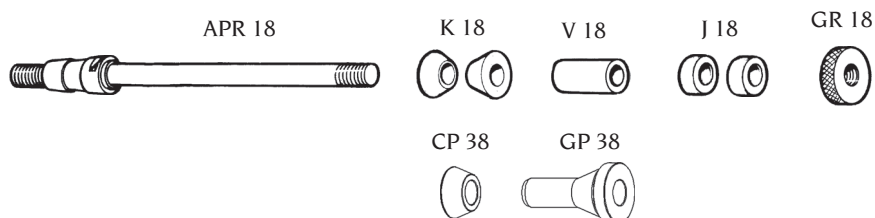

GAPR 18 802241240

Gruppo albero Ø18 con boccole Shaft assembly Ø18 with bushes

APR 18	Albero porta ruota Ø18.....	341294
	Wheel holding shaft Ø18	
K 18	Cono centraggio ruota Ø18-30	341292
	Wheel centering cone Ø18-30	
V 18	Boccola Ø20x40.....	323059
	Bush Ø20x40	
J 18	Distanziale esterno Ø25x15	323058
	Outer spacer Ø25x15	
GR 18	Ghiera	344319
	Collet	
CP 38	Cono centraggio ruota Ø28-38	363089
	Wheel centering cone Ø28-38	
GP 38	Ghiera con prolunga a cono Ø22-38.....	362808
	Collet with cone extension Ø22-38	

Gruppi GAPR per equilibratrici ELS GAPR groups for ELS wheel balancer

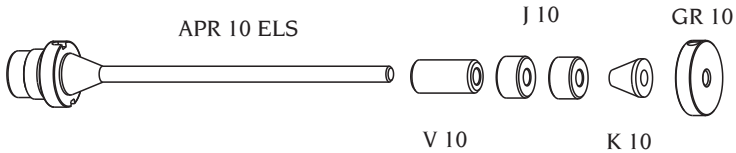

GAPR 10 8-21100124 Gruppo albero Ø10 con boccole Shaft assembly Ø10 with bushes

APR 10 ELS	Albero porta ruota Ø10.....	4-106958
	Wheel holding shaft Ø10	
V 10	Boccola Ø20x40.....	323076
	Bush Ø20x40	
J 10	Distanziale esterno Ø25x15	323072
	Outer spacer Ø25x15	
K 10	Cono centraggio ruota Ø10-23	335998
	Wheel centering cone Ø10-23	
GR 10	Ghiera con prolunga a cono Ø22-38.....	344318
	Collet with cone extension Ø22-38	

Gruppi GAPR per equilibratrici ELS GAPR groups for ELS wheel balancer

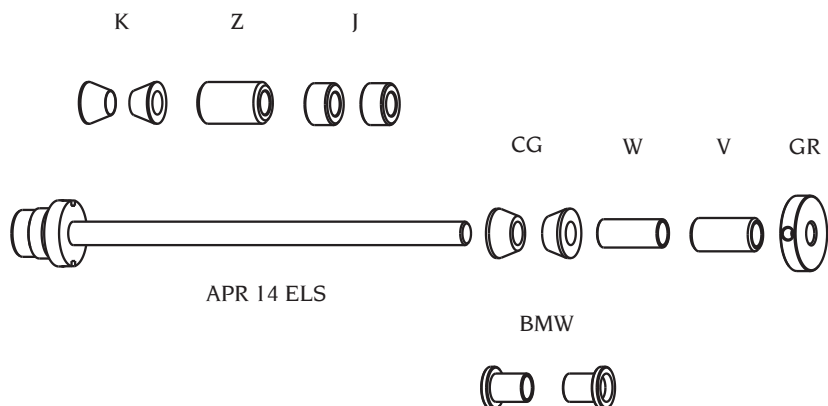

GAPR 14 8-21100125 Gruppo albero Ø14 con boccole Shaft assembly Ø14 with bushes

APR 14 ELS	Albero porta ruota Ø14.....	4-106959
	Wheel holding shaft Ø14	
BMW	Boccole per ruote BMW Ø17.....	319231
	Bushing for BMW wheels Ø17	
GR	Ghiera	344317
	Collet	
K	Cono centraggio ruota Ø14-25mm.....	335970
	Wheel centering cone Ø14-25mm	
W	Boccola Ø17x40.....	316151
	Bushing Ø17x40	
J	Distanziale esterno Ø25x15	316164
	Outer spacer Ø25x15	
CG 25	Cono per ruote BMW Ø14-30	335972
	Cone for BMW wheels Ø14-30	
Z	Boccola Ø25x40.....	316153
	Bushing Ø25x40	
V	Boccola Ø20x40.....	316152
	Bushing Ø20x40	

Gruppi GAPR per equilibratrici ELS GAPR groups for ELS wheel balancer

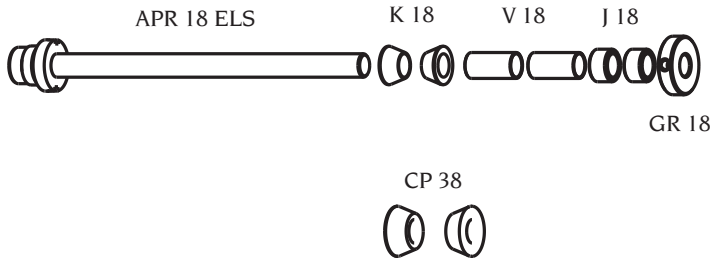

GAPR 18 8-21100126 Gruppo albero Ø18 con boccole Shaft assembly Ø18 with bushes

APR 18 ELS	Albero porta ruota Ø18.....	4-106960
	Wheel holding shaft Ø18	
V 18	Boccola Ø20x40.....	323059
	Bush Ø20x40	
J 18	Distanziale esterno Ø25x15	323058
	Outer spacer Ø25x15	
K 18	Cono centraggio ruota Ø28-38	341292
	Wheel centering cone Ø28-38	
GR 18	Ghiera	344319
	Collet with cone extension Ø22-38	
CP 38	Cono centraggio ruota Ø28-38	363089
	Wheel centering cone Ø28-38	

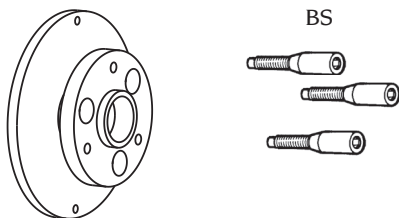

**FA 8-21100098 Flangia per ruote moto APRILIA AF1
APRILIA AF1 adapter**

BS Bullone speciale per fissaggio ruote308748
Special bolt for fixing wheels

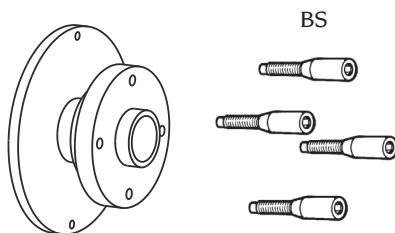

**FH VFR 8-21100099 Flangia per ruote moto HONDA VFR
HONDA VFR adapter**

BS Bullone speciale per fissaggio ruote308748
Special bolt for fixing wheels

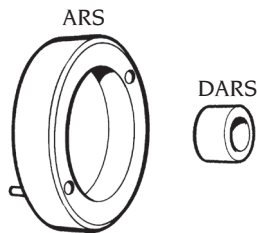

- ARS** **8-21100089** **Distanziale per ruote moto HONDA NTV da usare con FBC (cono piccolo CPI)**
HONDA NTV spacer to be used with FBC (CPI small cone)
- DARS** Distanziale da 30mm 4-105171
 Spacer of 30mm



- DM** **8-21100088** **Distanziale per ruota posteriore DUCATI 916 - 996 - 998 per riduzione diametro flangia appoggio ruota da usare con FBC (cono piccolo CPI)**
Spacer for DUCATI 916 - 996 - 998 to be used with FBC (CPI small cone)

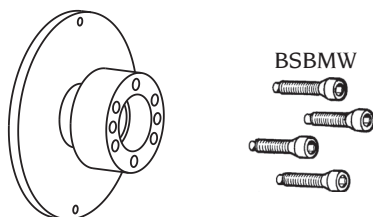

- FBMW** **8-21100097** **Flangia per ruote moto BMW**
Flange for BMW motorcycle wheels
- BSBMW** Bulloni speciali per fissaggio ruote BMW 325213
 Special bolt for BMW fixing wheels

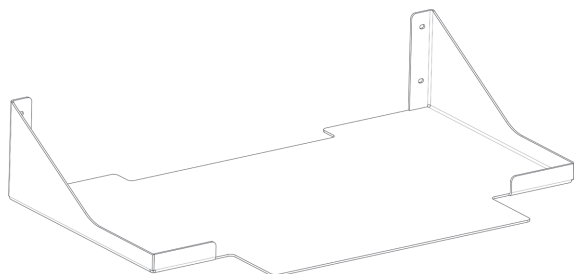

8-21100217/90

Kit supporto stampante per Bluelight
Bluelight printer holding kit

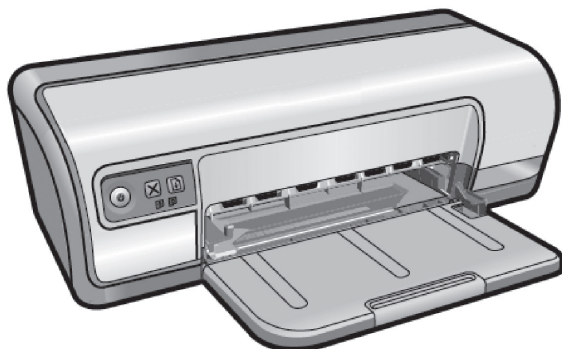

8-61200237

Stampante INKJET per Bluelight
Bluelight inkjet printer



PRT

8-21100121

Stampante per EM7470 - EM7480
EM7470 - EM7480 Printer



- TT-Ø 8-21100230 Sollevatore ruote automatico autobilanciato (EM72X0, EM74X0, EM93X0, EM95X0, EM99X0, Bluelight, Eyclight) Portata max.: 80 kg**
Automatic self-balancing wheel lifter (EM72X0, EM74X0, EM93X0, EM95X0, EM99X0, Bluelight, Eyclight) Max. load: 80 kg

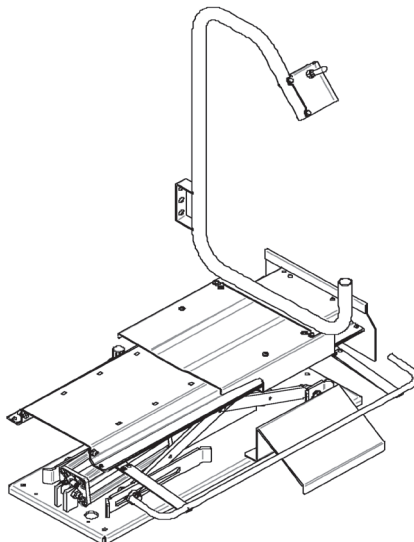

- TT80 8-21100161 TT80: sollevatore ruote auto per equilibratrice (EM84X0, EM85X0, EM83X0, EM74X0, EM72X0) Portata max.: 80 kg**
TT80: car wheel balancer lifter (EM84X0, EM85X0, EM83X0, EM74X0, EM72X0) Max. load: 80 kg
ATTENZIONE: verificare necessità kit montaggio 8-21100163 - 8-21100169.
ATTENTION: verify necessity of mounting kit 8-21100163 - 8-21100169.

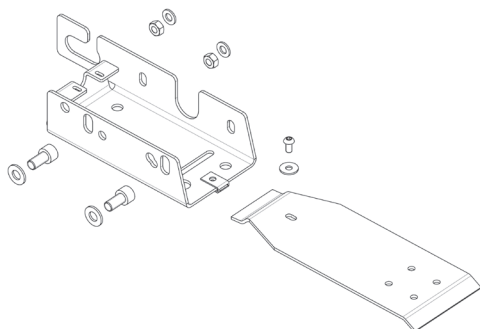

- 8-21100231 Kit montaggio sollevatore TT-Ø (EM72X0, EM74X0, EM93X0, Bluelight)**
 (non necessario per modelli EM95X0, EM99X0, Eyclight)
TT-Ø lifter mounting kit (EM72X0, EM74X0, EM93X0, Bluelight) (Not
 necessary for models EM95X0, EM99X0, Eyclight)

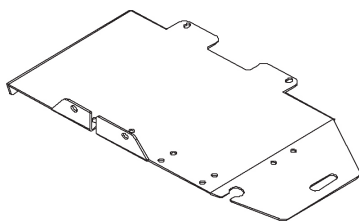

- FTT1 8-21100163 Kit montaggio sollevatore TT80 (EM74X0 - EM72X0) (non necessario**
 per modelli con dispositivo di bloccaggio ruota ELS)
TT80 lifter mounting kit (EM74X0 - EM72X0) (Not necessary for models
 with wheel automatic clamping device ELS)

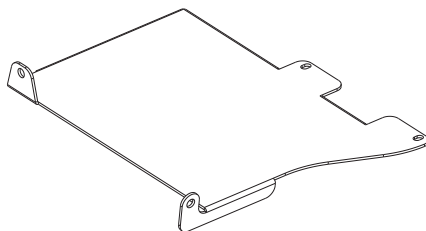

- FTT2 8-21100169 Kit montaggio sollevatore TT80 (EM83X0 - EM85X0) (non necessario**
 per modelli con dispositivo di bloccaggio ruota QL)
TT80 lifter mounting kit (EM83X0 - EM85X0) (Not necessary for models
 with wheel automatic clamping device QL)

AWR

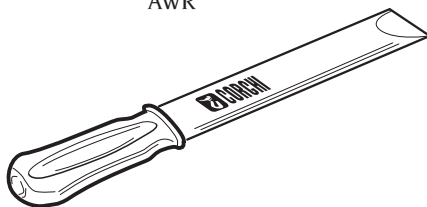

AWR 802461006 Utensile per la rimozione dei pesi adesivi
Adhesive weight remover

PB

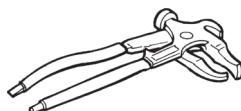

PB Pinza per applicare o togliere contrappesi dai cerchi.....203841
Set of pliers for weight fixing and removing

RAC

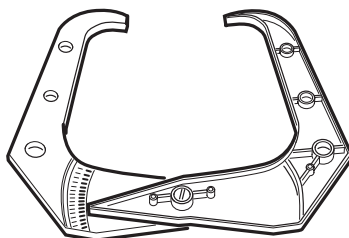

RAC Rilevatore a compasso larghezza cerchi.....223420
Caliper

SLG

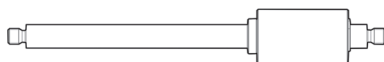

SLG Peso di calibrazione..... 8-21100221
Calibration weight

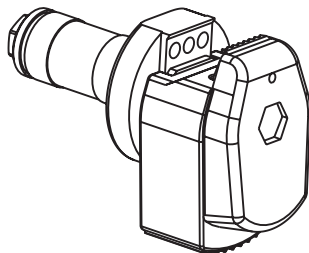

ALUCLIP 8-21100159 Terminale portapesi STD ALU per EM72X0-EM93X0, non di serie su EM72X0-EM93X0
 STD ALU wheight holder for EM72X0-EM93X0, not standard on EM72X0-EM93X0

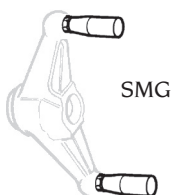

SMG Paio di manovelle girevoli (solo per modelli a lancio manuale)246530
 Pair of hand spin handles (only for hand spin models)

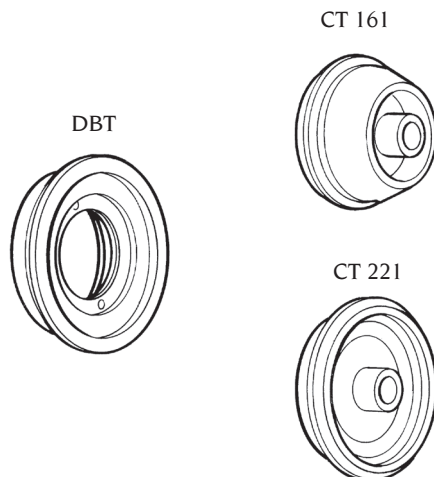

KCT	802245159	Accessorio base di centraggio per ruote camion a foro centrale da Ø159 a 281 Base accessory for truck centre hole wheel centering from Ø159 to 281
DBT		Flangia distanziale bifronte per appoggio cerchi autocarro.....345160 <i>Spacer flange for truck wheels</i>
CT 161		Cono medio bifronte Ø159÷180 / 198÷204 mm345161 <i>Medium cone Ø159÷180 / 198÷204 mm</i>
CT 221		Cono grande bifronte Ø220-281mm.....345162 <i>Large cone Ø220-281mm</i>

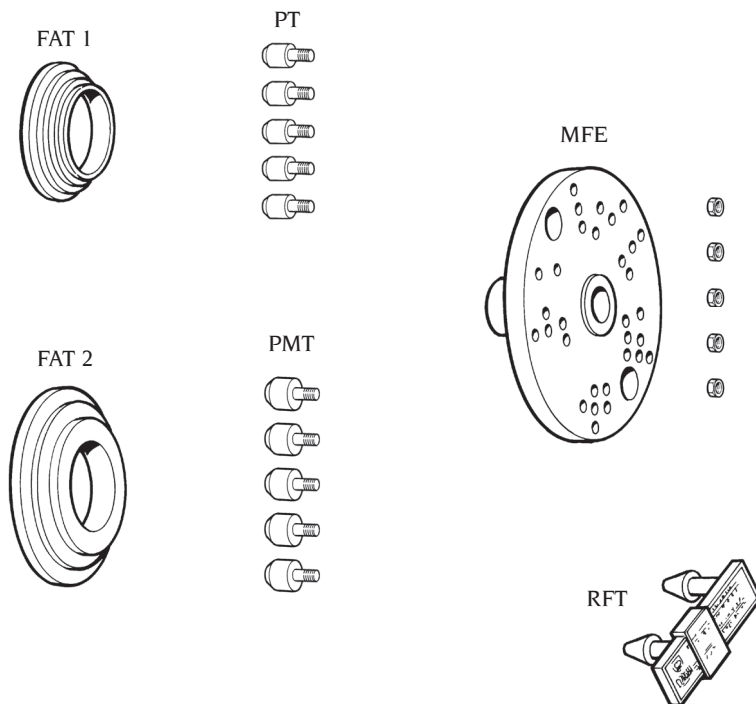

ART	802239637	Accessorio professionale di centraggio per ruote camion a foro centrale da Ø160 a 280 Professional accessory for truck wheel centering from Ø160 to 280
FAT 1	Flangia appoggio per cerchi autocarro con foro Ø160/176/200339635 Adapters for truck wheels Ø160/176/200	
FAT 2	Flangia appoggio per cerchi autocarro con foro Ø220/280339636 Adapters for truck wheels Ø220/280	
PT	Puntale per centraggio ruote autocarro con fori fissaggio Ø18-35339668 Centering push rod for truck wheels holes Ø18-35	
PMT	Puntale MAXI per centraggio ruote autocarro con fori fissaggio Ø28-47mm341818 MAXI centering push rod for truck wheels holes Ø28-47mm	
MFE	Mozzo con flangia239655 Hub with flange	
RFT	Rilevatore fori per misura distanza fori fissaggio ruote autocarro245514 Holes detector	

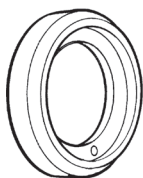

DFT

- DFT 802245527** Distanziale per ruote FORD F350/450 da usare con ARFT (cono bifronte CGT)
Spacer for FORD F350/450 wheels to be used with ARFT (double face cone CGT)

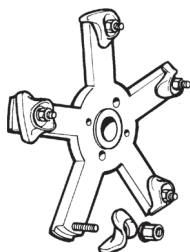

FTE

- FTE 802441616** Flangia TRILEX EUROPA 18°, 20-24"
 TRILEX adapter 20-24" (18° for Europe)
- FTD 802443948** Flangia TRILEX DAYTON 28°, 20-24"
 TRILEX adapter 20-24" (28° for USA)

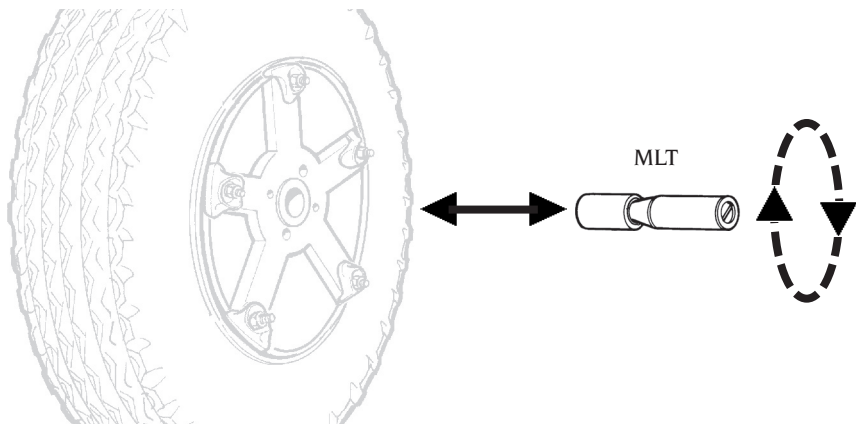

- MLT 802245061** Manovella lancio ruote manuale per flange TRILEX
Hand spin handle for TRILEX adapter

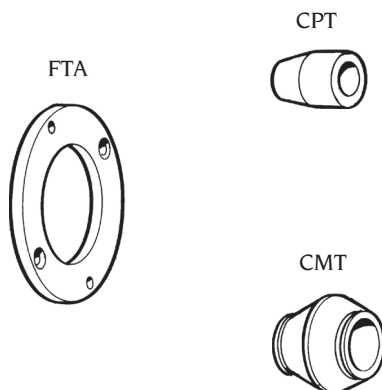

ARU	802247782	Accessorio base di centraggio per ruote auto a foro centrale da Ø47 a 115 <i>Base car accessory for centre hole wheel from Ø47 to 115</i>
FTA		Flangia per riduzione diametro appoggio ruota vettura..... 339673 <i>Diameter reduction flange for car wheels</i>
CPT		Cono piccolo Ø47-64339670 <i>Small cone Ø47-64</i>
CMT		Cono medio bifronte Ø60-115339671 <i>Medium cone Ø60-115</i>

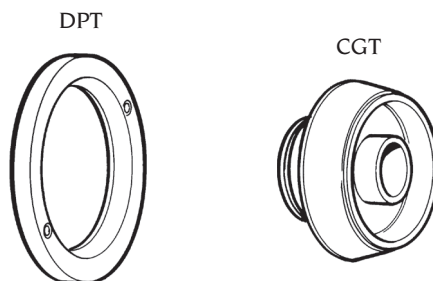

ARFT	802247716	Accessorio di centraggio per ruote fuoristrada e furgoni con foro centrale da Ø110 a 165 <i>Accessory for centre hole 4x4 and light commercial vehicle wheels from Ø110 to 165</i>
DPT		Flangia distanziale per appoggio cerchi furgoni.....341843 <i>Spacer flange for van wheels</i>
CGT		Cono grande bifronte Ø110-165339672 <i>Double face cone Ø110-165</i>

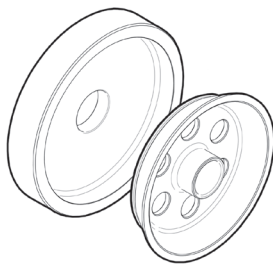

KET 8-21100222 Kit cono + distanziale Ø 190-223 mm per cerchi 17,5" - 19,5" (IVECO-MAN-DAF)
Set of cone and spacer for centre hole wheel from Ø 190 to 223 mm for rims 17.5" - 19.5" (IVECO - MAN - DAF)

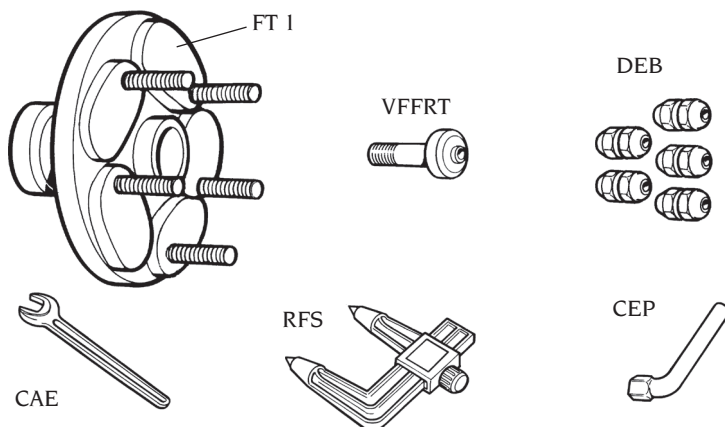

**FRT 802241153 Flangia autocentrante UNIVERSALE per ruote con o senza foro centrale
Ø foratura min.90 max.210
UNIVERSAL selfcentering flange for open and close centre wheels, PLD
min.90 max.210**

FT 1	Biella con perno	2401415
	Connecting rod with pin	
VFFRT	Vite fissaggio flangia	240381
	Adapter fixing screw	
DEB	Dado BIFRONT (conico o sferico) per fissaggio ruote.....	321878
	Conical/spheric nut for wheel fixing	
CAE	Chiave aperta esagonale per serraggio dadi bloccaggio bielle	440384
	Hexagonal open wrench	
RFS	Rilevatore fori per misura distanza fori fissaggio ruota.....	441286
	Caliper	
CEP	Chiave esagonale a pipa (ch22) per serraggio DEB.....	426517
	Hexagonal key (22mm)	

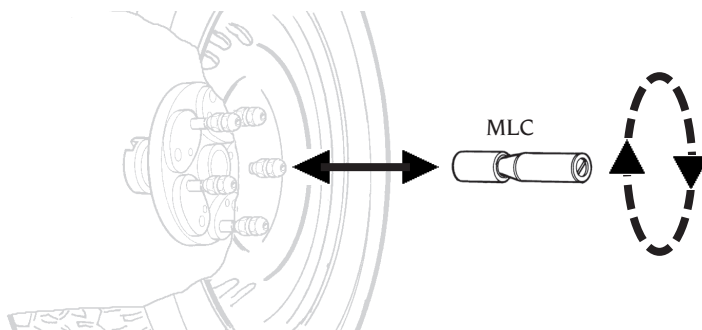

**MLC 802244344 Manovella lancio manuale per flangia FRT
Hand spin handle for FRT adapter**

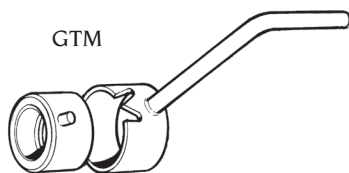

- GTM** **802245933** **Ghiera base di bloccaggio per auto e camion Ø46mm - Lancio manuale**
Ring nut for truck/car wheels (Manual spin)

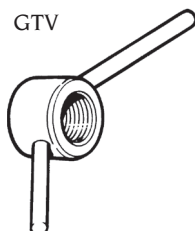

- GTV** **802239121** **Ghiera base di bloccaggio per auto e camion Ø46mm**
Ring nut for truck/car wheels Ø46

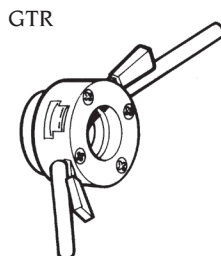

- GTR** **802443938** **Ghiera rapida di bloccaggio per auto e camion Ø46mm**
Quick release ring nut for truck/car wheels Ø46

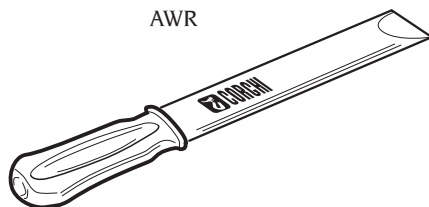

- AWR** **802461006** **UTENSILE PER LA RIMOZIONE DEI PESI ADESIVI**
ADHESIVA WEIGHT REMOVER

PB

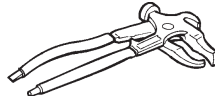

PB

Pinza per applicare o togliere contrappesi dai cerchi.....203841

Set of pliers for weight fixing and removing

RACT

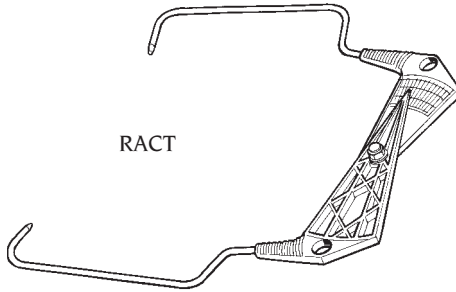

RACT

Rilevatore a compasso larghezza cerchi - Autocarri.....239556

Truck wheels caliper

MFT



MFT

Mozzo filettato - Autocarri L.150.....238304

Threaded hub for truck wheels

ROT

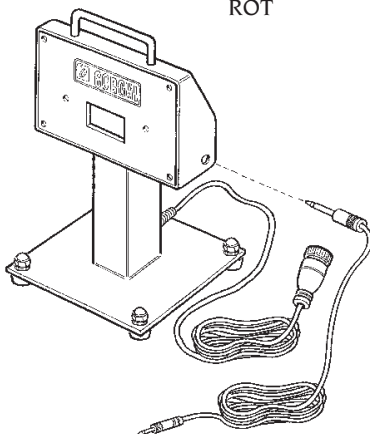

- ROT 802228099** Ripetitore ottico per equilibratura contemporanea delle due ruote motrici
Optical relay unit for simultaneous balancing of two driving wheels

AWR

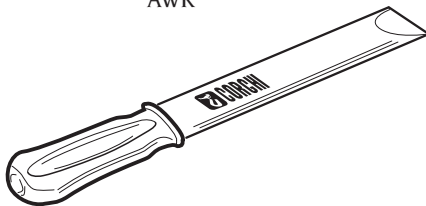

- AWR 802461006** Utensile per la rimozione dei pesi adesivi
Adhesive weight remover

PB

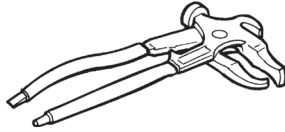

PB Pinza per applicare o togliere contrappesi dai cerchi.....203841
Set of pliers for weight fixing and removing

RNR



RNR Rotolo nastro riflettente.....433119
Refletting band

PPT



PPT 8-21100225 Pinza premi talloni
Bead Pressing Clamps

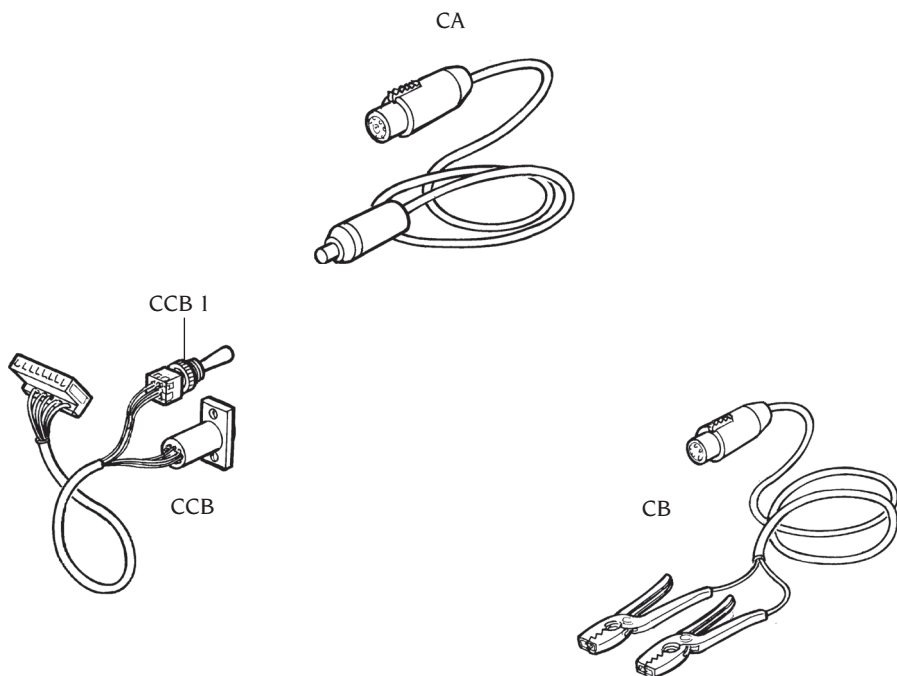

AL12	802244796	Kit alimentazione 12V per EM43 e ET66 12V power kit for EM43 and ET66	
CCB		Cavo collegamento scheda principale - connettore esterno.....	243803
		<i>Connection cable main board/connector</i>	
CCB I		Cappuccio a tenuta stagna.....	437517
		<i>Cap</i>	
CA		Cavo collegamento accendisigari.....	243804
		<i>Electric lighter cable</i>	
CB		Cavo collegamento batteria 12V	243805
		<i>12V power kit cable</i>	

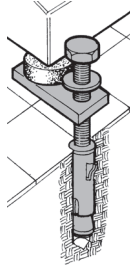

KFT 802251561 Kit fissaggio a terra per EM43 - EM6040 - EM70X0 - EM73X0
Fixing kit to the floor for EM43 - EM6040 - EM70X0 - EM73X0

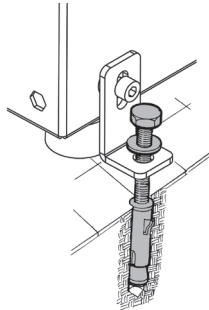

KFT 8-21100102 Kit fissaggio a terra per EM74X0
Fixing kit to the floor for EM74X0

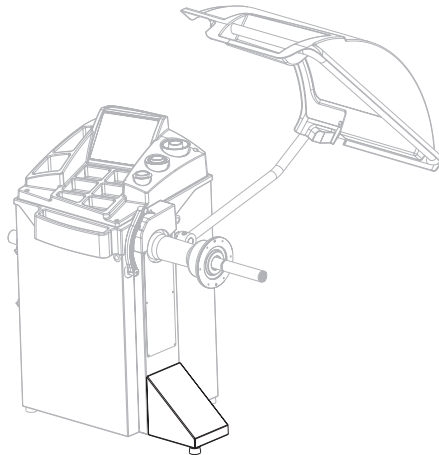

SIDEFT 8-21100158/16 Piede appoggio laterale per EM72X0
Side support foot for EM72X0

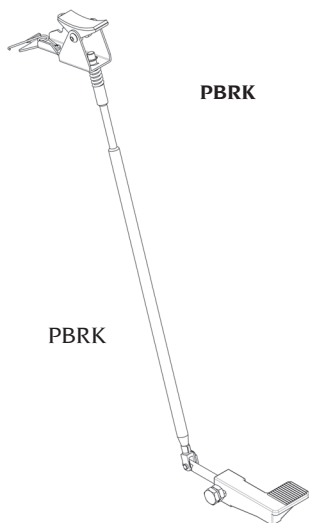

PBRK

Freno di stazionamento a pedale per EM 7240..... 8-21100191
Foot-operated wheel brake for EM 7240

PBRK

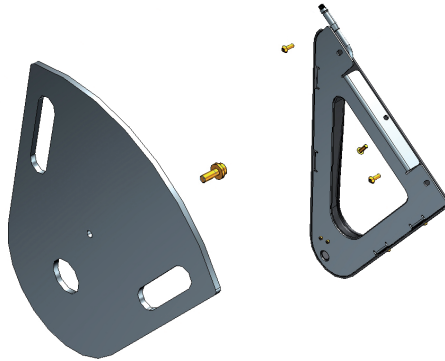

8-21100232 Rilevatore esterno senza contatto (EM9550 - EM 9580)
Touchless external sensor (EM9550 - EM 9580)

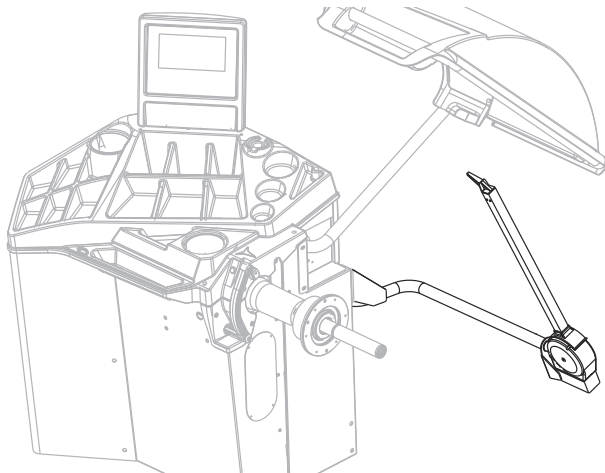

EG1 8-21100074 Rilevatore esterno + supporto (EM74X0 - EM73X0 - EM7280)
External gauge + support (EM74X0 - EM73X0 - EM7280)

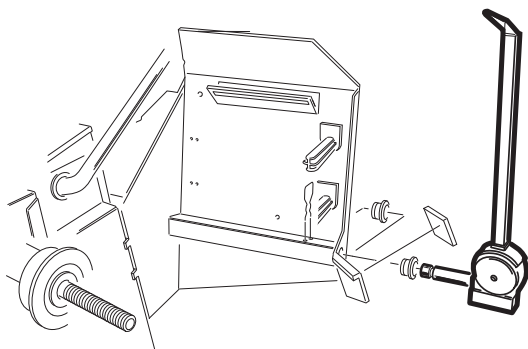

- EG2** **8-21100120** **Rilevatore esterno senza supporto (EM74X0) (da abbinare al cod. 8-21100176)**
External gauge without support (EM74X0) (to be combined with 8-21100176)

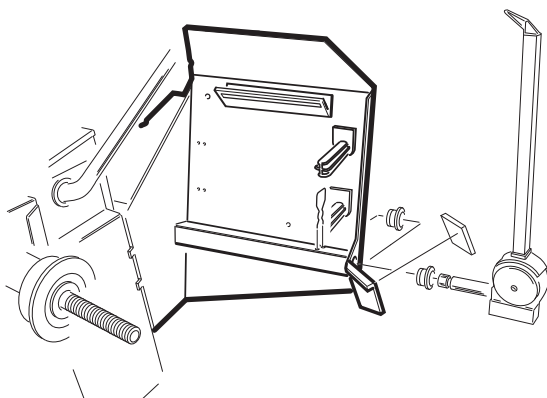

- KPB** **8-21100176** **Kit portaboccole, paraspruzzi e portarilevatore (EM74X0)**
Bushing support, external gauge support, sprays barrier kit (EM74X0)

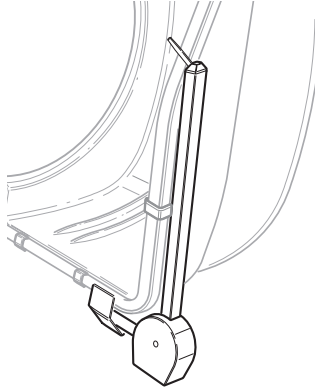

EG 802253426 **Rilevatore esterno + supporto (EM70X0)**
External gauge + support (EM70X0)

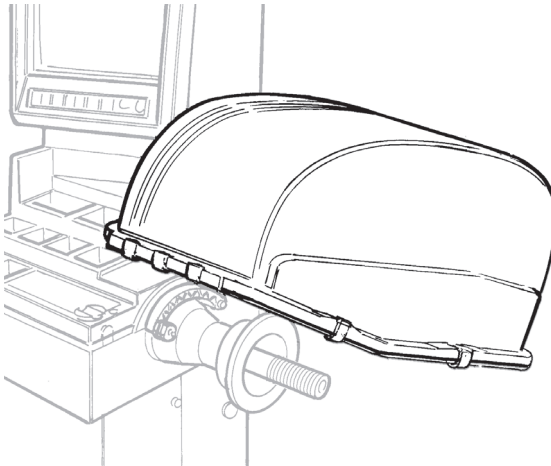

PR43 802243806 **Protezione ruota per EM43**
Wheel guard EM43

PRT 802260829 **Protezione ruota per ET77 - ET88**
Wheel guard ET77 - ET88



WM **8-21100142** **Programma risparmio peso (EM7280 - EM9380 - EM9580)**
Weight saving program (EM7280 - EM9380 - EM9580)

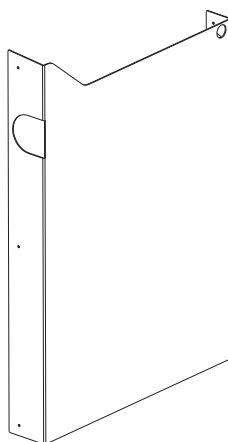

8-21100170/00 **Kit personalizzazione colore EM72X0**
Colour customization kit for EM72X0



CORGHI S.p.A. - Strada Statale 468 n.9
42015 CORREGGIO - R.E. - ITALY
Tel. ++39 0522 639.111 - Fax ++39 0522 639.150
www.corgchi.com - info@corgchi.com

COMIM - Cod. 4-104667k del 09/2013