

Installation and adjustment instructions for AM-50/500 pistol stop screw

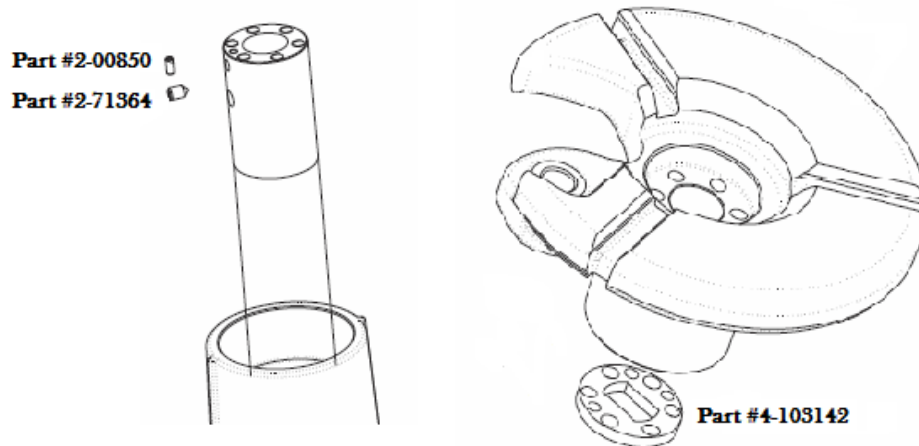

1. Remove the Turn Table, Lock Plate (4-103412), Stop Lock Screw (2-00850), and the Pistol Stop Screw (2-71364).
2. Insert the new Pistol Stop Screw until the point is inside the center of the transmission shaft. Insert the Stop Lock Screw, but do not tighten.



3. Place the Lock Plate on top of the transmission so that the Lock Screw is in one of the smaller holes. Insert two of the Turn Table bolts to hold the lock plate in place. In order to operate correctly, the flat surface of the Stop Screw must be parallel with one of the flats in the center of the Lock Plate as shown.



4. To adjust the stop screw, place the pistol shaft through the lock plate. When the pistol shaft is rotated clockwise it must rotate a full 90 degrees. If it does not, you have the plate installed incorrectly. When the pistol is rotated counterclockwise and engages the Stop Screw it should pull straight out. Screw the Stop screw in or out until you are able to insert and remove the pistol smoothly.



5. Once you have achieved smooth operation. Tighten the Stop Lock Screw. Remove the two turn table bolts and install the turn table. Double check correct operation of the pistol.